

Highland Park Legal Description

A TRACT OF LAND THAT IS A PART OF THE NORTHWEST QUARTER (NW/4) OF THE SOUTHEAST QUARTER (SE/4), OF SECTION FIFTEEN (15), TOWNSHIP EIGHTEEN (18) NORTH, RANGE FIFTEEN (15) EAST OF THE INDIAN BASE AND MERIDIAN, CITY OF BROKEN ARROW, WAGONER COUNTY, STATE OF OKLAHOMA, ACCORDING TO THE UNITED STATES GOVERNMENT SURVEY THEREOF, SAID TRACT OF LAND BEING DESCRIBED AS FOLLOWS:

COMMENCING AT THE SOUTHWEST CORNER OF THE SOUTHEAST QUARTER (SE/4) OF SAID SECTION FIFTEEN (15); THENCE NORTH 01°10'08" WEST ALONG THE WEST LINE OF SAID SOUTHEAST QUARTER (SE/4), A DISTANCE OF 1317.89 FEET TO THE POINT OF BEGINNING; THENCE CONTINUING NORTH 01°10'08" WEST ALONG THE WEST LINE OF SAID SOUTHEAST QUARTER (SE/4), A DISTANCE OF 1319.83 FEET TO THE NORTHWEST CORNER OF SAID SOUTHEAST QUARTER (SE/4); THENCE NORTH 88°50'25" EAST, A DISTANCE OF 855.58 FEET ALONG THE NORTH LINE OF SAID SOUTHEAST QUARTER (SE/4); THENCE SOUTH 01°47'36" EAST, A DISTANCE OF 249.38 FEET; THENCE NORTH 52°59'06" WEST, A DISTANCE OF 217.36 FEET; THENCE SOUTH 57°05'51" WEST, A DISTANCE OF 70.82 FEET; THENCE ALONG A CURVE TO THE LEFT HAVING A RADIUS OF 50.00 FEET, AN ARC DISTANCE OF 75.53 FEET, A CHORD DISTANCE OF 68.55 FEET, AND CHORD BEARING OF SOUTH 32°17'53" WEST; THENCE SOUTH 40°57'06" EAST, A DISTANCE OF 156.34 FEET; THENCE SOUTH 03°44'08" WEST, A DISTANCE OF 85.62 FEET; THENCE SOUTH 22°47'18" WEST, A DISTANCE OF 56.26 FEET; THENCE SOUTH 55°28'26" WEST, A DISTANCE OF 207.64 FEET; THENCE SOUTH 88°47'35" WEST, A DISTANCE OF 195.14 FEET; THENCE SOUTH 01°12'25" EAST, A DISTANCE OF 120.00 FEET; THENCE SOUTH 88°47'35" WEST, A DISTANCE OF 120.00 FEET; THENCE SOUTH 01°12'25" EAST, A DISTANCE OF 193.56 FEET; THENCE ALONG A CURVE TO THE LEFT HAVING A RADIUS OF 275.00 FEET, AN ARC DISTANCE OF 36.45 FEET, A CHORD DISTANCE OF 36.42 FEET, AND A CHORD BEARING OF SOUTH 05°00'15" EAST; THENCE SOUTH 08°48'06" EAST, A DISTANCE OF 59.92 FEET; THENCE ALONG A CURVE TO THE RIGHT HAVING A RADIUS OF 280.00 FEET, AN ARC DISTANCE OF 72.68 FEET, A CHORD DISTANCE OF 72.47 FEET, AND A CHORD BEARING OF SOUTH 01°21'57" EAST; THENCE NORTH 88°47'35" EAST, A DISTANCE OF 135.15 FEET; THENCE SOUTH 01°10'12" EAST, A DISTANCE OF 257.78 FEET; THENCE SOUTH 88°47'50" WEST, A DISTANCE OF 316.19 FEET TO THE POINT OF BEGINNING.

THE ABOVE DESCRIBED TRACT OF LAND CONTAINING 583,764.8865 SQUARE FEET OR 13.4014 ACRES, MORE OR LESS.

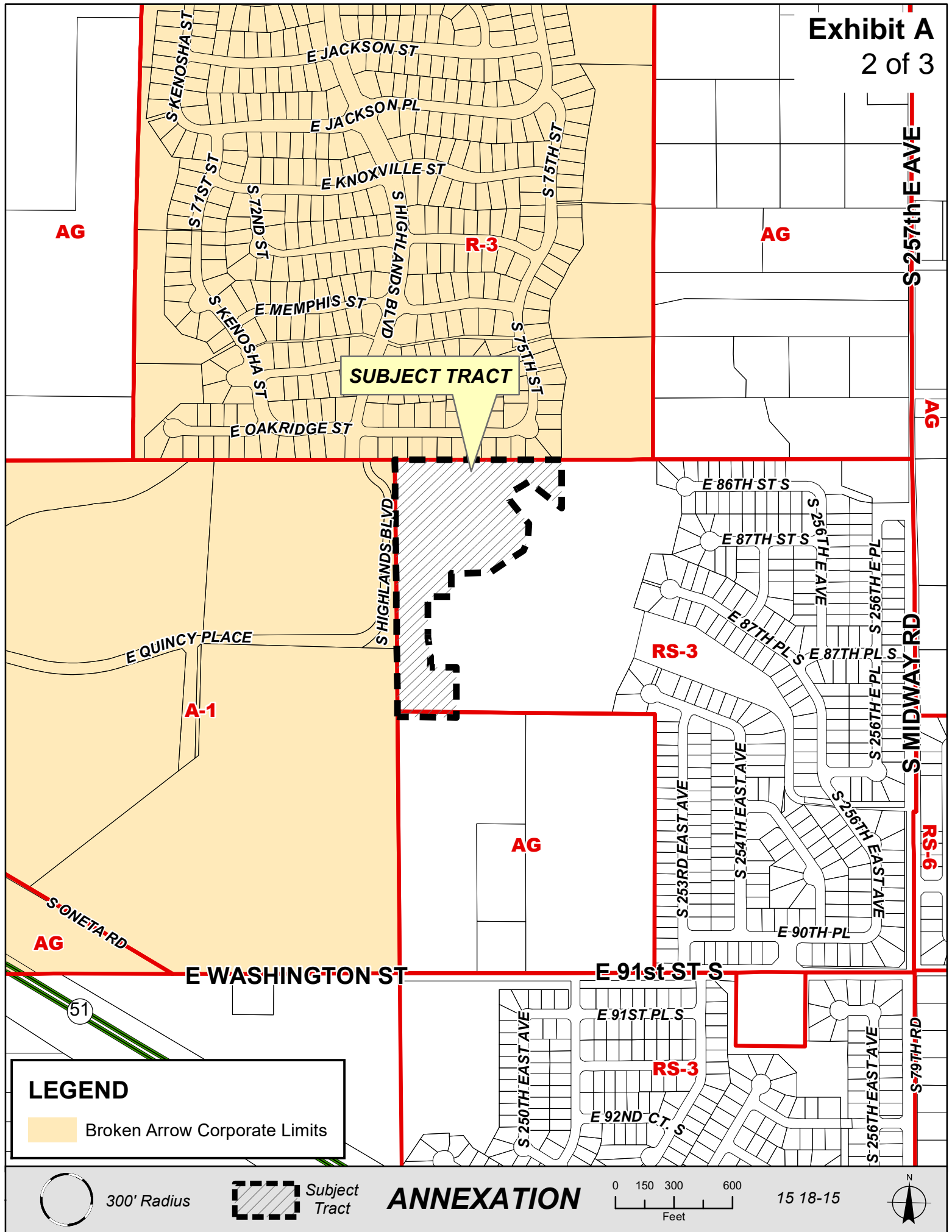



Note: Graphic overlays may not precisely align with physical features on the ground.
Aerial Photo Date February 2018

Subject
Tract

ANNEXATION

A horizontal number line with tick marks at 0, 150, 300, 450, and 600. The word "Feet" is written below the line.

15 18-15

