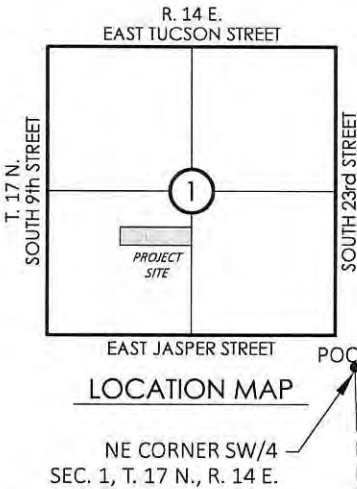
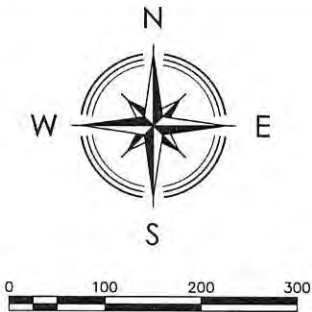

EXHIBIT "A"
TEMPORARY CONSTRUCTION EASEMENT

OWNER:
Margaret E. Crawford
PROPERTY ID:
97401-74-01-35310
PROPERTY ADDRESS:
12944 S. 185th E. AVE.

STATEMENT OF BEARINGS:
Basis of Bearings: Oklahoma State Plane Coordinate System,
North Zone, 3501, NAD 83 (1993)

LEGEND
POB POINT OF BEGINNING
POC POINT OF COMMENCEMENT
Temporary Consturction Easement
2,038.21 s.f. or 0.05 acres, more or less



A tract of land located in the Northeast Quarter of the Southwest Quarter (NE/4 SW/4) of Section One (1), Township Seventeen (17) North, Range Fourteen (14) East of the Indian Base and Meridian, Tulsa County, State of Oklahoma, according the United States Government Survey thereof, being more particularly described as follows:

COMMENCING at the Northeast corner of said SW/4; Thence South 01°28'08" East and along the East line of said SW/4, for a distance of 992.70 feet; Thence South 88°46'21" West, for a distance of 1249.05 feet to the POINT OF BEGINNING; Thence South 47°21'33" West, for a distance of 90.44 feet; Thence North 01°31'36" West, for a distance of 59.83 feet; Thence North 88°46'21" East, for a distance of 68.14 feet to the POINT OF BEGINNING.

LINE	BEARING	DISTANCE
L1	S 01°28'08" E	992.70'
L2	S 88°46'21" W	1249.05'
L3	S 47°21'33" W	90.44'
L4	N 01°31'36" W	59.83'
L5	N 88°46'21" E	68.14'

30' SEWER LINE EASEMENT
BOOK 4812, PAGE 861

L1

East Line of the SW/4,
Sec. 1, T. 17 N., R. 14 E.

L2

POB

L4
L3

Nathaniel J. Reed
Oklahoma P.L.S. #1744
Date



HARDEN & ASSOCIATES
SURVEYING AND MAPPING, PC
5807 South Garnett Road, Suite K, (918) 234-4859 Office
Tulsa, Oklahoma 74146 (918) 437-5551 Fax
Certificate of Authorization No. 4656 Expires June 30, 2019

PARCEL: TEMP CONSTR. ESMT.	PROJECT No.: 161027
DRAWING: PARCEL 2A.1	DATE: MAY 2018
REVISION: OCTOBER 2018	DRAWN: JLN
	SCALE: 1:200'
	CHECKED: NJR
	SHEET NO.: 1 OF 1