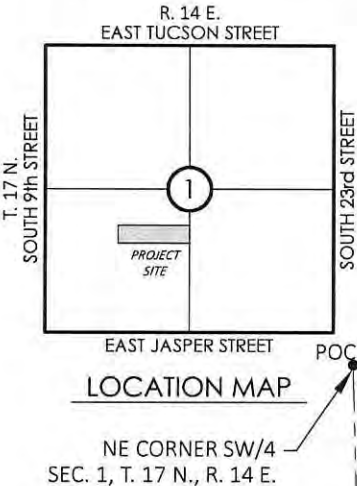
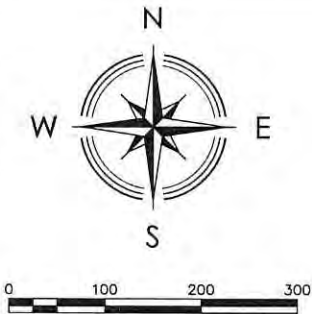

EXHIBIT "A"
TEMPORARY CONSTRUCTION EASEMENT

OWNER:
Margaret E. Crawford
PROPERTY ID:
97401-74-01-34610
PROPERTY ADDRESS:
BEHIND 12720 S. 185th E. AVE.

STATEMENT OF BEARINGS:
Basis of Bearings: Oklahoma State Plane Coordinate System,
North Zone, 3501, NAD 83 (1993)

LEGEND
POB POINT OF BEGINNING
POC POINT OF COMMENCEMENT
Temporary Consturction Easement
17,811.64 s.f. or 0.41 acres, more or less



A tract of land located in the Northeast Quarter of the Southwest Quarter (NE/4 SW/4) of Section One (1), Township Seventeen (17) North, Range Fourteen (14) East of the Indian Base and Meridian, Tulsa County, State of Oklahoma, according to the United States Government Survey thereof, being more particularly described as follows:

COMMENCING at the Northeast corner of said SW/4; Thence South 01°28'08" East and along the East line of said SW/4, for a distance of 661.80 feet; Thence South 88°47'30" West, for a distance of 970.14 feet to the POINT OF BEGINNING; Thence South 04°48'51" West, for a distance of 39.31 feet; Thence South 40°07'41" West, for a distance of 303.88 feet; Thence South 47°21'33" West, for a distance of 96.80 feet; Thence South 88°46'21" West, for a distance of 60.47 feet; Thence North 47°21'33" East, for a distance of 139.62 feet; Thence North 40°07'41" East, for a distance of 288.62 feet; Thence North 04°48'51" East, for a distance of 22.35 feet; Thence North 88°47'30" East, for a distance of 40.22 feet to the POINT OF BEGINNING.

LINE	BEARING	DISTANCE
L1	S 01°28'08" E	661.80'
L2	S 88°47'30" W	970.14'
L3	S 04°48'51" W	39.31'
L4	S 40°07'41" W	303.88'
L5	S 47°21'33" W	96.80'
L6	S 88°46'21" W	60.47'
L7	N 47°21'33" E	139.62'
L8	N 40°07'41" E	288.62'
L9	N 04°48'51" E	22.35'
L10	N 88°47'30" E	40.22'

30' SEWER LINE EASEMENT
BOOK 4812, PAGE 861

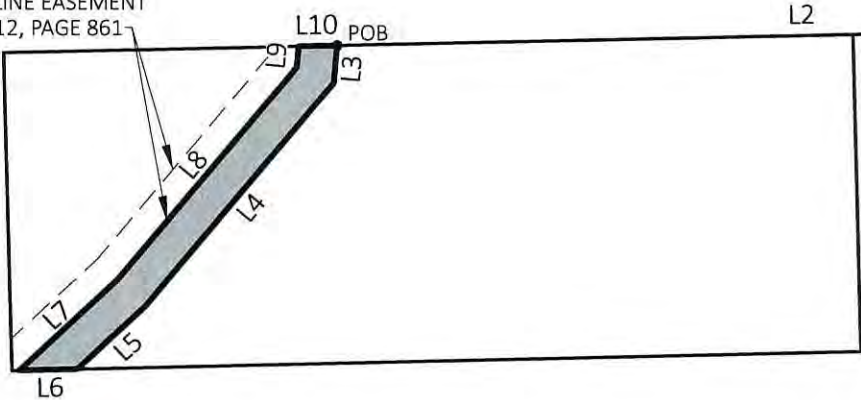

East Line of the SW/4,
Sec. 1, T. 17 N., R. 14 E.

Nathaniel J. Reed
Oklahoma P.L.S. #1744
Date 6-1-18



HARDEN & ASSOCIATES
SURVEYING AND MAPPING, PC
5807 South Garnett Road, Suite K, (918) 234-4859 Office
Tulsa, Oklahoma 74146 (918) 437-5551 Fax
Certificate of Authorization No. 4656 Expires June 30, 2019

PARCEL: TEMP CONSTR. ESMT.

DRAWING: PARCEL 2.2

REVISION: JUNE 2018

PROJECT No.: 161027

DATE: MAY 2018

DRAWN: JLN

SCALE: 1:200'

CHECKED: NJR

SHEET NO.: 1 OF 1