



EXHIBIT "A"

OWNER:

Johnny Lee & Betty Jo Henry Trustess

PROPERTY ID:

97401-74-01-29310

PROPERTY ADDRESS:

12426 S. 185th E. AVE.

STATEMENT OF BEARINGS:

Basis of Bearings: Oklahoma State Plane Coordinate System,  
North Zone, 3501, NAD 83 (1993)

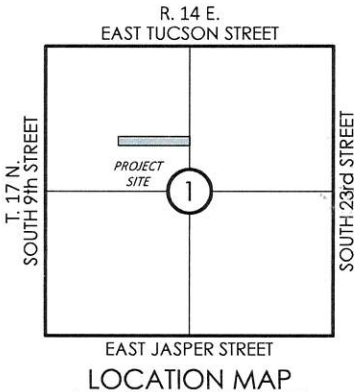
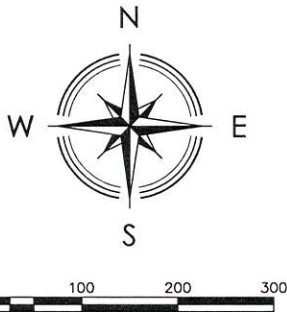

LEGEND

POB POINT OF BEGINNING

POC POINT OF COMMENCEMENT

Temporary Construction Easement  
6,644.38 s.f. or 0.15 acres, more or less

LINE	BEARING	DISTANCE
L1	N 01°31'08" W	831.24'
L2	S 88°47'28" W	1119.59'
L3	S 88°47'28" W	40.00'
L4	N 00°20'40" W	166.11'
L5	N 88°47'01" E	40.00'
L6	S 00°20'40" E	166.11'

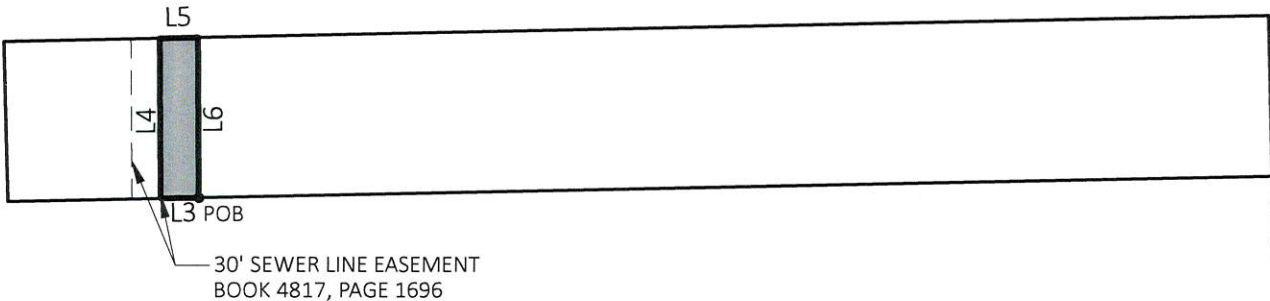

A tract of land located in the Southeast Quarter of the Northwest Quarter (SE/4 NW/4) of Section One (1), Township Seventeen (17) North, Range Fourteen (14) East of the Indian Base and Meridian, Tulsa County, State of Oklahoma, according the United States Government Survey thereof, being more particularly described as follows:

COMMENCING at the Southeast corner of said NW/4; Thence North 01°31'08" West and along the East line of said NW/4, for a distance of 831.24 feet; Thence South 88°47'28" West, for a distance of 1119.59 feet to the POINT OF BEGINNING; Thence continuing South 88°47'28" West, for a distance of 40.00 feet; Thence North 00°20'40" West, for a distance of 166.11 feet; Thence North 88°47'01" East, for a distance of 40.00 feet; Thence South 00°20'40" East, for a distance of 166.11 feet to the POINT OF BEGINNING.

East Line of the NW/4,  
Sec. 1, T. 17 N., R. 14 E.

L1

SE CORNER NW/4  
SEC. 1, T. 17 N., R. 14 E.

POC

Nathaniel J. Reed  
Oklahoma P.L.S. #1744  
Date



**HARDEN & ASSOCIATES**  
SURVEYING AND MAPPING, PC  
5807 South Garnett Road, Suite K, (918) 234-4859 Office  
Tulsa, Oklahoma 74146 (918) 893-5552 Fax  
Certificate of Authorization No. 4656 Expires June 30, 2019

PARCEL: TEMP CONSTR. ESMT.	PROJECT No.: 161027
DRAWING: PARCEL 6.2	DATE: MAY 2018
REVISION:	DRAWN: JLN
	SCALE: 1:200'
	CHECKED: NJR
	SHEET NO.: 1 OF 1