

CONDITIONS FOR DONATION

Conditions: (List physical conditions required for acceptance):

1. Replace fence with like or better: Current fence has two each 12-foot-wide double gate (24 foot opening), one west side (215+50), one east side (222+35) of drive way. The Gate support post are double 7-inch wood support post with cross brace for each gate hinge and at the end of each fence run for a total of eight double support ends (total 16 post). Replace with new or equivalent fence end supports. Install new or equivalent gates or reuse the existing gates.
2. Place a minimum of 4' chain link fence around the culvert trio (STR RCP2 214+00) and tie to the existing fencing for safety.
3. Place temporary fencing when existing fence is removed during construction.
4. Main Driveway entrance replacement: 50' curb cut as it is presently, driveway concrete thickness minimum 6 inch, 8" compacted gravel base under driveway with no mountable curb or curb bump to allow street runoff flows to pond. Must support loaded trash truck.
5. Replace the other two driveways, as they exist presently. The driveway in alignment with the pond will not have a hump in it.

Signature/Date:

Owner/s: Robert Miller Trustee Date: 10-2-2018
Quendalyn L. McCallough Trustee 10-2-2018

Agent: Karen L. Pax  Date: 10/17/18

Project: Washington Street Improvements Parcel 17A & 18

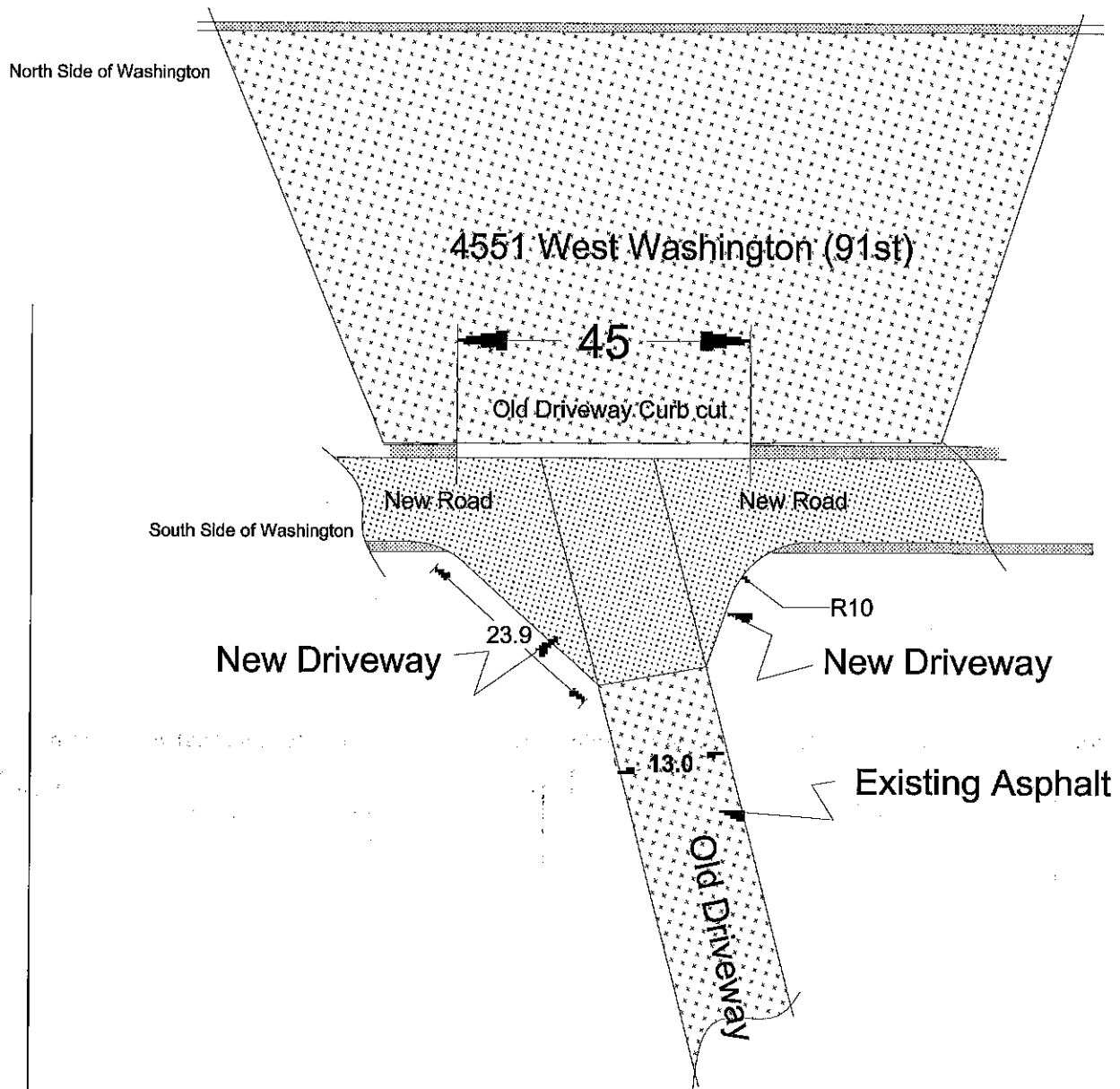

1) Please make new curb cut at least 45 ft

The existing curb cut is not nicely finished but does allow a vehicle with RV to turn out without damage.

Contact Bob McCullough with questions

Cell 918 289 8496

All dimensions in feet unless stated otherwise

Block 213

4501 West Washington

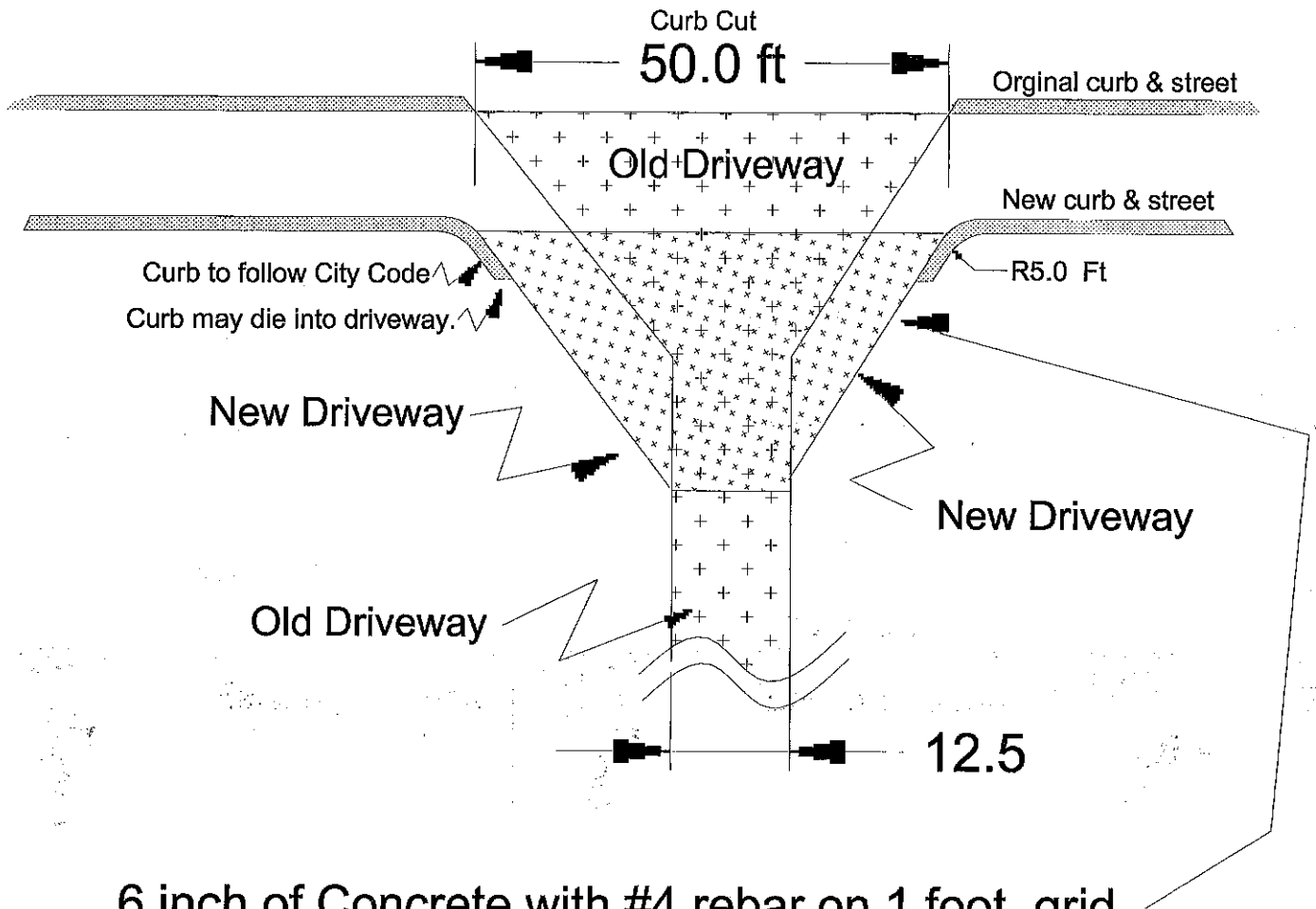

6 inch of Concrete with #4 rebar on 1 foot grid

Compact 8" gravel base

Must Support Loaded Trash Truck

No Curb bump since any street runoff flows to pond

Contact Bob McCullough with questions Cell 918 289 849