

SILVERLEAF

A SUBDIVISION OF THE PART OF THE SOUTHEAST QUARTER (SE/4) OF SECTION THIRTY (30), TOWNSHIP NINETEEN (19) NORTH, RANGE FIFTEEN (15) EAST. CITY OF BROKEN ARROW, WAGONER COUNTY, STATE OF OKLAHOMA

P.U.D. NO. 225

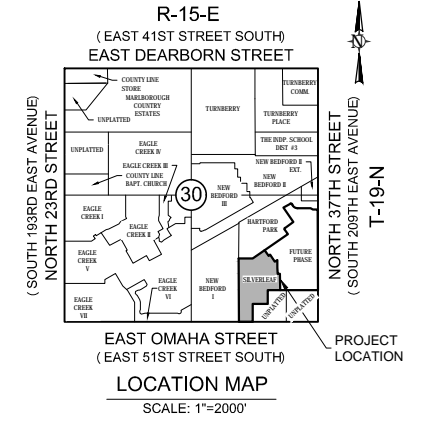

PLOT DATE: Wed, 11 Jan 2017 11:11:11 AM PST FILE: P:\101030\SILVERLEAF\WAGASB OVERALL EXHIBIT