

K:\17747.01\ACCESS-EXHIBIT.dwg SHEET 1-IMAGE Dec 02, 2016 - 9:28:51am SISEMORE WEISZ & ASSOCIATES, INC., 2016

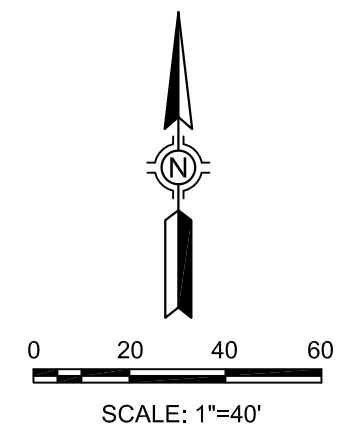
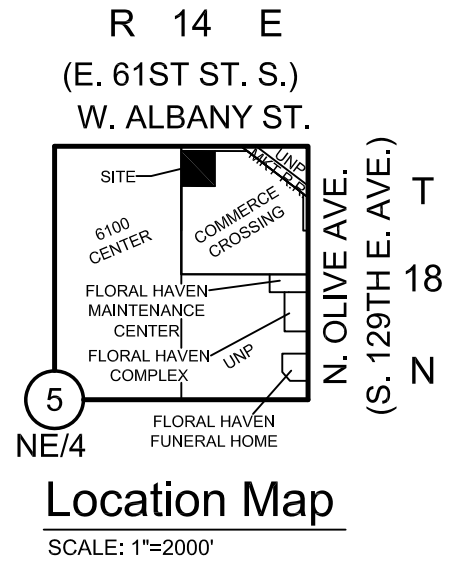
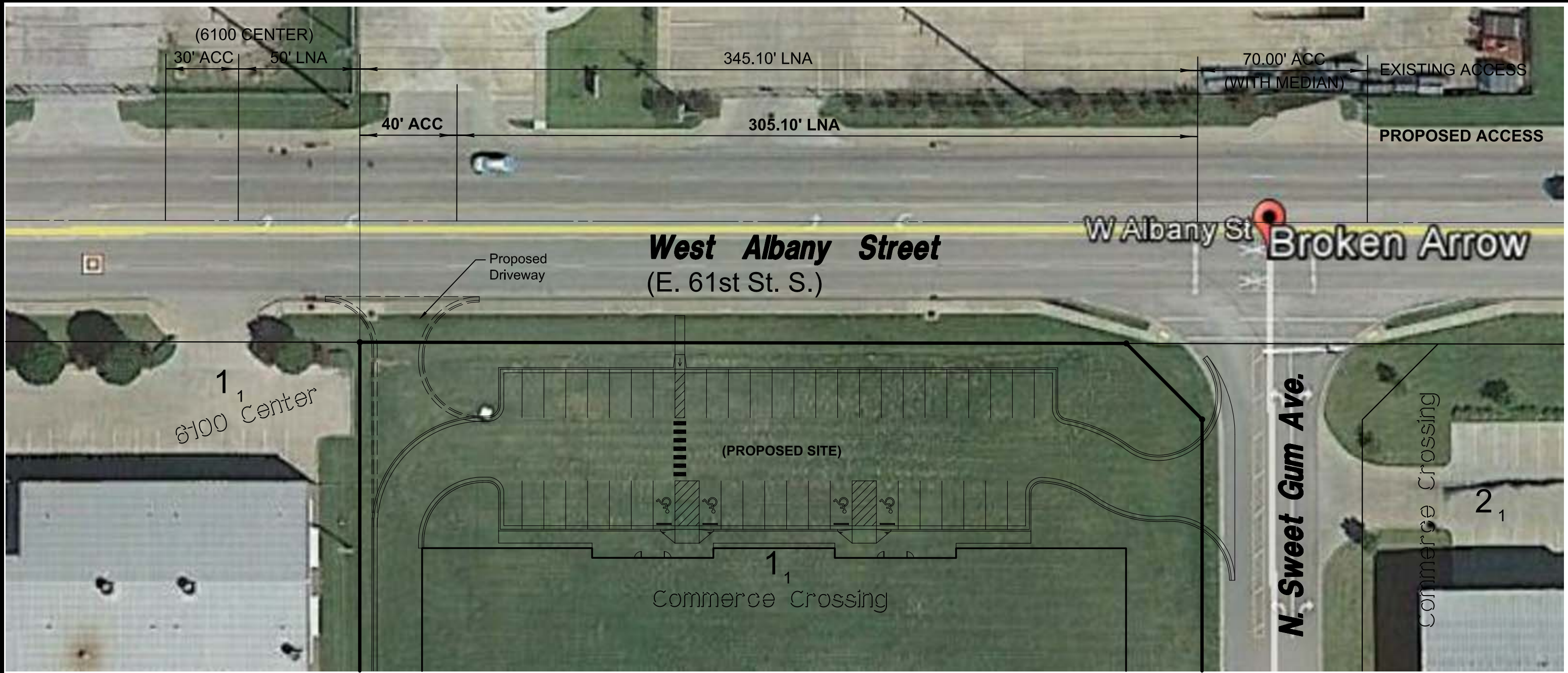

**Legend**  
 ACC = LIMITS OF ACCESS  
 LNA = LIMITS OF NO ACCESS

**Change of Access Exhibit with Aerial  
 of  
 Lot 1, Block 1  
 Commerce Crossing  
 City of Broken Arrow, Tulsa County, State of Oklahoma**

			<b>Sisemore Weisz &amp; Associates, Inc.</b> 6111 EAST 32nd PLACE TULSA, OKLAHOMA 74135 C.A. NO. 2421			PHONE: (918) 665-3600 FAX: (918) 665-8668 EXP. DATE 6/30/17		
REVISIONS	BY	DATE	FILE:	1814.05	SURVEY BY:	DATE:	12/2/16	
			ORDER:	17747.01	DRAWN BY:	LAD	SCALE:	1"=40'
			BOOK:		CHECKED BY:	JTB	SHEET	2 OF 2

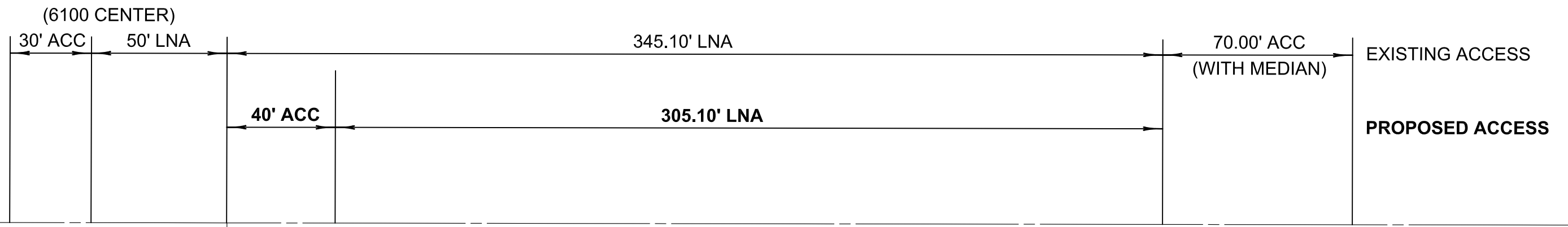

**West Albany Street**  
(E. 61st St. S.)

6100 Center  
1

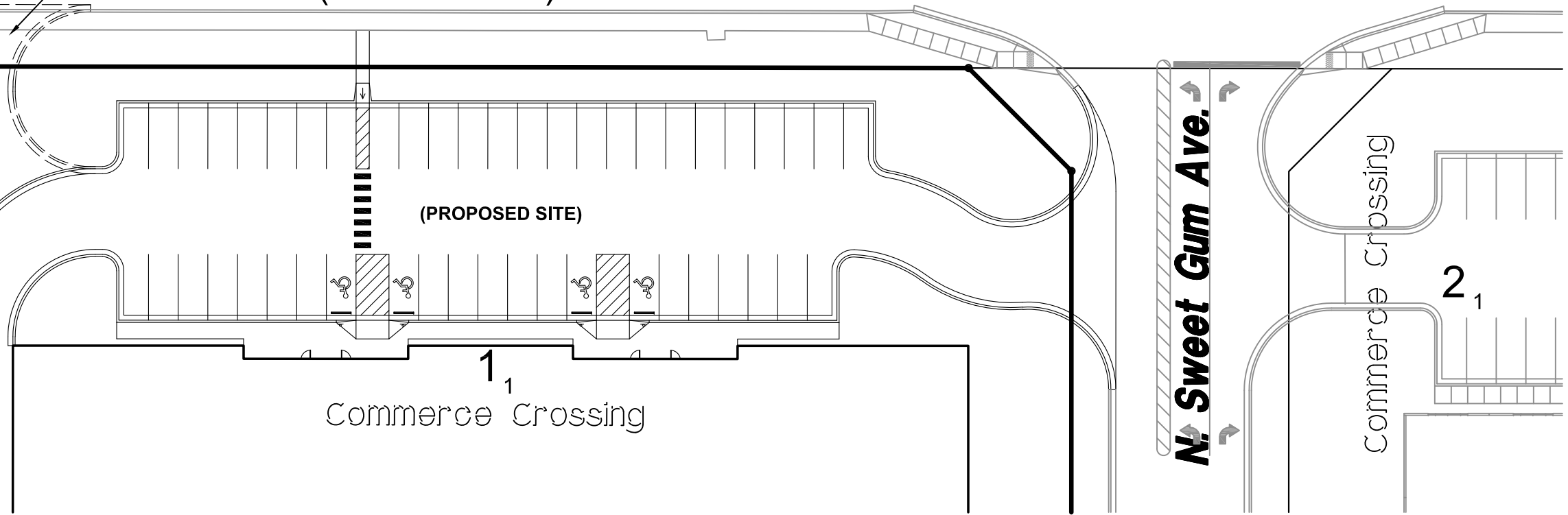

1  
Commerce Crossing

N. Sweet Gum Ave.

Commerce Crossing

2

R 14 E  
(E. 61ST ST. S.)  
W. ALBANY ST.

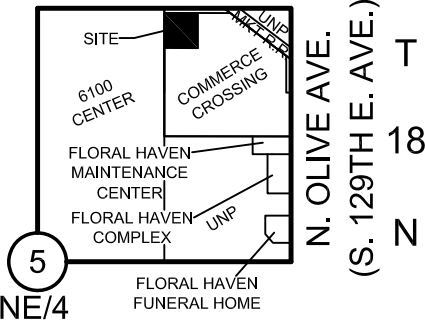

**Location Map**  
SCALE: 1"=2000'

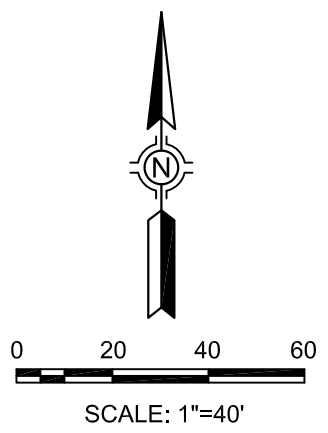

Legend  
ACC = LIMITS OF ACCESS  
LNA = LIMITS OF NO ACCESS

**Change of Access Exhibit**  
of  
**Lot 1, Block 1**

**Commerce Crossing**

City of Broken Arrow, Tulsa County, State of Oklahoma

**Sisemore Weisz & Associates, Inc.**  
6111 EAST 32nd PLACE  
TULSA, OKLAHOMA 74135  
C.A. NO. 2421  
PHONE: (918) 665-3800  
FAX: (918) 665-8668  
EXP. DATE 6/30/17

REVISIONS	BY	DATE

FILE:	1814.05	SURVEY BY:	DATE:	12/2/2016	
ORDER:	17747.01	DRAWN BY:	LAD	SCALE:	1"=40'
BOOK:		CHECKED BY:	JTB	SHEET	1 OF 2