

LOT LINE ADJUSTMENT EXHIBIT
Lot One (1) of Block Four (4),
"ARROW FORGE"

LEGAL DESCRIPTION: PARENT TRACT
(before adjustment)

*Lot One (1) of Block Four (4), ARROW FORGE",
an addition to the City of Broken Arrow, Tulsa
County, Oklahoma, filed as Plat #7215 at the
office of the Tulsa County Clerk.*

1,305,764 Square Feet or 29.9762 Acres

Address:
*3205 West Gulfport Street
5156 South Indianwood Avenue
City of Broken Arrow*

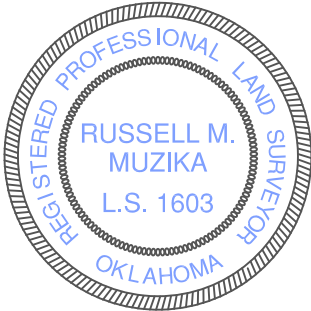

Prepared by Russell M. Muzika,
Ok. PLS No. 1603
December 22, 2025



GEODECA LLC
P.O. Box 33012
Tulsa Oklahoma 74153
(918) 949 4065
CA # 5524 renewal date 6/30/2026

