

ENGINEERING & CONSTRUCTION DEPARTMENT

DOWNTOWN MAIN STREET STREETScape – PHASE IV - STATUS



BROKEN ARROW

Where opportunity lives

PHASE IV – PROJECT MILESTONES

November 9, 2015 City Council approved design contract

December 23, 2015 Schematic design review

April 1, 2016 Preliminary Design Review

June 1, 2016 Final design review

June 15, 2016 Advertisement for bids

July 12, 2016 Bid opening for construction contract bids

July 19, 2016 City Council approval of construction contract award

August 8, 2016 Anticipated notice to proceed

February 9, 2017 Final construction of project

SURVEY CONTROL DATA

- HORIZONTAL/VERTICAL CONTROL:**
BASED ON CONTROL DATA SHEETS AS PROVIDED BY THE CITY OF BROKEN ARROW ENGINEERING DEPARTMENT. HORIZONTAL DATUM NAD-83. VERTICAL DATUM NAVD 1988.
- BASIS OF BEARING:**
STATIONED UTILIZED FOR SURVEY:
TUL-11, TUL-2, AND BA-27.
- SECTION NUMERICAL DESCRIPTION (S-T-R):**
SECTIONS 11, T-18-N, R-14-E, INDIAN MERIDIAN

BEFORE YOU DIG! CALL OKIE 1-800-622-8543

UTILITIES LOCATION SHOWN ON PLAN AND PROFILE WERE OBTAINED FROM INFORMATION PROVIDED BY UTILITY SYSTEM OWNER IN CONJUNCTION WITH EXISTING PHYSICAL FEATURES VISIBLE AT THE TIME OF THE TOPOGRAPHIC SURVEY. LOCATIONS MUST BE VERIFIED BY THE CONTRACTOR PRIOR TO CONSTRUCTION.

UTILITY CONTACTS

CITY OF BROKEN ARROW, OKLAHOMA CITY ENGINEER, TIM HERRIN, P.E. 485 N. POPLAR AVE. BROKEN ARROW, OKLAHOMA 74012 (918) 258-7000 EXT. 5414 (918)258-8453 (FAX)	CITY OF BROKEN ARROW, OKLAHOMA WATER & SEWER, ANTHONY DANIEL 485 N. POPLAR AVE. BROKEN ARROW, OKLAHOMA 74012 (918) 258-7000 X7373 (918) 251-3383 (FAX)
CITY OF BROKEN ARROW, OKLAHOMA STREETS/STORMWATER, STEVE ARANT, P.E. 485 N. POPLAR AVE. BROKEN ARROW, OKLAHOMA 74012 (918) 258-7000 X7420 (918) 251-3383 (FAX)	OKLAHOMA NATURAL GAS ENGINEERING-TULSA OPERATIONS TECHNICAL SUPERVISOR/REGULATOR AT&T, JONATHAN C. MEADOWS (918) 431-8215 (PHONE) (918) 948-8738 (CELL) (918) 431-8208 (FAX)
COX COMMUNICATIONS AT&T, GARY HACKETT 11811 E. 51ST STREET TULSA, OK 74145 (918) 258-4669 (918) 258-4018 (FAX)	OKLAHOMA NATURAL GAS (EXISTING CONNET.) AT&T, BILL WERSON P.O. BOX 671 TULSA, OKLAHOMA 74102 (918) 431-3914 (918) 431-8208 (FAX)
WESTERN COMMUNICATION AT&T, GEORGE WIFE 7300 SOUTH 1ST PLACE BROKEN ARROW, OKLAHOMA 74012 (918) 451-3431 (918) 451-1865 (FAX)	AT&T / PSD AT&T, LORIN D. HICKS 3223 S GARNETT ROAD TULSA, OK 74146 (918) 250-8211 (918) 247-8468 (FAX)
CITY OF BROKEN ARROW, OKLAHOMA PARKS & RECREATION, SCOTT ESMOND 485 N. POPLAR AVE. BROKEN ARROW, OKLAHOMA 74012 (918) 258-2400 X2142	AT&T / PSD AT&T, DUSTIN PHILLIPS 3223 S GARNETT ROAD TULSA, OK 74146 (918) 250-8211

CONVENTIONAL SYMBOLS

—	SECTION LINES
—	PROPOSED ROAD
R/W	RIGHT-OF-WAY LINES - NEW
PRES. R/W	RIGHT-OF-WAY LINES - EXISTING
X	FENCES
— — —	OVERHEAD ELECTRIC LINES
— — —	OVERHEAD TELEPHONE LINES
— — —	SANITARY SEWERS
— — —	GAS LINES
— — —	WATER LINES
— — —	UNDERGROUND TELEPHONE LINES
— — —	CABLE TELEVISION LINES
— — —	UNDERGROUND ELECTRIC
— — —	UNDERGROUND CABLE TELEVISION LINES
— — —	STORM SEWER



CITY OF
BROKEN ARROW

Where opportunity lives

**DOWNTOWN MAIN STREET
STREETSCAPE - PHASE IV
BROKEN ARROW, OKLAHOMA**

PROJECT NUMBER 161709

Location map showing project extents

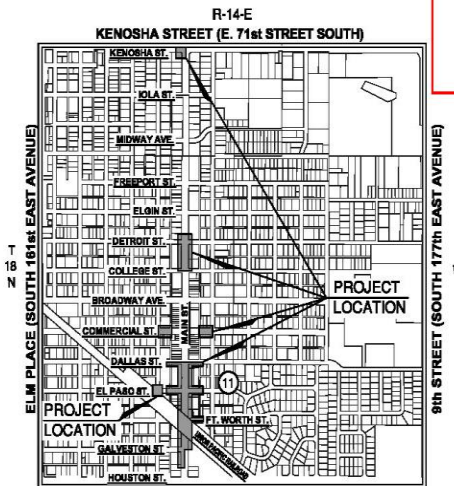

HOUSTON STREET (EAST 81st STREET SOUTH)
PROJECT LOCATION SECTION 11, T-18-N, R-14-E, TULSA COUNTY

R.L. SHEARS COMPANY, P.C.
Landscape Architects
1522 SOUTH CARSON AVENUE
TULSA, OKLAHOMA 74119
TEL 918.582.0612 FAX 918.582.0613
EMAIL: rlshears@rlshearsco.com
CA 91759, EXPIRES 06.30.2017

**ENGINEERING & CONSTRUCTION DEPARTMENT
485 NORTH POPLAR AVENUE
P.O. BOX 610, BROKEN ARROW, OK 74013**

CITY OF BROKEN ARROW STANDARD CONSTRUCTION SPECIFICATIONS, AUGUST 19, 1999,
SHALL GOVERN ALL CONSTRUCTION AS SUPPLEMENTED BY OKLAHOMA STANDARD
SPECIFICATION FOR HIGHWAY CONSTRUCTION, APPROVED BY THE DEPARTMENT OF
TRANSPORTATION 2009.

INDEX OF SHEETS

DESCRIPTION	SHEET
TITLE SHEET	L1
GENERAL PAY QUANTITIES & NOTES (1-3)	L2-L3A
QUANTITIES: TRAFFIC SIGNALS & STRIPING	T1
NOTES: TRAFFIC SIGNALS & STRIPING	T2
LIGHT FIXTURE SCHEDULE	L4
EROSION CONTROL DETAILS	L5
STORMWATER POLLUTION PREVENTION PLAN	L6
KEY MAP	L7
PHASING PLAN	L7A
SURVEY CONTROL DATA (1-2)	SG1-SG2
EXISTING SITE UTILITY PLAN (1-6)	U8-L13
DEMOLITION PLAN (1-5)	L14-L18
SITE PLAN (1-8)	L19-L24
GRADING & LAYOUT PLAN (1-12)	L25-L36
CONSTRUCTION DETAILS (1-17)	L37-L53
TACTILE WARNING DEVICE	L54
GENERAL & PAY ITEM NOTES	C1
STORM SEWER PLAN & PROFILE (1-5)	C2-C5
STORMWATER DETAILS	C7
PAVEMENT PLAN	C8
WATER LINE PLAN & PROFILE (1-3)	C9-C11
GATEWAY FOUNDATION DETAILS	C12
PLANT DRAINAGE & IRRIGATION PLAN (1-5)	L55-L59
IRRIGATION DETAILS (1-2)	L60-L64
OVERALL PLANTING PLAN (1-2)	L61-L62
DETAILED PLANTING PLAN (1-6)	L63-L68
PLANTING DETAILS	L69
ELECTRICAL COVER SHEET	E1
ELECTRICAL ONE-LINE DIAGRAM	E2
ELECTRICAL CIRCUITING PLAN (1-5)	E3-E7
ELECTRICAL CONDUIT & CONDUCTOR PLAN (1-5)	E8-E12
ELECTRICAL DETAILS & SCHEDULES (1-7)	E13-E19
KENOSHA AND MAIN GATEWAY SITE PLAN	E20
KENOSHA AND MAIN GATEWAY DETAILS & SCHEDULES	E21
SIGNAL PLANS, SIGNAL DETAIL PLANS, WIRING DIAGRAMS	T3-T8
CROSSWALK WARNING PLAN (1-2)	T9-T10
LANE STRIPING PLAN (1-8)	T11-T16
SIGNAGE & PARKING STRIPING PLAN (1-5)	L70-L74
PARKING LOCATION MAP	L75

CITY OF BROKEN ARROW COUNCIL

MAYOR	CRAIG THURMOND
VICE MAYOR	RICHARD CARTER
MEMBER	MIKE LESTER
MEMBER	JOHNNIE PARKS
MEMBER	SCOTT EUDEY

APPROVED

DATE _____
KENNETH D. SCHWAB
ASSISTANT CITY MANAGER FOR OPERATIONS

RECOMMENDED FOR APPROVAL

DATE _____
JEFF BIGBY, P.E., CFM
ACTING DIRECTOR OF ENGINEERING & CONSTRUCTION

DATE _____
STEVE ARANT, P.E.
DIRECTOR OF STREETS/STORMWATER



PREPARED BY

DATE 05-23-16
ROBERT L. SHEARS II ASLA, CLARB
R.L. SHEARS COMPANY, P.C.

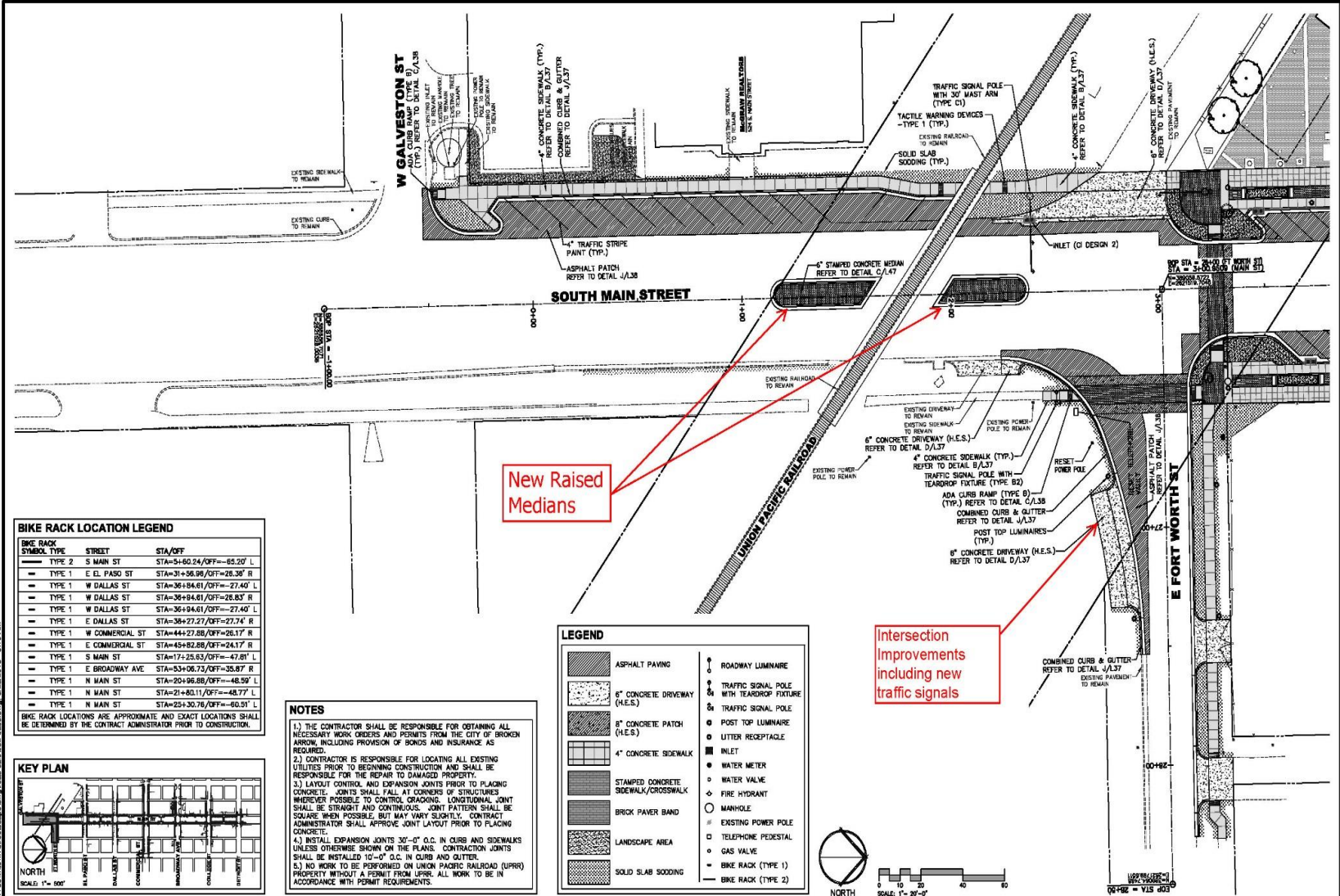

New Raised Medians

Intersection Improvements including new traffic signals

BIKE RACK LOCATION LEGEND

BIKE RACK SYMBOL	TYPE	STREET	STA/OFF
—	TYPE 2	S MAIN ST	STA=54+60.24/OFF=-65.20' L
—	TYPE 1	E EL PASO ST	STA=31+56.96/OFF=26.36' R
—	TYPE 1	W DALLAS ST	STA=36+84.61/OFF=-27.40' L
—	TYPE 1	W DALLAS ST	STA=36+84.61/OFF=26.83' R
—	TYPE 1	W DALLAS ST	STA=36+84.61/OFF=-27.40' L
—	TYPE 1	E DALLAS ST	STA=36+27.77/OFF=27.74' R
—	TYPE 1	W COMMERCIAL ST	STA=44+27.88/OFF=26.17' R
—	TYPE 1	E COMMERCIAL ST	STA=45+82.88/OFF=24.17' R
—	TYPE 1	S MAIN ST	STA=17+25.63/OFF=-47.81' L
—	TYPE 1	E BROADWAY AVE	STA=53+06.73/OFF=35.87' R
—	TYPE 1	N MAIN ST	STA=20+96.88/OFF=-48.59' L
—	TYPE 1	N MAIN ST	STA=21+80.11/OFF=-48.77' L
—	TYPE 1	N MAIN ST	STA=25+30.76/OFF=-60.91' L

BIKE RACK LOCATIONS ARE APPROXIMATE AND EXACT LOCATIONS SHALL BE DETERMINED BY THE CONTRACT ADMINISTRATOR PRIOR TO CONSTRUCTION.

KEY PLAN

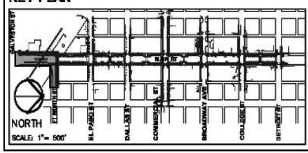

NOTES

- 1.) THE CONTRACTOR SHALL BE RESPONSIBLE FOR OBTAINING ALL NECESSARY WORK ORDERS AND PERMITS FROM THE CITY OF BROKEN ARROW, INCLUDING PROVISION OF BONDS AND INSURANCE AS REQUIRED.
- 2.) CONTRACTOR IS RESPONSIBLE FOR LOCATING ALL EXISTING UTILITIES PRIOR TO BEGINNING CONSTRUCTION AND SHALL BE RESPONSIBLE FOR THE REPAIR TO DAMAGED PROPERTY.
- 3.) LAYOUT CONTROL AND EXPANSION JOINTS PRIOR TO PLACING CONCRETE. JOINTS SHALL FALL AT CORNERS OF STRUCTURES WHERE POSSIBLE TO CONTROL CRACKING. LONGITUDINAL JOINT SHALL BE STRAIGHT AND CONTINUOUS. JOINT PATTERN SHALL BE SQUARE WHEN POSSIBLE BUT MAY VARY SLIGHTLY. CONTRACT ADMINISTRATOR SHALL APPROVE JOINT LAYOUT PRIOR TO PLACING CONCRETE.
- 4.) INSTALL EXPANSION JOINTS 30'-0" O.C. IN CURB AND SIDEWALKS UNLESS OTHERWISE SHOWN ON THE PLANS. CONSTRUCTION JOINTS SHALL BE INSTALLED 10'-0" O.C. IN CURB AND OUTER.
- 5.) NO WORK TO BE PERFORMED ON UNION PACIFIC RAILROAD (UPRR) PROPERTY WITHOUT A PERMIT FROM UPRR. ALL WORK TO BE IN ACCORDANCE WITH PERMIT REQUIREMENTS.

LEGEND

- [Pattern] ASPHALT PAVING
- [Pattern] 6" CONCRETE DRIVEWAY (H.E.S.)
- [Pattern] 8" CONCRETE PATCH (H.E.S.)
- [Pattern] 4" CONCRETE SIDEWALK
- [Pattern] STAMPED CONCRETE SIDEWALK/CROSSWALK
- [Pattern] BRICK PAVEMENT BAND
- [Pattern] LANDSCAPE AREA
- [Pattern] SOLID SLAB SOODING
- [Symbol] ROADWAY LUMINAIRE
- [Symbol] TRAFFIC SIGNAL POLE WITH TEARDROP FIXTURE (H.E.S.)
- [Symbol] TRAFFIC SIGNAL POLE
- [Symbol] POST TOP LUMINAIRE
- [Symbol] LITTER RECEPTACLE
- [Symbol] INLET
- [Symbol] WATER METER
- [Symbol] WATER VALVE
- [Symbol] FIRE HYDRANT
- [Symbol] MANHOLE
- [Symbol] EXISTING POWER POLE
- [Symbol] TELEPHONE PEDESTAL
- [Symbol] GAS VALVE
- [Symbol] BIKE RACK (TYPE 1)
- [Symbol] BIKE RACK (TYPE 2)

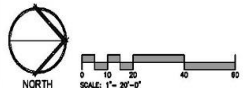

PROJECT: 052-314, D:\downtown streetscape\main\main.dwg, 5/22/2016, 8:10 AM
 USER: RLS

DATE	REVISIONS



R.L. SHEARS COMPANY, P.C.
 Landscape Architects
 1522 SOUTH CARSON AVENUE
 OKLAHOMA CITY, OKLAHOMA 73109
 TEL 516.582.0812 FAX 516.582.8415
 EMAIL: rls@rlshears.com
 CA 01759, EXP 055, 05, 34, 2011

**DOWNTOWN MAIN STREET
 STREETSCAPE PHASE IV**

SITE PLAN (1)

SCALE:	DESIGN	DATE	DRAFTED	DATE
HORIZ. 1" = 20'-0"	RLS	5/25/16	JAB	5/25/16
VERT. 1" = 2'-0"	REVIEWED	DATE	APPROVED	DATE
	RLS	5/25/16	RLS	5/25/16
DRAWING NAME:			PROJECT NO.	
PLAN	SHEET	119	161709	

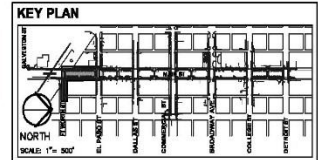
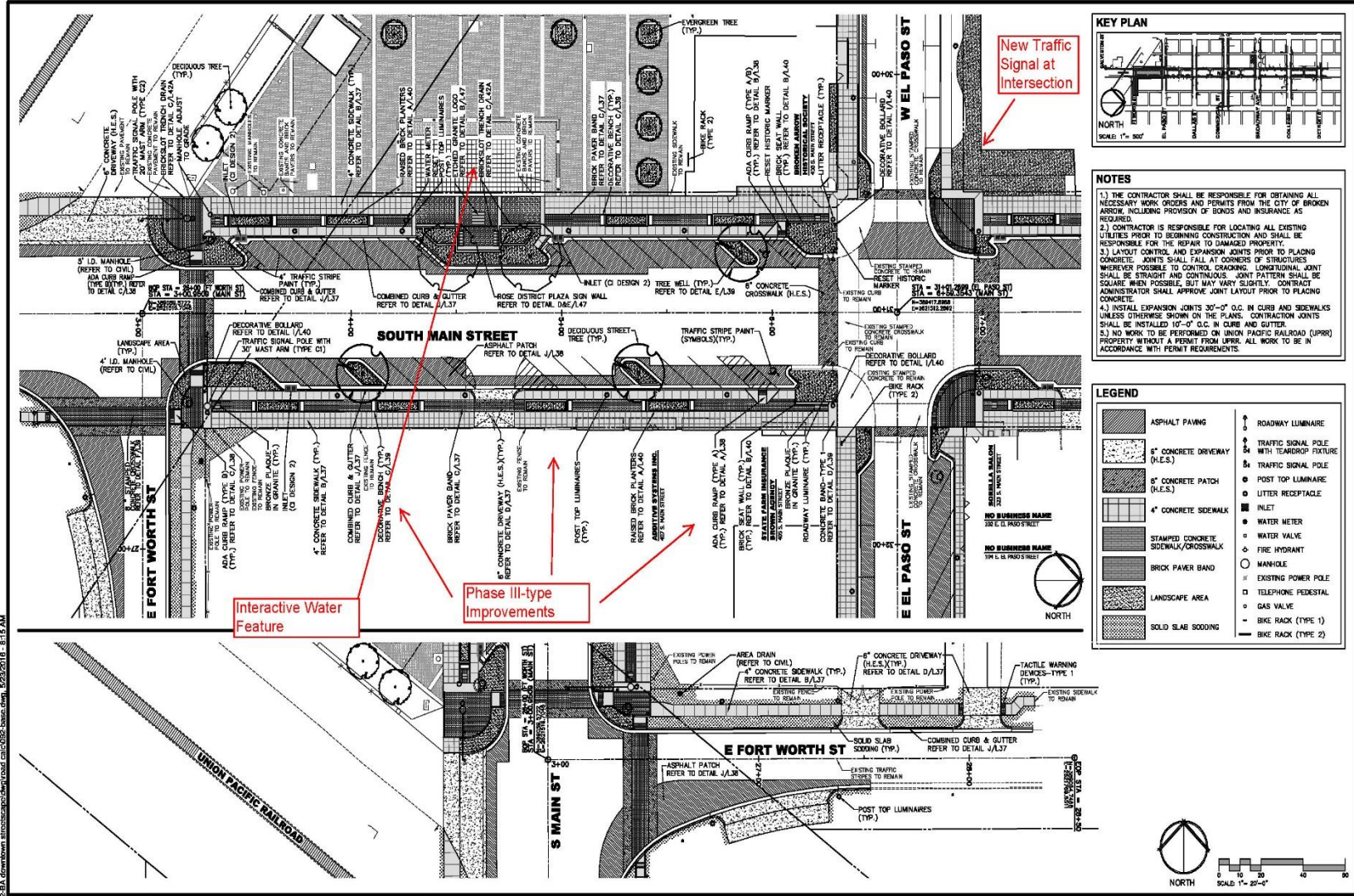

- NOTES**
- 1.) THE CONTRACTOR SHALL BE RESPONSIBLE FOR OBTAINING ALL NECESSARY WORK ORDERS AND PERMITS FROM THE CITY OF BROKEN ARROW, INCLUDING PROVISION OF BONDS AND INSURANCE AS REQUIRED.
 - 2.) CONTRACTOR IS RESPONSIBLE FOR LOCATING ALL EXISTING UTILITIES PRIOR TO BEGINNING CONSTRUCTION AND SHALL BE RESPONSIBLE FOR THE REPAIR TO DAMAGED PROPERTY.
 - 3.) LAYOUT CONTROL AND EXPANSION JOINTS PRIOR TO PLACING CONCRETE. JOINTS SHALL FALL AT CORNERS OF STRUCTURES WHEREVER POSSIBLE TO CONTROL CRACKING. LONGITUDINAL JOINT SHALL BE STRAIGHT AND CONTINUOUS. JOINT PATTERN SHALL BE SQUARE WHEN POSSIBLE, BUT MAY VARY SLIGHTLY. CONTRACT ADMINISTRATOR SHALL APPROVE JOINT LAYOUT PRIOR TO PLACING CONCRETE.
 - 4.) INSTALL EXPANSION JOINTS 30'-0" O.C. IN CURB AND SIDEWALKS UNLESS OTHERWISE SHOWN ON THE PLANS. CONSTRUCTION JOINTS SHALL BE INSTALLED 10'-0" O.C. IN CURB AND GUTTER.
 - 5.) NO WORK TO BE PERFORMED ON UNION PACIFIC RAILROAD (UPRR) PROPERTY WITHOUT A PERMIT FROM UPRR. ALL WORK TO BE IN ACCORDANCE WITH PERMIT REQUIREMENTS.

LEGEND

	ASPHALT PAVING		ROADWAY LUMINAIRE
	8" CONCRETE DRIVEWAY (H.E.S.)		TRAFFIC SIGNAL POLE WITH TEARDROP FIXTURE (H.E.S.)
	8" CONCRETE PATCH (H.E.S.)		TRAFFIC SIGNAL POLE
	4" CONCRETE SIDEWALK		POST TOP LUMINAIRE (H.E.S.)
	STAMPED CONCRETE SIDEWALK/CROSSWALK		LITTER RECEPTACLE
	BRICK PAVER BAND		INLET
	LANDSCAPE AREA		WATER METER
	SOLID SLAB SODDING		WATER VALVE
			FIRE HYDRANT
			MANHOLE
			EXISTING POWER POLE
			TELEPHONE PEDESTAL
			GAS VALVE
			BIKE RACK (TYPE 1)
			BIKE RACK (TYPE 2)

R:\P\Projects\025-2118 - Downtown Streetscape\Road\cadd\02-Street.dwg, 2/23/2018 - 8:15 AM

DATE	REVISIONS

R.L. SHEARS COMPANY, P.C.
 Landscape Architects
 1223 SOUTH CARSON AVENUE
 TULSA, OKLAHOMA 74115
 TEL: 918-438-0152 FAX: 918-592-0815
 EMAIL: rlshears@rlshears.com
 CA #19159, EXPIRES 6-30-2012

**DOWNTOWN MAIN STREET
 STREETScape PHASE IV**

SITE PLAN (2)

SCALE:	DESIGN	DATE	DRAFTED	DATE
HORIZ. 1" = 20'-0"	RLB	6/29/18	JAR	6/29/18
VERT.	RLB	6/29/18	RLB	6/29/18
DRAWING NAME:	PLAN	SHEET	120	PROJECT NO.
				181726

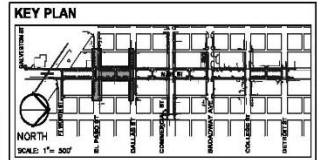
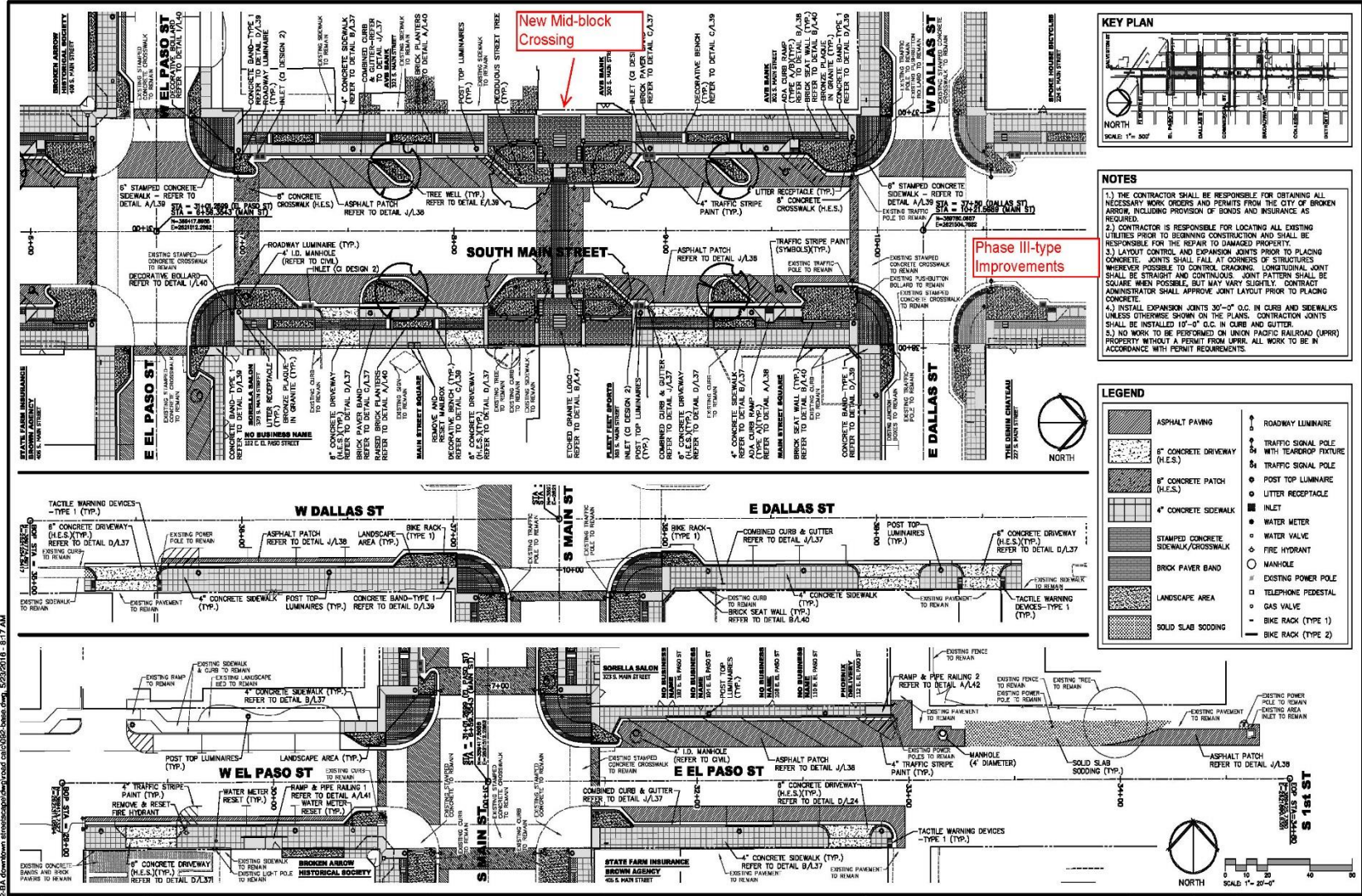

- NOTES**
- 1.) THE CONTRACTOR SHALL BE RESPONSIBLE FOR OBTAINING ALL NECESSARY WORK ORDERS AND PERMITS FROM THE CITY OF BROKEN ARROW, INCLUDING PROVISION OF BONDS AND INSURANCE AS REQUIRED.
 - 2.) CONTRACTOR IS RESPONSIBLE FOR LOCATING ALL EXISTING UTILITIES PRIOR TO BEGINNING CONSTRUCTION AND SHALL BE RESPONSIBLE FOR THE REPAIR TO UNMAGAZED PROPERTY.
 - 3.) LAYOUT CONTROL AND EXPANSION JOINTS PRIOR TO PLACING CONCRETE. JOINTS SHALL FALL AT CORNERS OF STRUCTURES WHEREVER POSSIBLE TO CONTROL CRACKING. LONGITUDINAL JOINTS SHALL BE STRAIGHT AND CONTINUOUS. JOINT PATTERN SHALL BE SQUARE WHEN POSSIBLE, BUT MAY VARY SLIGHTLY. CONTRACT ADMINISTRATOR SHALL APPROVE JOINT LAYOUT PRIOR TO PLACING CONCRETE.
 - 4.) INSTALL EXPANSION JOINTS 30'-0" O.C. IN CURB AND SIDEWALKS UNLESS OTHERWISE SHOWN ON THE PLANS. CONSTRUCTION JOINTS SHALL BE INSTALLED 10'-0" O.C. IN CURB AND GUTTER.
 - 5.) NO WORK TO BE PERFORMED ON UNION PACIFIC RAILROAD (UPRR) PROPERTY WITHOUT A PERMIT FROM UPRR. ALL WORK TO BE IN ACCORDANCE WITH PERMIT REQUIREMENTS.

- LEGEND**
- ASPHALT PAVING
 - 6" CONCRETE DRIVEWAY (H.E.S.)
 - 6" CONCRETE PATCH (H.E.S.)
 - 4" CONCRETE SIDEWALK
 - STAMPED CONCRETE SIDEWALK/CROSSWALK
 - BRICK FAVER BAND
 - LANDSCAPE AREA
 - SOLID SLAB SOODING
 - ROADWAY LUMINAIRE
 - TRAFFIC SIGNAL POLE WITH TEARDROP FIXTURE
 - TRAFFIC SIGNAL POLE
 - POST TOP LUMINAIRE
 - LITTER RECEPTACLE
 - INLET
 - WATER METER
 - WATER VALVE
 - FIRE HYDRANT
 - MANHOLE
 - EXISTING POWER POLE
 - TELEPHONE PEDESTAL
 - GAS VALVE
 - BIKE RACK (TYPE 1)
 - BIKE RACK (TYPE 2)

DATE	REVISION

CITY OF BROKEN ARROW
Where opportunity lives

R.L. SHEARS COMPANY, P.C.
Landscape Architects
1527 SOUTH CARSON AVENUE
TULSA, OKLAHOMA 74119
TEL: 918.442.1112 FAX: 918.442.1111
EMAIL: RLS@RLSHEARS.COM
CA 44-259, EXPIRES 03-31-2014

**DOWNTOWN MAIN STREET
STREETSCAPE PHASE IV**

SITE PLAN (3)

SCALE:	DESIGN	DATE	DRAWN	DATE
HORIZ. 1" = 20'-0"	RLS	5/23/16	JAS	5/23/16
VERT.	REVIEWED	DATE	APPROVED	DATE
	RLS	5/23/16	RLS	5/23/16
DRAWING NAME:	SHEET		PROJECT NO.	
P-LAN	141	161729		

Z:\RLS\Projects\025-SA_downtown-streetscape\main-road_cad\025-base.dwg, 5/23/2016, 5:17 AM

R:\PLS\Projects\0525-21A_Government\streetscape\mainstreet\road\cadd\0525-21A-01.dwg, 5/23/2018, 8:50 AM

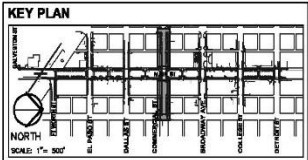
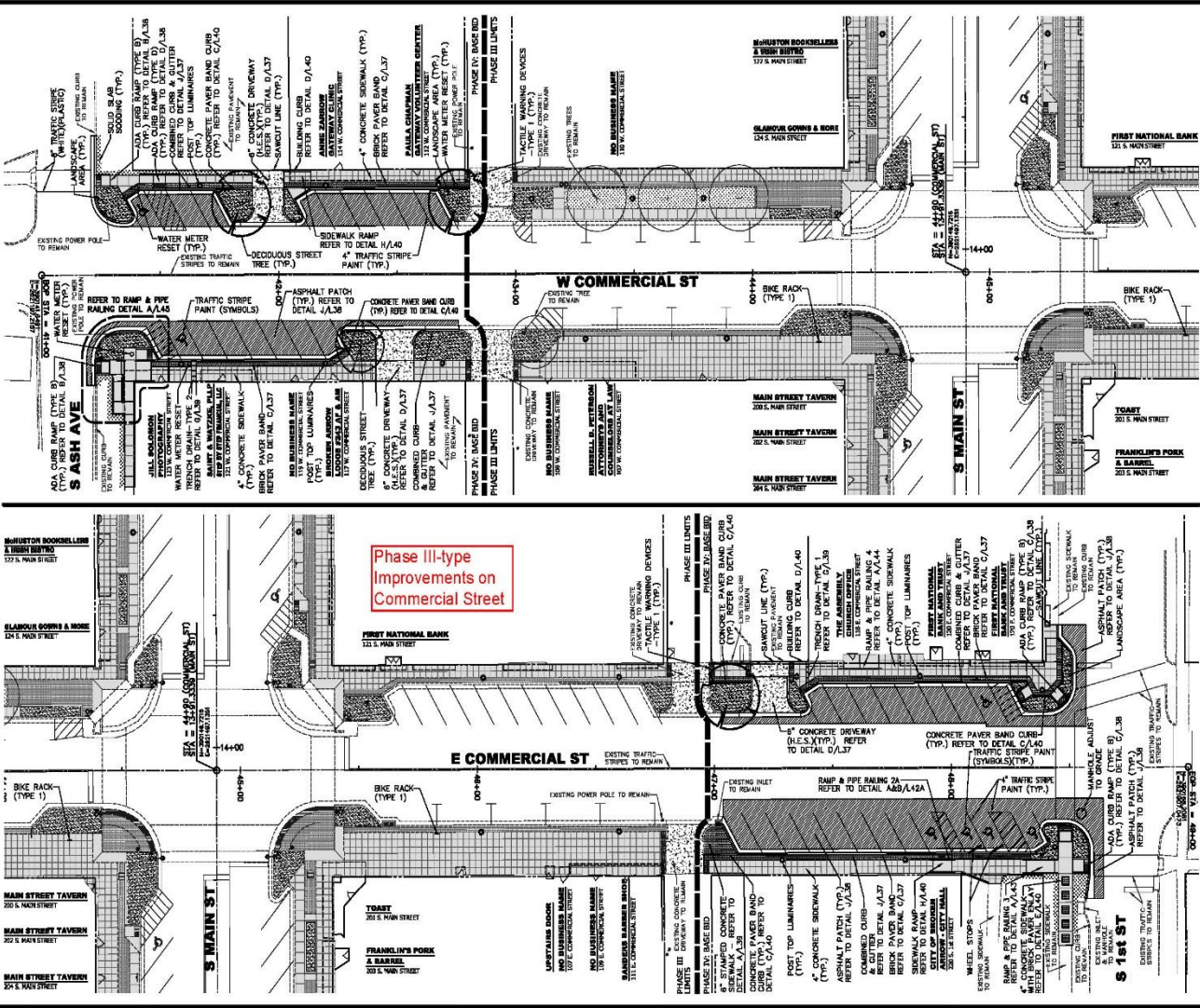

- NOTES**
- 1.) THE CONTRACTOR SHALL BE RESPONSIBLE FOR OBTAINING ALL NECESSARY WORK ORDERS AND PERMITS FROM THE CITY OF BROKEN ARROW, INCLUDING PROVISION OF BONDS AND INSURANCE AS REQUIRED.
 - 2.) CONTRACTOR IS RESPONSIBLE FOR LOCATING ALL EXISTING UTILITIES PRIOR TO BEGINNING CONSTRUCTION AND SHALL BE RESPONSIBLE FOR THE REPAIR TO DAMAGED PROPERTY.
 - 3.) LAYOUT CONTROL AND EXPANSION JOINTS PRIOR TO PLACING CONCRETE. JOINTS SHALL FALL AT CORNERS OF STRUCTURES WHEREVER POSSIBLE TO CONTROL CRACKING. LONGITUDINAL JOINT SHALL BE STRAIGHT AND CONTINUOUS. JOINT PATTERN SHALL BE SQUARE WHEN POSSIBLE, BUT MAY VARY SLIGHTLY. CONTRACT ADMINISTRATOR SHALL APPROVE JOINT LAYOUT PRIOR TO PLACING CONCRETE.
 - 4.) INSTALL EXPANSION JOINTS 30'-0" O.C. IN CURB AND SIDEWALKS UNLESS OTHERWISE SHOWN ON THE PLANS. CONTRACTION JOINTS SHALL BE INSTALLED 10'-0" O.C. IN CURB AND CUTTER.
 - 5.) NO WORK TO BE PERFORMED ON UNION PACIFIC RAILROAD (UPRR) PROPERTY WITHOUT A PERMIT FROM UPRR. ALL WORK TO BE IN ACCORDANCE WITH PERMIT REQUIREMENTS.

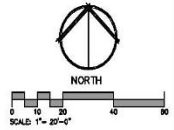
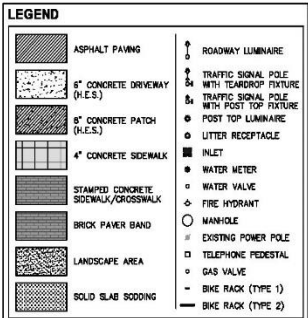

Phase III-type Improvements on Commercial Street

DATE	REVISIONS



R.L. SHEARS COMPANY, P.C.
 Landscape Architects
 1222 SOUTH CARSON AVENUE
 TULSA, OKLAHOMA 74106
 TEL: 918-438-1122 FAX: 918-438-0845
 EMAIL: rlshears@rlshears.com
 C.A. #19259, EXP. DATE 5-31-2012

DOWNTOWN MAIN STREET STREETScape PHASE IV

SITE PLAN (4)

SCALE:	DESIGN:	DATE:	DRAFTED:	DATE:
HORIZ. 1" = 20'-0"	RLB	5/23/18	JAR	5/23/18
REVIEWED:	DATE:	APPROVED:	DATE:	
RLB	5/23/18	RLB	5/23/18	
DRAWING NAME:	PLAN	SHEET:	L22	PROJECT NO. 181726

R:\PLS-Projects\0525-218 - Downtown Streetscape\chgs\road_cuts\0525-base.dwg, 5/23/2018 - 8:08 AM

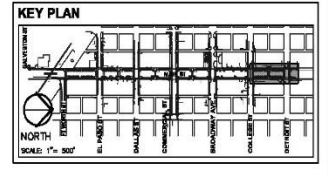
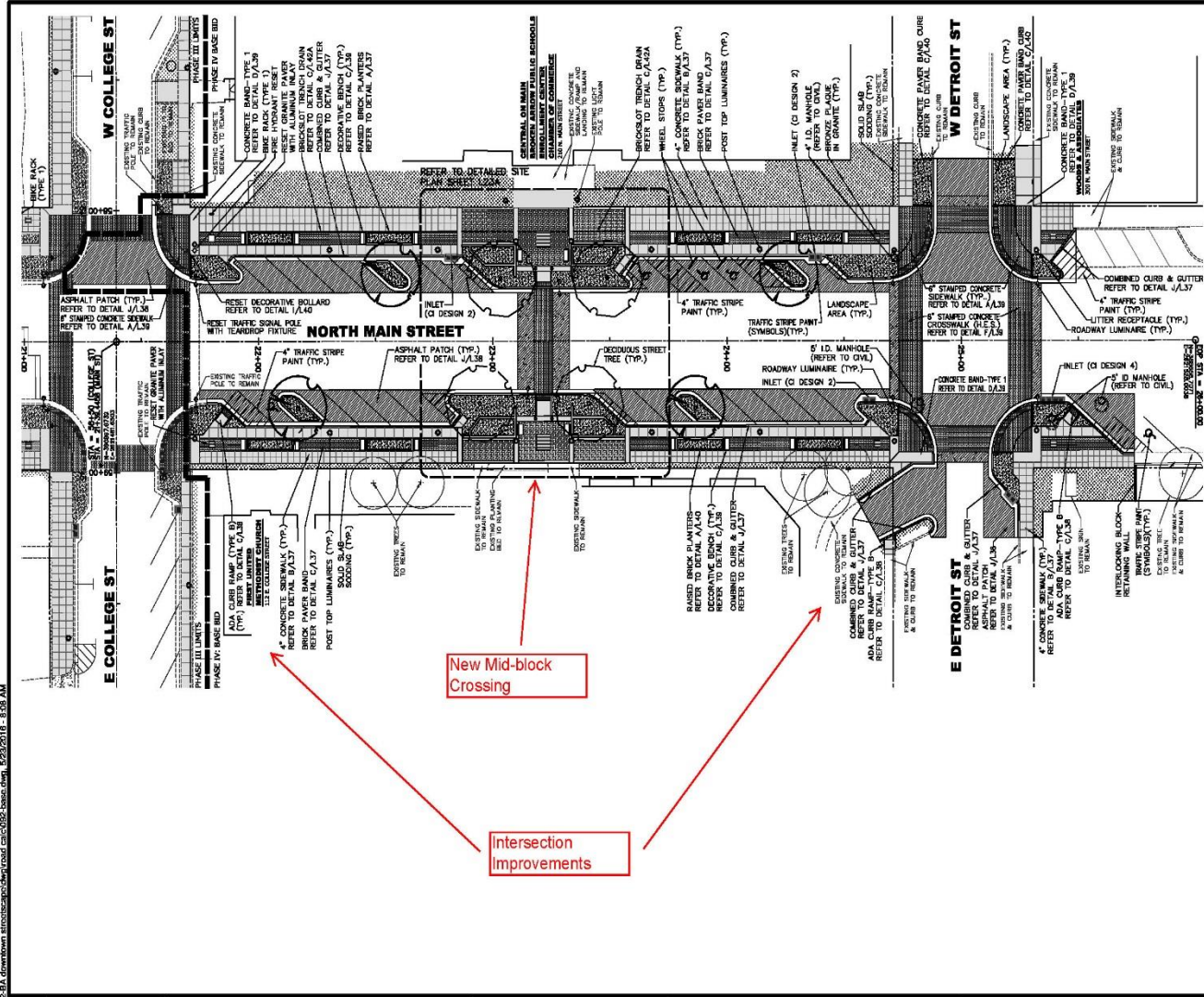

- NOTES**
- 1.) THE CONTRACTOR SHALL BE RESPONSIBLE FOR OBTAINING ALL NECESSARY WORK ORDERS AND PERMITS FROM THE CITY OF BROKEN ARROW, INCLUDING PROVISION OF BONDS AND INSURANCE AS REQUIRED.
 - 2.) CONTRACTOR IS RESPONSIBLE FOR LOCATING ALL EXISTING UTILITIES PRIOR TO BEGINNING CONSTRUCTION AND SHALL BE RESPONSIBLE FOR THE REPAIR TO DAMAGED PROPERTY.
 - 3.) LAYOUT CONTROL AND EXPANSION JOINTS PRIOR TO PLACING CONCRETE. JOINTS SHALL FALL AT CORNERS OF STRUCTURES. WHEREVER POSSIBLE TO CONTROL CRACKING, LONGITUDINAL JOINT SHALL BE STRAIGHT AND CONTINUOUS. JOINT PATTERN SHALL BE SQUARE WHEN POSSIBLE, BUT MAY VARY SLIGHTLY. CONTRACT ADMINISTRATOR SHALL APPROVE JOINT LAYOUT PRIOR TO PLACING CONCRETE.
 - 4.) INSTALL EXPANSION JOINTS 30'-0" O.C. IN CURB AND SIDEWALKS UNLESS OTHERWISE SHOWN ON THE PLANS. CONTRACTION JOINTS SHALL BE INSTALLED 10'-0" O.C. IN CURB AND GUTTER.
 - 5.) NO WORK TO BE PERFORMED ON UNION PACIFIC RAILROAD (UPRR) PROPERTY WITHOUT A PERMIT FROM UPRR. ALL WORK TO BE IN ACCORDANCE WITH PERMIT REQUIREMENTS.

LEGEND

	ASPHALT PAVING		ROADWAY LUMINAIRE
	8" CONCRETE DRIVEWAY (H.E.S.)		TRAFFIC SIGNAL POLE WITH TEARDROP FIXTURE (H.E.S.)
	8" CONCRETE PATCH (H.E.S.)		TRAFFIC SIGNAL POLE WITH POST TOP FIXTURE (H.E.S.)
	4" CONCRETE SIDEWALK		POST TOP LUMINAIRE (H.E.S.)
	STAMPED CONCRETE SIDEWALK/CROSSWALK		LITTER RECEPTACLE
	BRICK PAVER BAND		INLET
	LANDSCAPE AREA		WATER METER
	SOLID SLAB SODDING		WATER VALVE
			FIRE HYDRANT
			MANHOLE
			EXISTING POWER POLE
			TELEPHONE PEDESTAL
			GAS VALVE
			BIKE RACK (TYPE 1)
			BIKE RACK (TYPE 2)

New Mid-block Crossing

Intersection Improvements

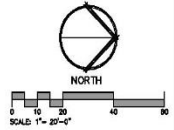

DATE	REVISIONS

CITY OF BROKEN ARROW
Where opportunity lives

R.L. SHEARS COMPANY, P.C.
 Landscape Architects
 1222 SOUTH CARSON AVENUE
 TULSA, OKLAHOMA 74103
 TEL: 918-438-2152, FAX: 918-582-0803
 EMAIL: rlshears@rlshears.com
 CA #4759, EXPIRES 5-19-2015

DOWNTOWN MAIN STREET STREETScape PHASE IV

SITE PLAN (5)

SCALE:	DESIGN:	DATE:	DRAFTED:	DATE:
HORIZ. 1" = 20'-0"	RLS	5/23/18	JAR	5/23/18
REVIEWED:	DATE:	APPROVED:	DATE:	
RLS	5/23/18	RLS	5/23/18	
DRAWING NAME: PLAN	SHEET: 123	PROJECT NO: 181726		

Z:\R.L.S. Projects\0925-24 Downtown Streetscape\main\main_gateway_basin.dwg, 3/23/2016 - 11:50 AM

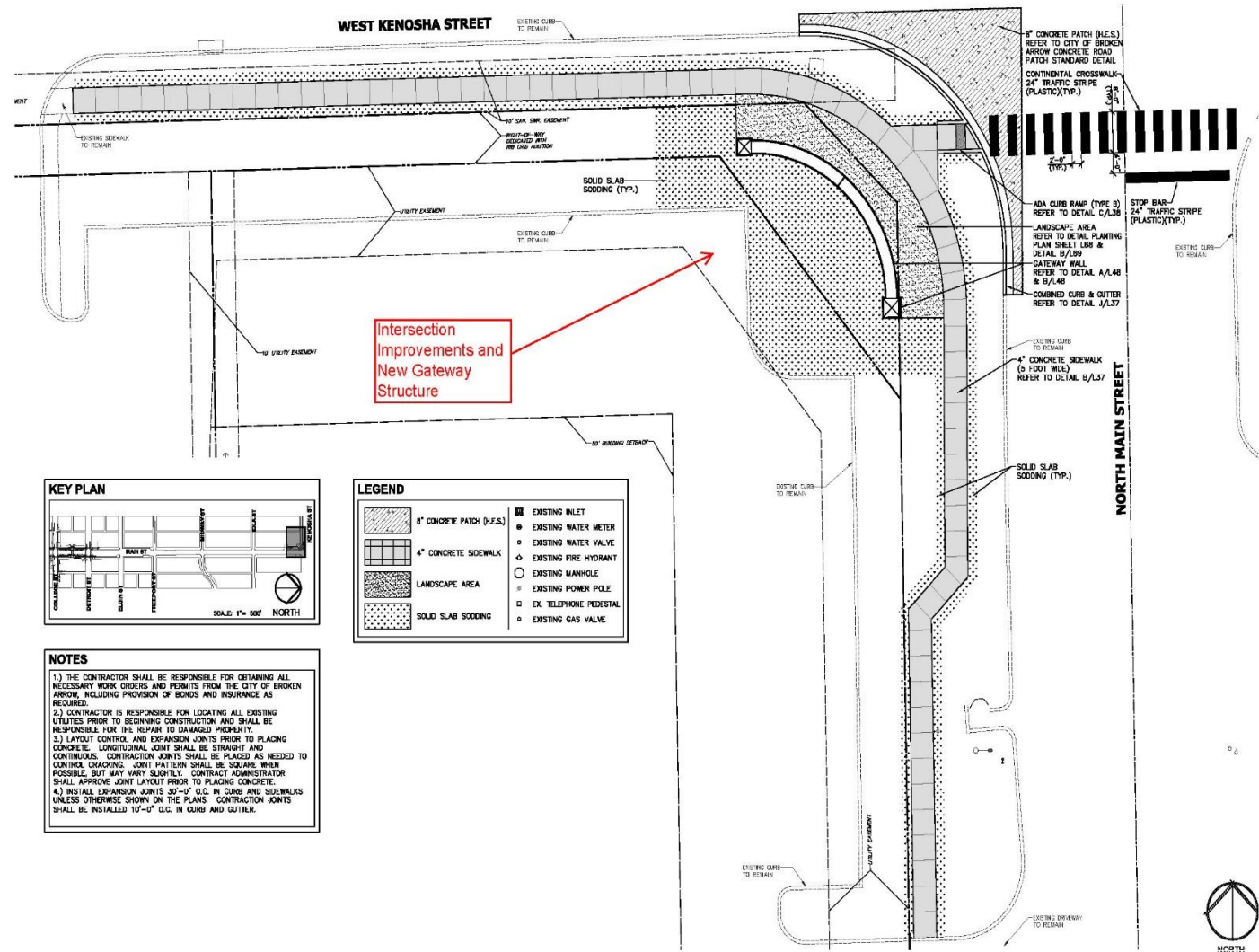

Intersection
Improvements and
New Gateway
Structure

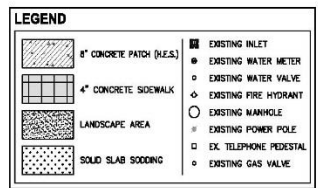
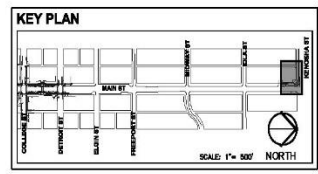

NOTES

- 1.) THE CONTRACTOR SHALL BE RESPONSIBLE FOR OBTAINING ALL NECESSARY WORK ORDERS AND PERMITS FROM THE CITY OF BROKEN ARROW, INCLUDING PROVISION OF BONDS AND INSURANCE AS REQUIRED.
- 2.) CONTRACTOR IS RESPONSIBLE FOR LOCATING ALL EXISTING UTILITIES PRIOR TO BEGINNING CONSTRUCTION AND SHALL BE RESPONSIBLE FOR THE REPAIR TO DAMAGED PROPERTY.
- 3.) LAYOUT CONTROL AND EXPANSION JOINTS PRIOR TO PLACING CONCRETE. LONGITUDINAL JOINT SHALL BE STRAIGHT AND CONTINUOUS. CONTRACTION JOINTS SHALL BE PLACED AS NEEDED TO CONTROL CRACKING. JOINT PATTERN SHALL BE SQUARE WHEN POSSIBLE, BUT MAY VARY SQUABLY. CONTRACT ADMINISTRATOR SHALL APPROVE JOINT LAYOUT PRIOR TO PLACING CONCRETE.
- 4.) INSTALL EXPANSION JOINTS 30'-0" O.C. IN CURB AND SIDEWALKS UNLESS OTHERWISE SHOWN ON THE PLANS. CONTRACTION JOINTS SHALL BE INSTALLED 10'-0" O.C. IN CURB AND GUTTER.

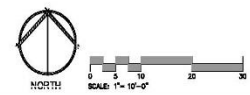

DATE	REVISIONS
-	-
-	-
-	-
-	-
-	-



R.L. SHEARS COMPANY, P.C.
Landscape Architects

1122 SOUTH CARSON AVENUE
TULSA, OKLAHOMA 74103
TEL 918-482-0952 FAX 918-482-0613
EMAIL: rlsh@rlshears.com
CA 41729, EXPIRES 10-20-2015

**DOWNTOWN MAIN STREET
STREETSCAPE PHASE IV**

**KENOSHA & MAIN GATEWAY
SITE PLAN (6)**

SCALE:	DESIGN	DATE	DRAFTED	DATE
HORIZ. 1" = 10'-0"	RLS	5/23/16	JAG	5/23/16
VERT. 1" = 10'-0"	REVIEWED	DATE	APPROVED	DATE
DRAWING NAME:	RLS	5/23/16	RLS	5/23/16
PLAN	SHEET	124	PROJECT NO.	181729

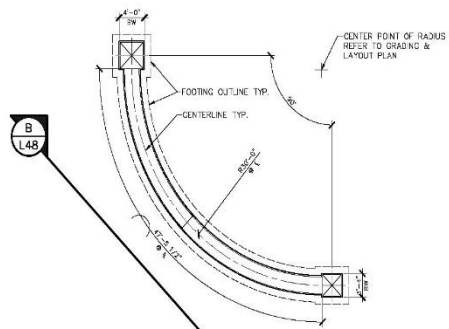

A PLAN VIEW: GATEWAY WALL
NOT TO SCALE

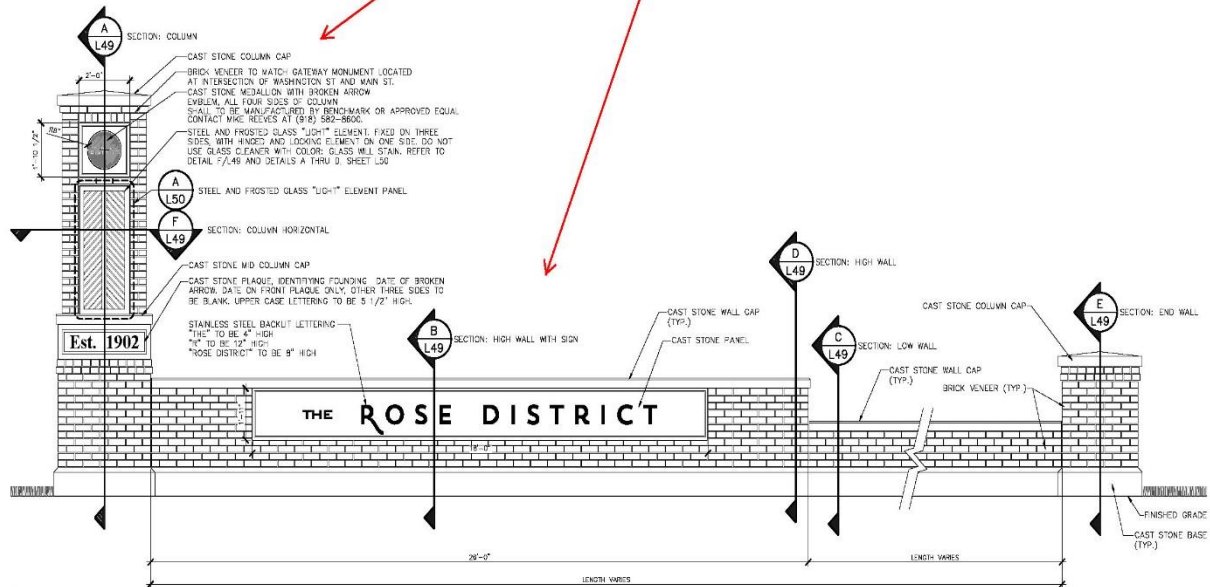

B ELEVATION: GATEWAY WALL
NOT TO SCALE

NOTES:

- 1.) IF SUBGRADE SOIL IS SOFT, MUCKY OR PLASTIC IN NATURE, THEN OVER EXCAVATE & REPLACE WITH LOW PLASTICITY SOIL, I.E. PI LESS THAN OR EQUAL TO TEN (10)
- 2.) TOP OF ENTRY COLUMNS SHALL REMAIN LEVEL. STEP FOOTING DICTATED BY FINISH GRADE IF NEEDED TO MAINTAIN A MINIMUM DEPTH OF SOIL ON TOP OF FOOTING.
- 3.) FINISH GRADE SHALL PROVIDE POSITIVE DRAINAGE AWAY FROM WALL AND COLUMNS.
- 4.) RETURN DISTURBED AREAS BACK TO ORIGINAL CONDITION PRIOR TO FINAL PAYMENT.
- 5.) CONTRACTOR IS RESPONSIBLE FOR LOCATING ALL EXISTING UTILITIES PRIOR TO BEGINNING CONSTRUCTION AND SHALL BE RESPONSIBLE FOR THE REPAIR TO DAMAGED PROPERTY.
- 7.) CONTRACTOR SHALL VERIFY ALL FIELD CONDITIONS IN DEMOLITION & CONSTRUCTION AREAS. CONTRACTOR SHALL SUBMIT DESCRIPTIONS OF ALL DISCREPANCIES BETWEEN FIELD CONDITIONS & DRAWINGS TO THE ENGINEER TEN (10) DAYS PRIOR TO BID.
- 8.) ARTWORK FOR CITY OF BROKEN ARROW LOGO, ROSE DISTRICT LOGO, AND ROSE DISTRICT LETTERING SHALL BE PROVIDED BY LANDSCAPE ARCHITECT.
- 9.) CAST STONE MEDALLION EMBLEM TO BE RECESSED 1/4" INTO CAST STONE AND PAINTED BLACK.
- 10.) BRICK VENEER TO BE EQUAL TO WINDSOR PARK (ELEM) BY ACME BRICK OR APPROVED EQUAL. CONTACT DARY SATTERFIELD WITH ACME BRICK (518)965-5235.
- 11.) GATEWAY TO BE GRADED TO ALLOW FOOTING AND CAST STONE BASE TO REMAIN LEVEL TO THE GREATEST EXTENT POSSIBLE. STEP WALL IN 8" INTERVALS ONCE GRADE EXCEEDS THAT AMOUNT. DO NOT STEP SIGN PORTION OF THE WALL.

New Gateway Wall and Column

Z:\RLS-Projects\025-5A Downtown Streetscape\025-04818 - p.m.dwg, 5/22/2018 - 11:23 AM

DATE	REVISIONS



R.L. SHEARS COMPANY, P.C.
Landscape Architects
1122 SOUTH CARSON AVENUE
DULUTH, GEORGIA 30133
TEL: 404-525-0416 FAX: 404-525-0417
EMAIL: rls@rlshears.com
GA #12787 EXP. 12/31/2018

**DOWNTOWN MAIN STREET
STREETSCAPE PHASE IV**

**KENOSHA & MAIN GATEWAY
CONSTRUCTION
DETAILS (12)**

SCALE:	DESIGN	DATE	DRAFTED	DATE
HORIZ	R.L.S.	5/22/18	J.S.	5/22/18
VERT	REVIEWED	DATE	APPROVED	DATE
	R.L.S.	5/22/18	R.L.S.	5/22/18
DRAWING NAME:	PROJECT NO.			
DETAIL	SHEET			
	LAB.	18722		

INTERACTIVE WATER FEATURE CONSTRUCTION UPDATE as of 7/8/ 2016

- All Storm piping has been installed.
- Over excavation for the fountain slab is complete and has been backfilled. Vapor barrier and rebar is currently being installed.
- Piping for the water mains from the edge of the pit to the edge of the mechanical yard is installed.
- Layout for the jets and lights is complete. The electrical and plumbing rough-in is installed.
- The site has been rough graded to subgrade
- Mechanical skids are onsite and planned to be installed the week of 07\11.
- Electrical rough in in the mechanical yard is being installed.
- The fountain slab will be poured the week of 07\11.