

LEGAL NOTICE OF ANNEXATION

On December 15, 2015, an Ordinance to annex property for a residential subdivision on 39 acres of land located in Section One (1), Township 17 North, Range 14 East of the Indian Base and Meridian, Tulsa County, State of Oklahoma, according to the United States Government Survey thereof and located south of East Tucson Street (East 121st Street South) and west of County Line Road (South 193rd East Avenue) will be previewed by the Broken Arrow City Council. A map of the area is attached. The Legal Description of the property is described as follows:

Part of the SE/4 of the NE/4 of Section One (1), Township 17 North, Range 14 East of the Indian Base and Meridian, Tulsa County, State of Oklahoma, according to the United States Government Survey thereof, described as follows:

BEGINNING 200 feet South of the Northeast Corner of the SE/4 of the NE/4; thence West 800 feet; thence South 400 feet; thence East 546 feet; thence North 370 feet; thence East 254 feet; thence North 30 feet to the POINT OF BEGINNING. (5.189 acres)

AND

The SE/4 of the NE/4 LESS 210 foot by 210 foot square located in the Southeast Corner thereof and LESS BEGINNING 200 feet South of the Northeast Corner of the SE/4 of the NE/4; thence West 800 feet; thence South 400 feet; thence East 546 feet; thence North 370 feet; thence East 254 feet; thence North 30 feet to the POINT OF BEGINNING all in Section One (1), Township Seventeen (17) North, Range Fourteen (14) East of the Indian Base and Meridian, Tulsa County, State of Oklahoma, according to the United States Government Survey thereof. (33.811 acres)

A public hearing and final approval of the Ordinance will be held before the Broken Arrow City Council on the 5th day of January, 2016, at 6:30 p.m., in Broken Arrow City Hall. All persons interested in this matter may be present at that hearing and present their objections to or arguments for the above matter.

Dated in Broken Arrow, Oklahoma, this 1st day of December, 2015.

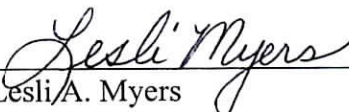

Lesli A. Myers
Assistant City Attorney

PUD-133A
R-2
B.A. SOUTH LOOP

S-13TH ST
S-13TH PL
S-13TH PL
S-14TH ST
S-15TH PL
E PASADENA ST
F QUANAH ST
SAN DIEGO ST

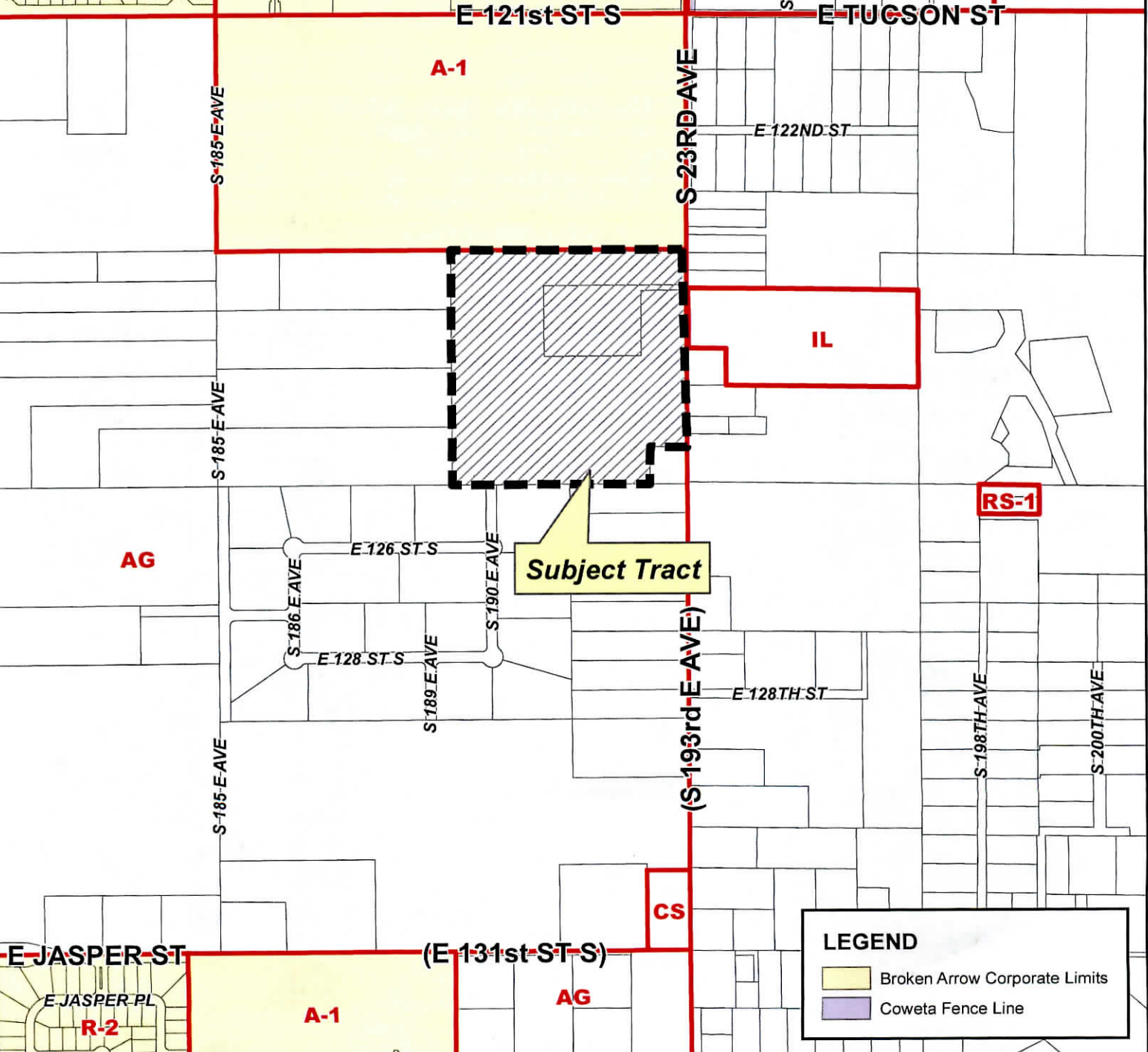

Subject Tract

LEGEND

- Broken Arrow Corporate Limits
- Coweta Fence Line

300' Radius

Subject Tract

**PROPOSED ANNEXATION
TUCSON & COUNTY LINE**



01 17-14

PUD-133A
R-2
B.A. SOUTH LOOP

S-13TH ST
E PASADENA ST
F QUANAH ST
RS-3
S-13TH PL
S-14TH ST
S-15TH PL
SAN DIEGO ST

E-121st ST S
E TUCSON ST

A-1
AG
RS-0
S-185 E AVE
S-23RD AVE COUNTY LINE RD
E HICKORY ST
S SYCAMORE ST
S SYCAMORE ST
E 122ND ST

IL
AG
S-185 E AVE
E 126 ST S
E 128 ST S
S-186 E AVE
S-189 E AVE
S-190 E AVE
S-193rd E AVE
E 128TH ST

AG
CS
AG
RS-1
S-198TH AVE
S-200TH AVE

E JASPER ST
E JASPER PL
R-2
A-1
AG
CS
E-131st ST S
LEGEND
Broken Arrow Corporate Limits
Coweta Fence Line

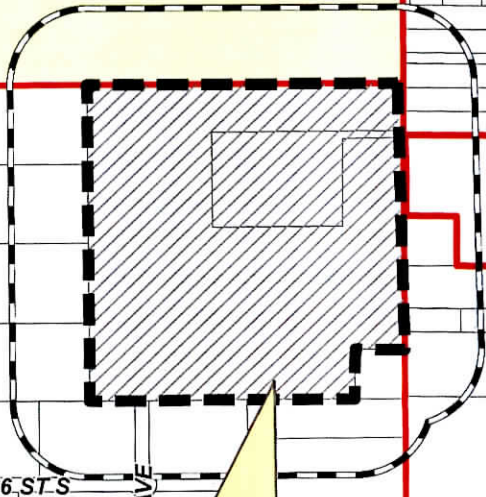

Subject Tract



300' Radius



Subject Tract

PROPOSED ANNEXATION
TUCSON & COUNTY LINE

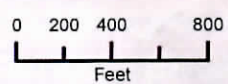

01 17-14

