

ANNEXATION TRACT
Legal Description

Exhibit A
Page 1 of 3

A Tract of land, being a part of the Northwest Quarter (NW/4) of the Northwest Quarter (NW/4) of the Southeast Quarter (SE/4) of Section Fifteen (15), Township Eighteen North (T18N), Range Fifteen East (R15E) of the Indian Meridian (I.M.), Wagoner County, State of Oklahoma, and being more particularly described as follows:

COMMENCING at the Northwest corner of the Southeast Quarter (SE/4) of Section Fifteen (15), Township Eighteen North (T18N), Range Fifteen East (R15E) of the Indian Meridian (I.M.);

Thence South 01 Degrees 10 Minutes 08 Seconds East along the West line of said Southeast Quarter (SE/4) a distance of 610.00 feet;

Thence North 88 Degrees 50 Minutes 25 Seconds East a distance of 290.20 feet to the POINT OF BEGINNING;

Thence North 88 Degrees 50 Minutes 25 Seconds East continuing along said line a distance of 195.14 feet;

Thence North 01 Degrees 12 Minutes 25 Seconds West a distance of 30.11 feet;

Thence South 88 Degrees 47 Minutes 35 Seconds West a distance of 195.14 feet;

Thence South 01 Degrees 12 Minutes 25 Seconds East a distance of 29.95 feet to the POINT OF BEGINNING. Containing 5,859 square feet or 0.1345 acres of land, more or less.

Basis of Bearings:

Grid North based on NAD 83, Oklahoma State Plane Coordinate System
North Zone

I, Brandon P. Holland, a Licensed Professional Land Surveyor in the State of Oklahoma, certify that the above description is a true representation of the property described and meets the Minimum Standards for Land Surveying in the state of Oklahoma. This seal covers sheets 1 and 2.



 03-29-22
Brandon P. Holland Date

OK PLS NO. 1983 — Expires April 30, 2022
OK CA NO. 2483 — Expires June 30, 2023

EXHIBIT

1-2

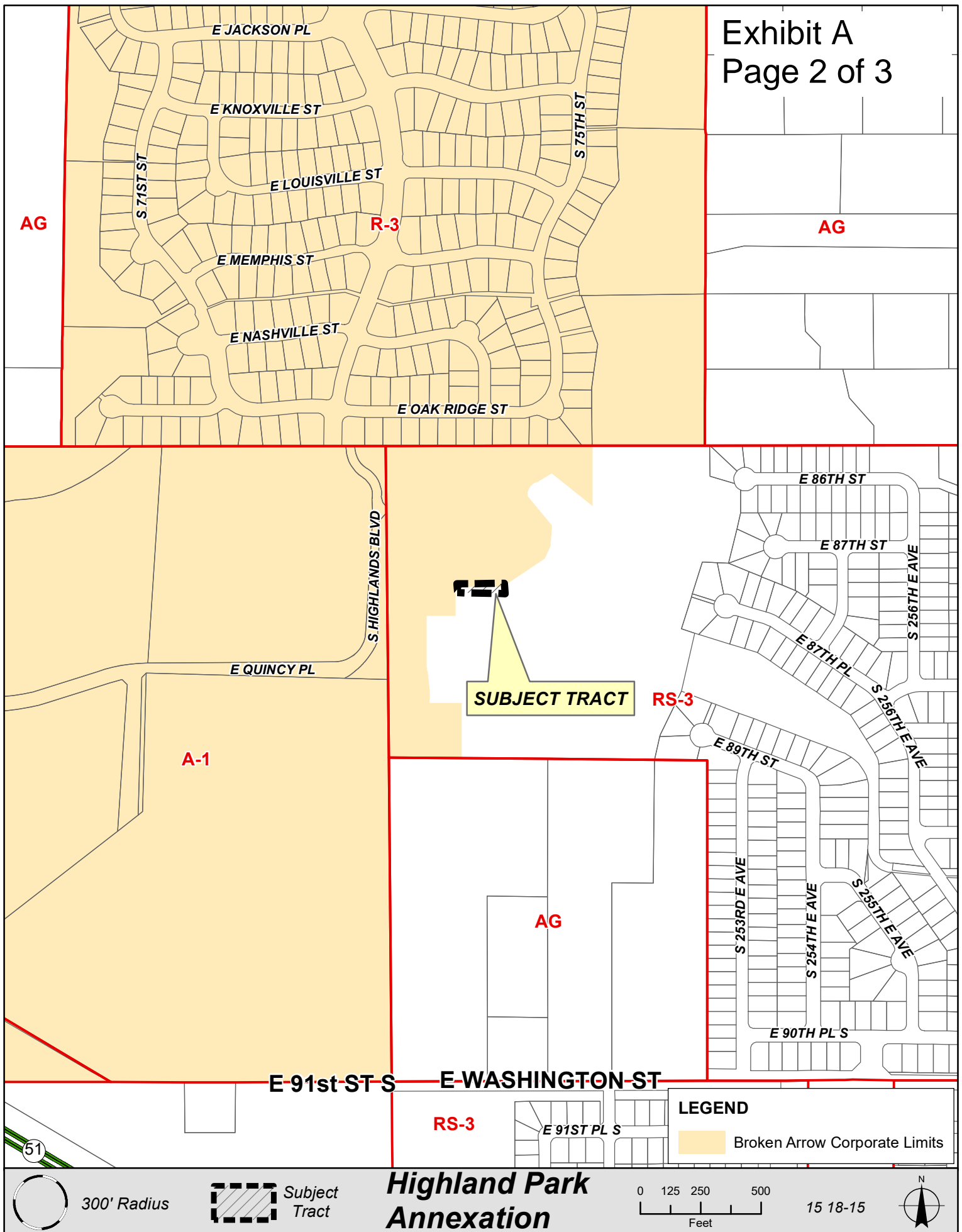



51

Note: Graphic overlays may not precisely align with physical features on the ground.
Aerial Photo Date: 2020/2021



Subject Tract

Highland Park Annexation

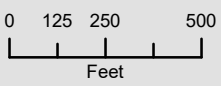

15 18-15

