

Found Brass Cap NW Corner of NW/4 of Section 2,
T-18-N, R-14-E, Tulsa County, State of Oklahoma

SECTION LINE

POINT OF
COMMENCEMENT

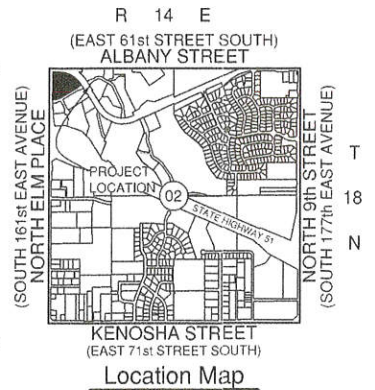

POINT OF
BEGINNING

S01°11'17"E
224.72'

East line of NW/4 of Section 2,
T-18-N,
R-14-E, Tulsa County, State of Oklahoma

N. ELM PLACE

TRACT B

LOT B

N88°48'43"E
161.71'

N31°45'27"E
8.98'

LOT A

LOT C

TEMPORARY
OVERLAND
DRAINAGE
EASEMENT
1631 SQFT
0.04 ACRES

N01°03'25"W
171.22'

S04°03'13"E
170.94'

S58°39'27"W
15.99'

LOT D

Stone Wood Drive

LEGAL DESCRIPTION TEMPORARY OVERLAND DRAINAGE EASEMENT

A TRACT OF LAND IN THE NORTHWEST QUARTER (NW/4) OF SECTION TWO (2), TOWNSHIP EIGHTEEN (18) NORTH, RANGE FOURTEEN (14) EAST OF THE INDIAN BASE AND MERIDIAN, TULSA COUNTY, OKLAHOMA, MORE PARTICULARLY DESCRIBED AS FOLLOWS, TO WIT:

COMMENCING AT THE NORTHWEST CORNER OF SAID NW/4; THENCE S01°11'17"E ALONG THE WEST LINE OF SAID NW/4 A DISTANCE OF 224.72 FEET; THENCE N88°48'43"E A DISTANCE OF 161.71 FEET TO THE POINT OF BEGINNING; THENCE S04°03'13"E A DISTANCE OF 170.94 FEET; THENCE S58°39'27"W A DISTANCE OF 15.99 FEET; THENCE N01°03'25"W A DISTANCE OF 171.22 FEET; THENCE N31°45'27"E A DISTANCE OF 8.98 FEET TO THE POINT OF BEGINNING. HAVING AN AREA OF 1631 SQUARE FEET, 0.04 ACRES MORE OR LESS

WITNESS MY HAND AND SEAL THIS DATE

DAVID L. CANTRELL
LICENSED PROFESSIONAL LAND SURVEYOR
OKLAHOMA NO. 351
7/8/2015



COOK & ASSOCIATES ENGINEERING INC.
• Engineering • Surveying • Geotechnical • Construction Management •
www.cook-eng.com
1486 East Poplar Street Fort Gibson, OK 74434
Certificate of Authorization #4479 Expires June 30, 2016

TRACT B OVERLAND DRAINAGE EASEMENT
THE VILLAGE AT STONE WOOD HILLS
BROKEN ARROW, OK

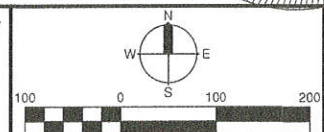

DRAFTER
DATE
7/2015
DRAWING