

CONDITIONAL FINAL PLAT FOR

Doc's Container Storage

PUD 274

AN ADDITION TO THE CITY OF BROKEN ARROW, OKLAHOMA... A REPLAT OF LOT 1, BLOCK 2, COUCH ADDITION, WAGONER COUNTY, OKLAHOMA

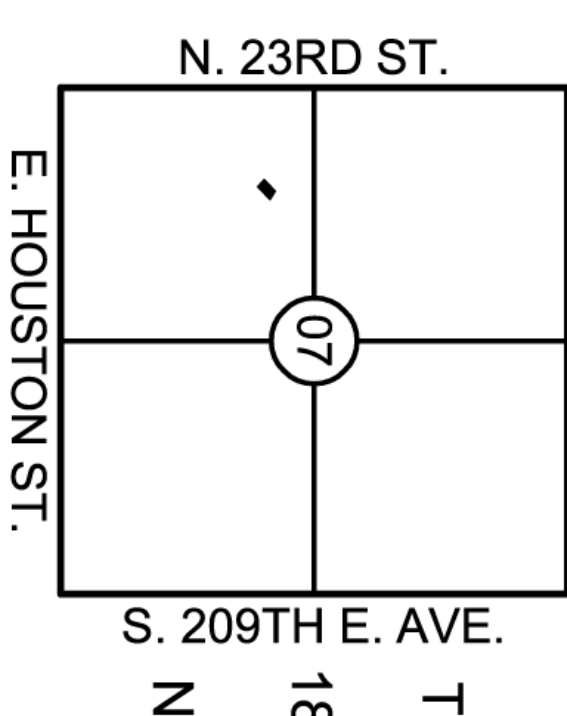

Location Map

SCALE: 1"=2000'

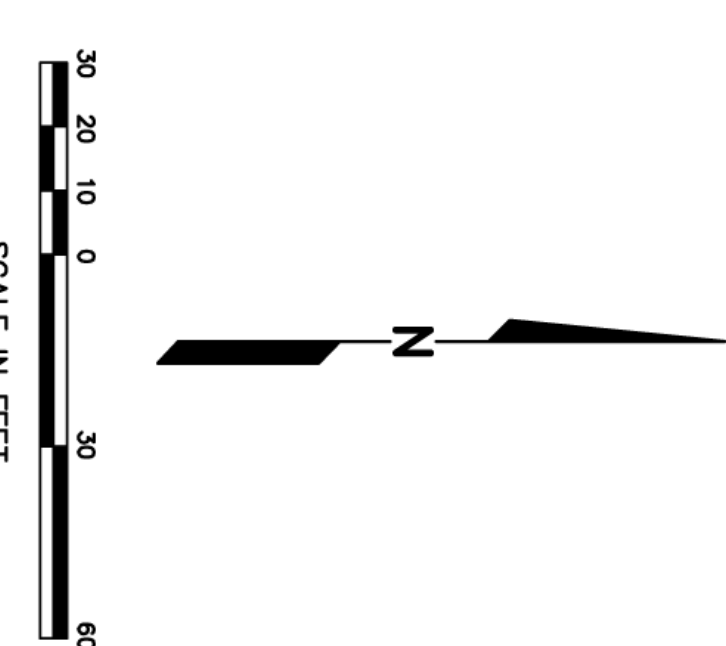

CAVEAT/DISCLAIMER: ADDRESSES SHOWN ON THIS PLAT ARE ACCURATE AT THE TIME THE PLAT WAS FILED...

DOC'S CONTAINER STORAGE A REPLAT OF LOT 1, BLOCK 2, COUCH ADDITION WAGONER COUNTY, STATE OF OKLAHOMA

ENGINEER: Sanders Engineering, Inc. 11502 S. 66th E. Ave. Bixby, Oklahoma 74008

SURVEYOR: Atlas Land Office Randy Bradley, L.S.

Wagoner, Oklahoma 74467 Phone: (918) 485-9987 email: randy@atlaslandoffice.com

DEED OF DEDICATION KNOW ALL MEN BY THESE PRESENTS

THAT WILLIAM D. PRUITT, JR., HEREINAFTER REFERRED TO AS "THE OWNER", IS THE OWNER OF THE PROPERTY DESCRIBED AND LOCATED IN THE CITY OF BROKEN ARROW, TULSA COUNTY, STATE OF OKLAHOMA, TO-WIT:

SECTION I. STREETS, EASEMENTS AND UTILITIES

A. PUBLIC STREETS AND GENERAL UTILITY EASEMENTS THE OWNER DOES HEREBY DEDICATE FOR PUBLIC USE THE UTILITY EASEMENTS AS DEPICTED ON THE ACCOMPANYING PLAT AS "U/E" OR "UTILITY EASEMENT" FOR THE SEVERAL PURPOSES OF CONSTRUCTING, MAINTAINING, OPERATING, REPAIRING, REPLACING, AND/OR

SECTION II. PLANNED UNIT DEVELOPMENT RESTRICTIONS

WHEREAS DOC'S CONTAINER STORAGE WAS SUBMITTED TO SECTION 6.4 OF THE ZONING ORDINANCE OF THE CITY OF BROKEN ARROW, OKLAHOMA;

SECTION III. ENFORCEMENT, DURATION, AMENDMENT AND SEVERABILITY

A. ENFORCEMENT THE RESTRICTIONS HEREIN SET FORTH SHALL RUN WITH THE LAND AND SHALL BE BINDING UPON THE OWNER, ITS SUCCESSORS AND ASSIGNS. WITHIN THE PROVISIONS AND COVENANTS WHICH SHALL BE COVENANTS RUNNING WITH THE LAND AND SHALL BE BINDING UPON THE OWNER, ITS SUCCESSORS IN TITLE AND SHALL BE ENFORCEABLE AS HERINAFTER SET FORTH.

NOTARY PUBLIC MY COMMISSION EXPIRES:

STATE OF OKLAHOMA) COUNTY OF TULSA )

APPROVED by the City Council of the City of Broken Arrow, Oklahoma.

1. I hereby certify that all real estate taxes levied on this plat have been paid as reflected by the current tax rolls.

By: Denise Scarpier, Tulsa County Treasurer