

# EXHIBIT A

9th Street (Lynn Lane) (177th E. Ave.)

N01°13'08"W 2638.60'  
WEST LINE OF THE SW4  
24.75' STATUTORY RIGHT OF WAY

W4c Sec 12

N88°46'18"E 641.67'  
NORTH LINE OF THE SW4

30ft Sanitary Sewer  
Easement  
City of Broken Arrow  
Bk 3890 Pg 1895

N88°46'18"E  
102.41'

Point of  
Beginning

45ft San. Sew. Ease.  
City of Broken Arrow  
Bk 4821 Pg 0077

Parcel # 44210  
Lois Maxine Dark Trust  
Bk 7234 Pg 0334  
N/A

100' Temporary Easement  
156284 Square Feet  
3.5878 Acres

30ft Sanitary Sewer  
Easement  
City of Broken Arrow  
Bk 3883 Pg 0075, 77, 78, 82

276.58'  
N72°02'24"E

388.02'  
N04°22'22"E

S04°22'22"W  
449.21'

S11°12'57"W  
288.56'

S72°02'24"W  
303.17'

346.74'  
N28°00'12"E

300.00'  
S28°00'12"W

96.85'  
N20°47'21"E

393.76'  
N01°13'08"W

260.89'  
S10°17'11"W

50ft Sanitary Sewer  
Easement  
City of Broken Arrow  
Doc 2009030750



0 100 200

Scale 1 Inch / 200 Feet

Bearings OK State Plane North Grid

## LEGAL DESCRIPTION:

A tract of land that is a part of the Southwest Quarter (SW4) of Section Twelve (12), Township Seventeen North (T17N), Range Fourteen East (R14E) of the Indian Meridian, Tulsa County, Oklahoma, more particularly described as follows;  
Point of Beginning on the North line of the Southwest Quarter of Section 12, a distance of 641.67 feet from the West Quarter corner of Section 12; Thence along the North line of the Southwest Quarter, N88°46'18"E a distance of 102.41 feet;  
Thence S11°12'57"W a distance of 288.56 feet;  
Thence S04°22'22"W a distance of 449.21 feet;  
Thence S72°02'24"W a distance of 303.17 feet;  
Thence S28°00'12"W a distance of 300.00 feet;  
Thence S20°47'21"W a distance of 199.08 feet;  
Thence S10°17'11"W a distance of 260.89 feet to a point on the East line of a 50' sanitary sewer easement filed as Doc #2009030750 at the office of the Tulsa County Clerk;  
Thence along the East line of said sanitary sewer easement, being parallel and 74.75 from the West line of said Southwest Quarter of Section 12, N01°13'08"W a distance of 393.76 feet;  
Thence N20°47'21"E a distance of 96.85 feet;  
Thence N28°00'12"E a distance of 346.74 feet;  
Thence N72°02'24"E a distance of 276.58 feet;  
Thence N04°22'22"E a distance of 388.02 feet;  
Thence N11°12'44"E a distance of 272.60 feet to the Point of Beginning.

1.A Temp. Ease. Gross area 156284 sq.ft. or 3.5878 acres  
Existing Permanent Easement 45867 sq.ft. or 1.0530 acres  
**1.A Temp. Ease. Net area 110417 sq.ft. or 2.5348 acres**

Bearing Based on the Oklahoma State Plane Zone North Grid

This legal description meets the minimum technical standards for legal descriptions in the State of Oklahoma.  
Prepared by Russell M. Muzika,  
Oklahoma PLS No. 1603

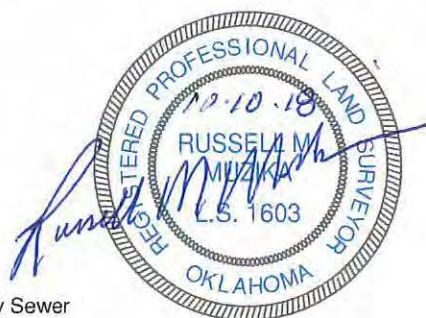

GEODECA LLC  
P.O.Box 330281,  
Tulsa, Ok. 74133  
918 949 4064  
CA # 5524 exp 6/30/20

PARCEL 1.A	
TEMPORARY EASEMENT	
Net Area: 110417 Sq. Ft. or 2.5348 Acres	
Owner: DARK, LOIS MAXINE TRUST	
Address: Unknown	
Revision: 1	Date: October 10 2018