



**PARCEL 24**  
**OWNER: THE BOARD OF EDUCATION OF SCHOOL DISTRICT NO. 3**  
**OF THE CITY OF BROKEN ARROW**  
**REAL PROPERTY LEGAL DESCRIPTION**

A TRACT OF LAND THAT IS PART OF THE EAST HALF (E/2) OF SECTION ELEVEN (11), TOWNSHIP EIGHTEEN (18) NORTH, RANGE FOURTEEN (14) EAST OF THE INDIAN BASE AND MERIDIAN, TULSA COUNTY, STATE OF OKLAHOMA, ACCORDING TO THE U.S. GOVERNMENT SURVEY THEREOF, SAID TRACT OF LAND BEING DESCRIBED AS FOLLOWS:

COMMENCING AT THE SOUTHEAST CORNER OF THE NE/4 SE/4; THENCE NORTH 01°10'07" WEST ALONG THE EASTERLY LINE OF SAID NE/4 SE/4 FOR 576.00 FEET; THENCE SOUTH 88°32'24" WEST PARALLEL WITH THE SOUTHERLY LINE OF SAID NE/4 SE/4 FOR 24.75 FEET TO THE POINT OF BEGINNING OF SAID TRACT OF LAND; THENCE CONTINUING SOUTH 88°32'24" WEST PARALLEL WITH SAID SOUTHERLY LINE FOR 13.25 FEET; THENCE NORTH 01°10'07" WEST PARALLEL WITH SAID EASTERLY LINE FOR 477.70 FEET; THENCE SOUTH 88°33'47" WEST FOR 12.00 FEET; THENCE NORTH 01°10'07" WEST PARALLEL WITH SAID EASTERLY LINE FOR 267.00 FEET TO A POINT ON THE NORTHERLY LINE OF SAID NE/4 SE/4; THENCE NORTH 01°14'53" WEST PARALLEL WITH THE EASTERLY LINE OF THE SE/4 NE/4 FOR 203.98 FEET; THENCE SOUTH 88°36'03" WEST FOR 74.92 FEET; THENCE NORTH 01°14'53" WEST PARALLEL WITH SAID EASTERLY LINE FOR 35.00 FEET TO A POINT ON THE SOUTHERLY RIGHT-OF-WAY LINE OF EAST DETROIT STREET; THENCE NORTH 88°36'03" EAST ALONG SAID SOUTHERLY RIGHT-OF-WAY LINE FOR 99.92 FEET; THENCE SOUTH 01°14'54" EAST PARALLEL WITH AND 25.00 FEET WESTERLY OF SAID EASTERLY LINE FOR 238.96 FEET TO A POINT ON THE SOUTHERLY LINE OF SAID SE/4 NE/4; THENCE NORTH 88°33'47" EAST ALONG SAID SOUTHERLY LINE FOR 0.25 FEET; THENCE SOUTH 01°10'07" EAST PARALLEL WITH AND 24.75 FEET WESTERLY OF THE EASTERLY LINE OF SAID NE/4 SE/4 FOR 744.70 FEET TO THE POINT OF BEGINNING OF SAID TRACT OF LAND.

THE ABOVE DESCRIBED TRACT OF LAND CONTAINING 21,698 SQUARE FEET OR 0.498 ACRES, MORE OR LESS.

**REAL PROPERTY CERTIFICATION**

I, DEAN ROBINSON, OF SISEMORE WEISZ & ASSOCIATES, CERTIFY THAT THE ATTACHED LEGAL DESCRIPTION CLOSES IN ACCORD WITH EXISTING RECORDS, IS A TRUE REPRESENTATION OF THE REAL PROPERTY AS DESCRIBED, AND MEETS THE MINIMUM TECHNICAL STANDARDS FOR LAND SURVEYING OF THE STATE OF OKLAHOMA.

1/8/13  
DATE

SISEMORE WEISZ & ASSOCIATES, INC  
BY DEAN ROBINSON  
DEAN ROBINSON  
PLS N 1016 STATE OF OKLAHOMA  
C. A. N  
EXPIRES: 6/30/15

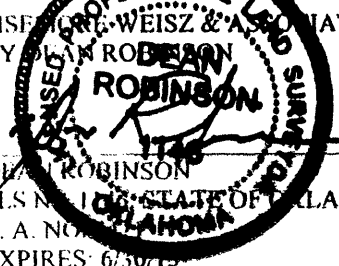

## Parcel 24

### Parcel Map Check Report

Date: 12/18/2013 11:01:48 AM

Parcel Name: PARCEL 24

North: 390,334.9074'

East: 2,624,784.2203'

Segment# 1: Line

Course: S88° 32' 24"W

Length: 13.250'

North: 390,334.5698'

East: 2,624,770.9746'

Segment# 2: Line

Course: N1° 10' 07"W

Length: 477.702'

North: 390,812.1724'

East: 2,624,761.2320'

Segment# 3: Line

Course: S88° 33' 47"W

Length: 12.000'

North: 390,811.8715'

East: 2,624,749.2358'

Segment# 4: Line

Course: N1° 10' 07"W

Length: 267.003'

North: 391,078.8189'

East: 2,624,743.7904'

Segment# 5: Line

Course: N1° 14' 53"W

Length: 203.978'

North: 391,282.7486'

East: 2,624,739.3475'

Segment# 6: Line

Course: S88° 36' 03"W

Length: 74.921'

North: 391,280.9192'

East: 2,624,664.4489'

Segment# 7: Line

Course: N1° 14' 53"W

Length: 35.000'

North: 391,315.9109'

East: 2,624,663.6865'

Segment# 8: Line

Course: N88° 36' 03"E

Length: 99.921'

W:\16720.04\Parcel 24.doc  
01/08/13 agm

City of Broken Arrow  
P.O. Box 610  
Broken Arrow, OK 74013

North: 391,318.3507'

East: 2,624,763.5778'

Segment# 9: Line

Course: S1° 14' 53"E

Length: 238.961'

North: 391,079.4464'

East: 2,624,768.7826'

Segment# 10: Line

Course: N88° 45' 07"E

Length: 0.250'

North: 391,079.4518'

East: 2,624,769.0325'

Segment# 11: Line

Course: S1° 10' 07"E

Length: 744.699'

North: 390,334.9077'

East: 2,624,784.2204'

Perimeter: 2,167.686'

Area: 21,667.82Sq.Ft.

Error Closure: 0.0004

Course: N10° 50' 39"E

Error North : 0.00036

East: 0.00007

Precision 1: 5,419,212.500

# Parcel Map

MATCHLINE

12.00'  
S 88°33'47" W

Unplatted

BOARD OF EDUCATION OF  
SCHOOL DISTRICT NO. 3 OF  
THE CITY OF BROKEN ARROW

Parcel 24

N 1°10'07" W  
477.70'

744.70'  
S 1°10'07" E

24.75' STATUTORY R/W

PROPOSED R/W

PROPERTY LINE

PROPERTY LINE

PRESENT R/W

EAST LINE SECTION 11

576.00'  
N 1°10'07" W

North 9th Street

SE CORNER  
NE/4 SE/4  
P.O.C.-PARCEL 24

24.75' STATUTORY R/W

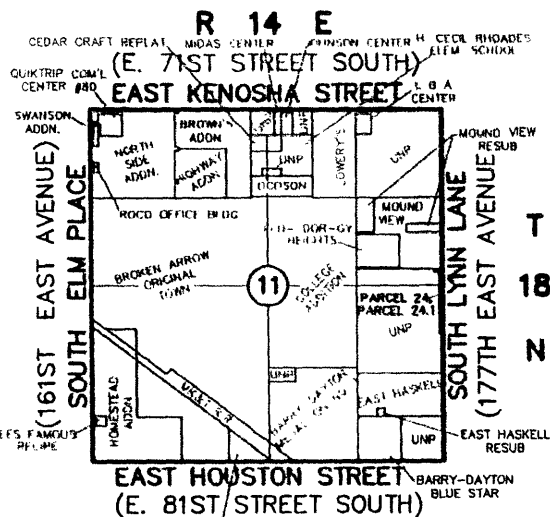

## Location Map

SCALE: NOT TO SCALE



SCALE 1"=100'

P.O.B. - POINT OF BEGINNING  
P.O.C. - POINT OF COMMENCEMENT  
R/W - RIGHT-OF-WAY

TOTAL PROPERTY - 24.82 ACRES (TAX RECORDS)  
PERMANENT R/W - 0.498 ACRES

DATE: 12/10/2013  
SHEET 2 OF 3



Sisemore Weisz & Associates, Inc.

611 EAST 32nd PLACE  
TULSA, OKLAHOMA 74135  
C.A. NO. 2421  
W.O. NO. 16720.04

PHONE (918) 665-3600  
FAX: (918) 665-9669  
EXP. DATE 6/30/15  
FILE NO. 1814.1100

City of Broken Arrow  
P.O. Box 610  
Broken Arrow, OK 74013

