

NEW ORLEANS STREET AND ELM PLACE INTERSECTION SCHEMES

**NEW ORLEANS STREET AND ELM PLACE
INTERSECTION SCHEMES SUMMARY**

Option	Pattern Type	Color of Emblem	Color of Border	Number of Placements	Not to Exceed Cost
A	Warm Tone	Beige	N\A	4	No Change
B	Cool Tone	Gray	N\A	4	No Change
1	Cool Tone	Blue	White	1	\$230,000
2	Cool Tone	Blue	Beige	1	\$125,000
3A\B	Warm or Cool	Blue	N\A	4	\$65,000

ORIGINAL CONSTRUCTION CONTRACT INTERSECTION SCHEMES

AS-BID COLOR SCHEME

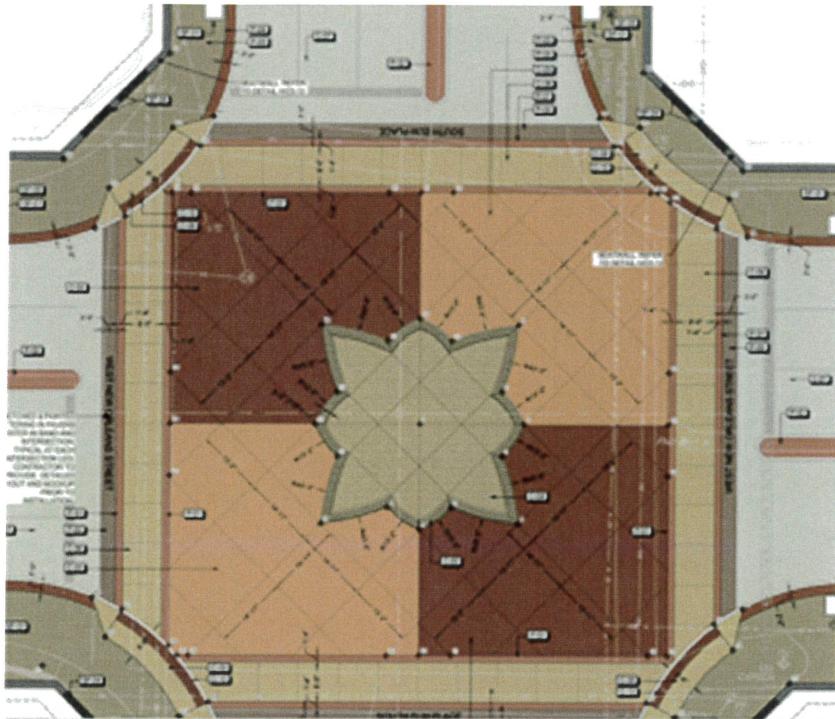

(A) **WARM TONE CONCEPT**

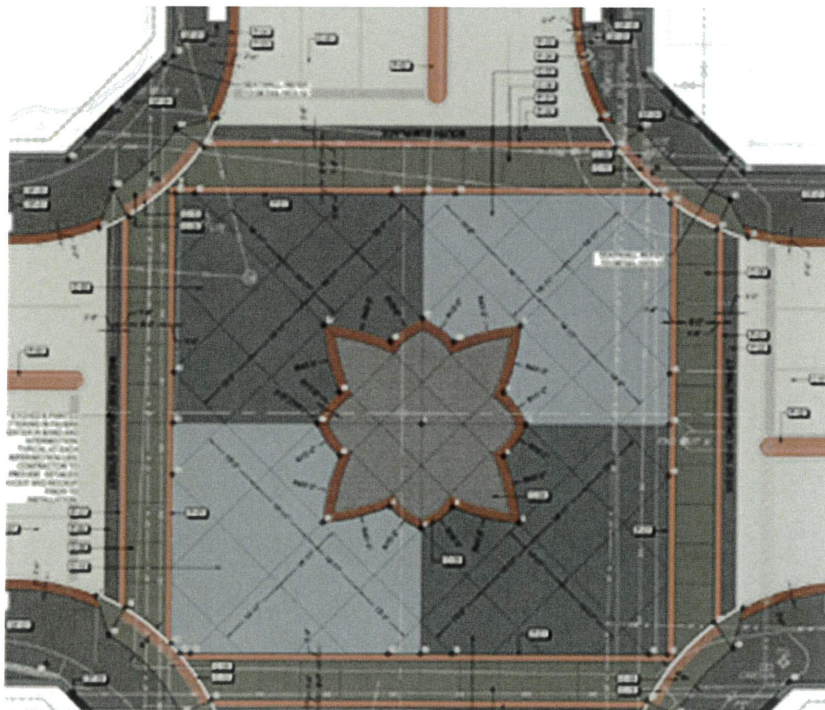

(B) **COOL TONE CONCEPT**
EQUIVALENT COST COLOR
SCHEME

POTENTIAL ALTERNATE INTERSECTION SCHEMES

ADDITIONAL COLOR SCHEME 1
 BLUE MEDALLION, WHITE CENTER RECTANGLE, WHITE
 CROSSWALKS, WHITE BORDERS SURROUNDING CROSSWALKS

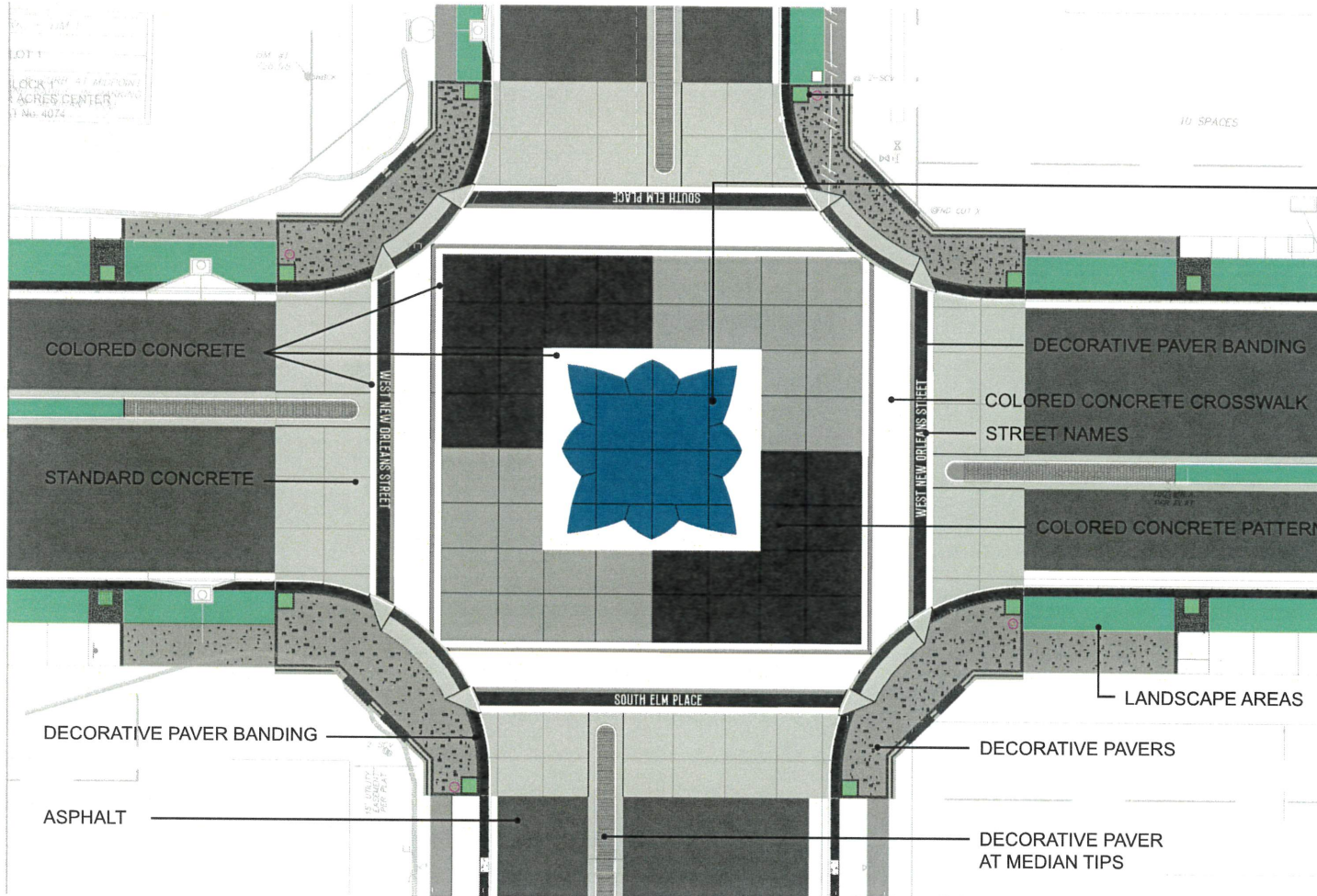

● (660) POOL BLUE

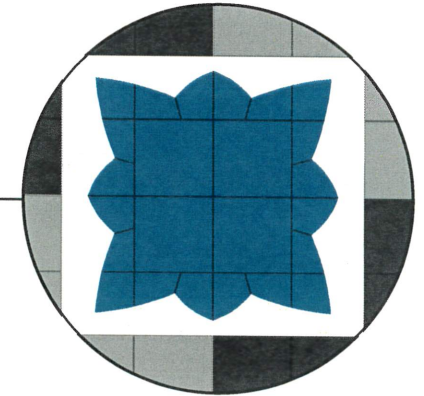

○ WHITE

● (100) DARK GRAY

● (615) STONE GRAY

**Not to Exceed Additional:
 \$230,000**

NEW ORLEANS SQUARE

BROKEN ARROW, OK

INTERSECTION COLOR PALETTE

THIS GRAPHIC IS CONCEPTUAL. THE INFORMATION SHOWN IS BASED ON THE
 BEST INFORMATION AVAILABLE AND IS SUBJECT TO CHANGE WITHOUT NOTICE.

Kimley»Horn

JUNE 2022

ADDITIONAL COLOR SCHEME 2

BLUE MEDALLION, BEIGE CENTER RECTANGLE, BEIGE
CROSSWALKS, BEIGE BORDERS SURROUNDING CROSSWALKS

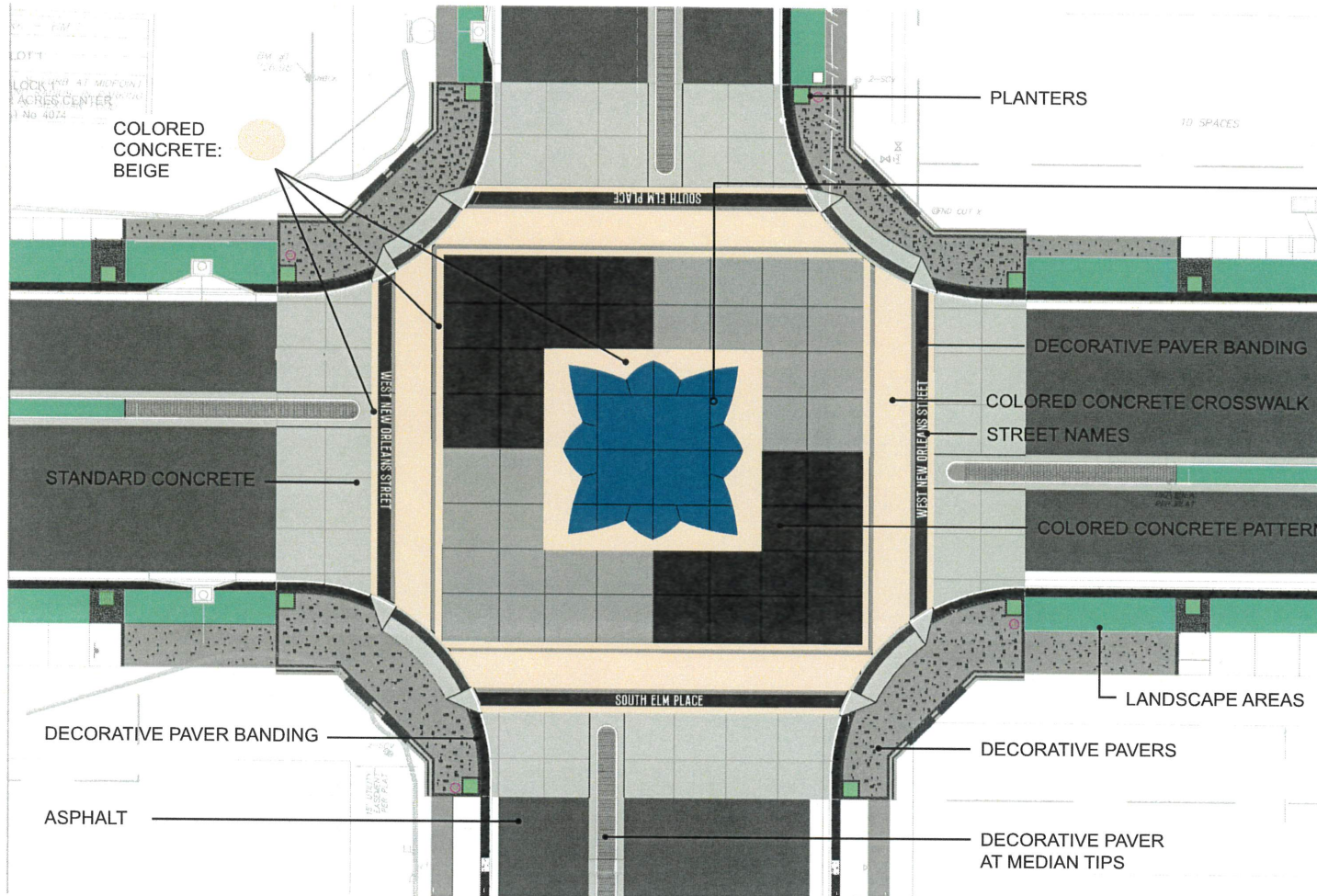

(660) POOL BLUE

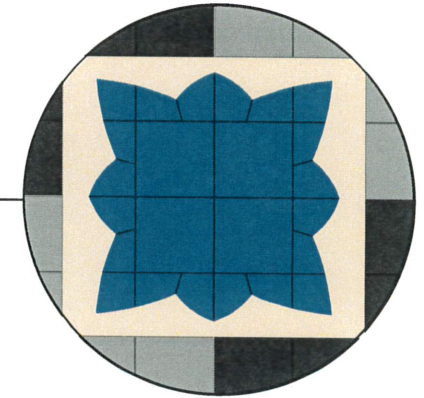

BEIGE

(100) DARK GRAY

(615) STONE GRAY

Not to Exceed Additional:
\$125,000

NEW ORLEANS SQUARE

BROKEN ARROW, OK

INTERSECTION COLOR PALETTE

THIS GRAPHIC IS CONCEPTUAL. THE INFORMATION SHOWN IS BASED ON THE
BEST INFORMATION AVAILABLE AND IS SUBJECT TO CHANGE WITHOUT NOTICE.

Kimley»Horn

JUNE 2022

ADDITIONAL COLOR SCHEME 3

WARM TONE CONCEPT W/ POOL BLUE MEDALLION
or COOL TONE CONCEPT W/ POOL BLUE MEDALLION

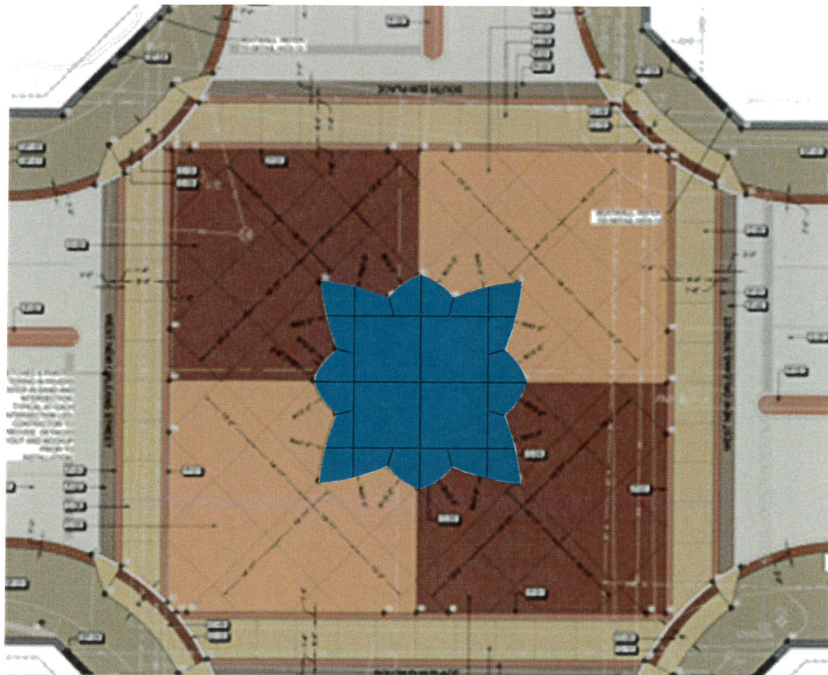

(A) **WARM TONE CONCEPT**

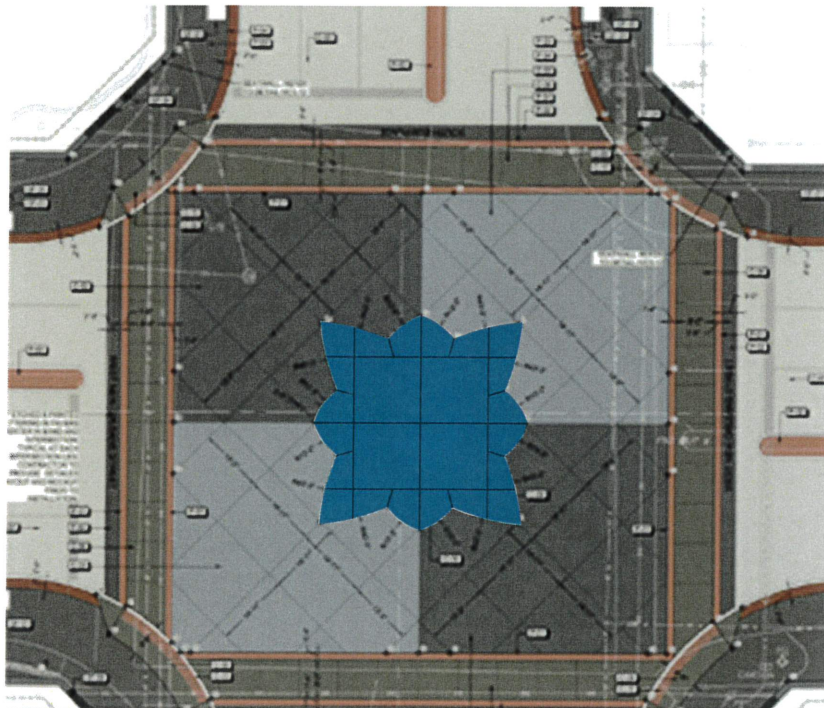

(B) **COOL TONE CONCEPT**

Not to Exceed Additional:
\$65,000