

**Contract Change Order # 1**

---

Project Name: LLWWTP Maintenance Building Addition Project Number: 165415

Project Location: Lynn Lane WWTP Date of Application: Monday, January 23, 2017

Contractor: Builders Unlimited Submitted By: Eldon Fenderson

---

**Summary of Change in Scope of Work**

The following scope of work consisting of work location, work description, established quantities, and timeline for completion has been reviewed and agreed upon by the contractor, the origin funding department, and the Engineering and Construction Department.

**Change of Work Items Included in this Change Order:**

- Revisions to electrical connection to existing power supply. Due to conflicts in performing original plans for electrical tie-in, the contractor is directed to install a 125amp breaker in the existing 400amp panel in lieu of the proposed 200amp disconnect.
- 1) Due to conflicts and revisions to the installation of the water service to the new maintenance building through the sludge transfer bays, the contractor is to install the service according to the directions described in the attached TFI #2. The below costs include all materials, labor, P&OH.
- 2)

**Change in Contractual Project Time:**

- 1) No additional time allotted for this efforts
- 2) Additional time due to project delays - 67 days resulting in a revised contract time of 187 calendar days

Plan Sheets or Additional Documents Attached:  Yes  No  Other: \_\_\_\_\_

**Work Order Quantities**

Item#	(Spec)	Item Description	Units	Price	Quantity	Total Amount
CO1-1	NA	Electrical Connection Changes	LS	\$ 834.00	1	\$ 834.00
CO1-2	NA	Waterline Connection Change	LS	\$ 1,529.00	1	\$ 1,529.00
						\$ -
Total Change Cost:						\$ 2,363.00

**Summary of Project Costs**

Total Previous Change Orders:	\$ -	Original Contract Amount:	\$ 258,252.00
Current Change Order:	\$ 2,363.00	Amended Contract Amount:	\$ 260,615.00
Total Cost of Change Orders:	\$ 2,363.00	Percent Change in Contract:	0.91%
Total Cost Applicable to CBA:	\$ 2,363.00	Percent Change Applicable to CBA:	0.91%

**Change Order Authorization**

Change Order # 1 in the sum of: \$ 2,363.00 has been reviewed by all parties and is recommended for approval by:

Contractor Submitting Change Order:	<u>Steve Wright</u> Name	<u>SA Belf</u> Signature	<u>3-1-17</u> Date
Construction Division Manager:	<u>Timothy S Robins, PE</u> Name	<u>[Signature]</u> Signature	<u>3/2/17</u> Date
Director of Engineering & Construction:	<u>Alex Mills, PE</u> Name	<u>[Signature]</u> Signature	<u>3/2/17</u> Date
Assistant City Manager - Operations:	<u>Kenneth D Schwab, PE</u> Name	<u>Kenneth D. Schwab</u> Signature	<u>3/4/17</u> Date
City Manager:	<u>Michael Spurgeon</u> Name	<u>Michael Spurgeon</u> Signature	<u>3/6/17</u> Date

**This Change is Executed Through:**

- This change to the contract documents is authorized by the City Manager's authority in accordance with the applicable state statutes and COBA Code of Ordinances.  
or
- This change to the contract documents was approved at the City Council/BAMA meeting held on : \_\_\_\_\_

**Builder's Unlimited, Inc.**

4677 S 83rd E Ave  
Tulsa, OK 74145-6901  
Ph : (918) 835-1138

**RFI**

**To:** Timothy Robins  
City of Broken Arrow  
485 N. Poplar Ave  
PO Box 610  
Broken Arrow, OK 74013-0610  
Ph: 918-259-7000 x7340 Fax: 918-259-8453

**RFI #: 2**  
**Date:** 9/14/2016  
**Job:** 16-011 Lynn Lane WWTP  
**Phone:**

**CC:** David Myers (City of Broken Arrow), Chase Feters Hewitt Architect, Chase Feters Hewitt Architect

**Subject:** BA WWTP Plumbing Rough In

**Drawing:** M 1.1  
**Cost Impact:** None

**Spec Section:**  
**Schedule Impact:** None

**Request:** **Date Required:** 9/15/2016  
We would request that the 1 1/4 inch water line be routed overhead and insulated after the installation of the shut off valve at the tap. This will not interfere with the monolythic slab and footings and reinforcing steel. All other aspects will remain the same. It will be supported from the new building structure and be insulated.

**Requested by:** Eldon Fenderson  
Builder's Unlimited Inc.

**Response:**

The above purposed resolution is rejected, however please see attached for an alternate method of installation. After reviewing the existing building foundations and bearing material, COBA does not want to disturb the bearing material supporting the existing building. The existing waterline inside the building is to be excavated such to accommodate a drivable valve box to allow for a transition through the top of the stem wall footing. The hose connection and vertical piping shall be removed and not reinstalled. See attached plans for further clarifications.

\_\_\_\_\_  
Answered by

\_\_\_\_\_  
Company

\_\_\_\_\_  
Date



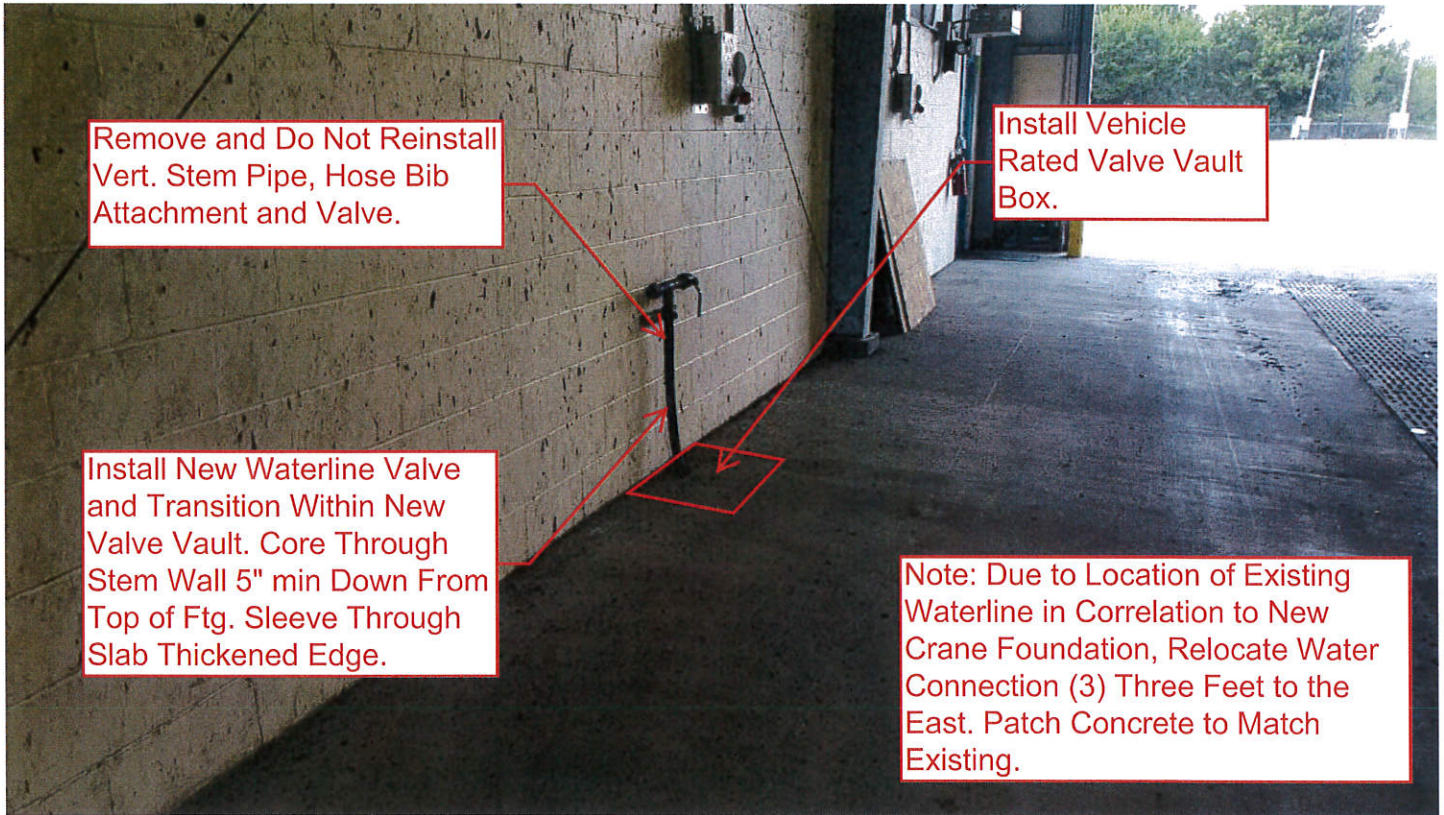



# 12" x 12" BOX ASSEMBLY

## 12" & 24" DEPTHS



**POLYMER CONCRETE**

**ARMORCAST PRODUCTS COMPANY**

A6001423

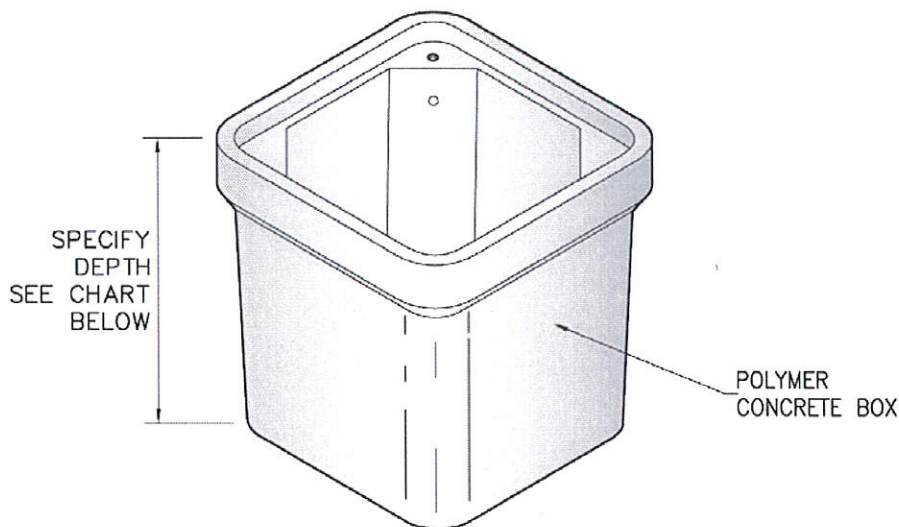
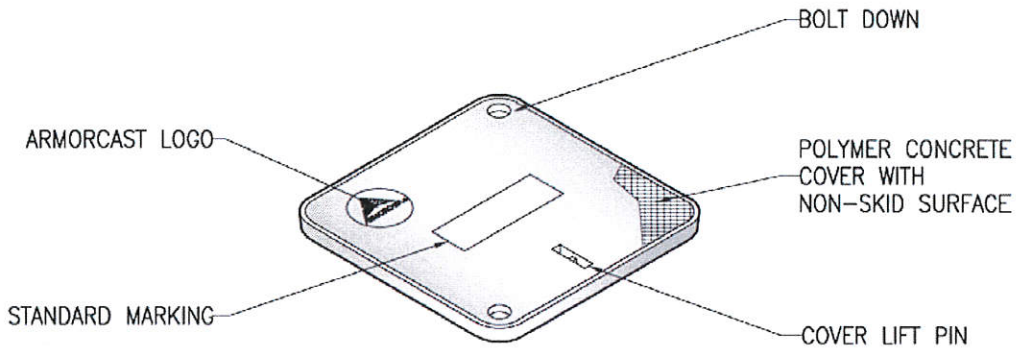

**POLYMER CONCRETE BOXES**

### 12"W x 12"L BOX ASSEMBLIES Specify Depth Below

DESCRIPTION	NOMINAL SIZE W x L x D	LOAD RATING	ANSI TIER	PART NUMBER	APPROX. WEIGHT	PALLET QTY.
Box & Cover Assembly	12" x 12" x 12"	10K	8	A6001423A	42 lbs.	27
	12" x 12" x 12"	20K	15 / 22	A6001423TA / A6001423HD	46 lbs.	27
Box & Cover Assembly	12" x 12" x 24"	10K	8	A6001423AX24	72 lbs.	9
	12" x 12" x 24"	20K	15 / 22	A6001423TAX24 / A6001423HDAX24	76 lbs.	9

### COMPONENTS

MORE COVER VARIATIONS ARE AVAILABLE IN OUR "COVER SECTION"

DESCRIPTION	NOMINAL SIZE W x L x D	LOAD RATING	ANSI TIER	PART NUMBER	APPROX. WEIGHT	PALLET QTY.
Replacement Covers	12" x 12"	10K	8	A6001422	15 lbs.	50
	12" x 12"	20K	15	A6001422T	19 lbs.	50
Replacement Boxes	12" x 12" x 12"	10K / 20K	22	A6001423	27 lbs.	18
	12" x 12" x 24"	10K / 20K	22	A6001423X24	57 lbs.	9

- Boxes are Open Bottom and Stackable, also available with Solid Bottoms.
- For sizes not shown please contact Armorcast Products for more information.

THIS PRODUCT IS LISTED TO APPLICABLE UL STANDARDS AND REQUIREMENTS BY UL.

[www.armorcastprod.com](http://www.armorcastprod.com)

Tel: (818) 982-3600 Fax: (818) 982-7742



ARMORCAST PRODUCTS COMPANY

# 12" x 12" BOX ASSEMBLY

## STANDARD DIMENSIONS

POLYMER CONCRETE

A6001423



LISTED

FILE #E364252

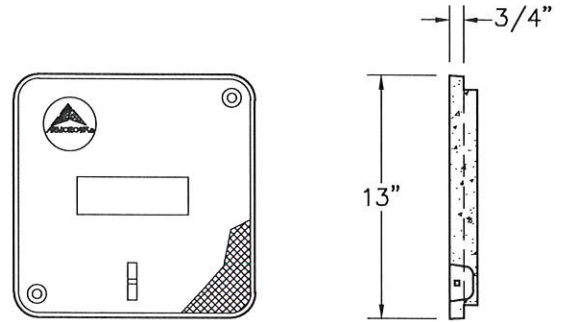
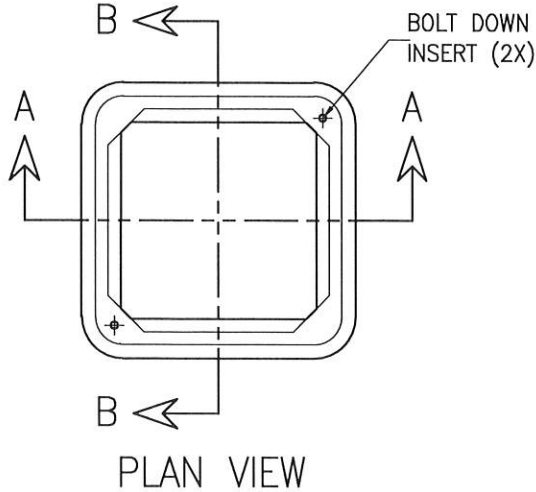

POLYMER CONCRETE COVER

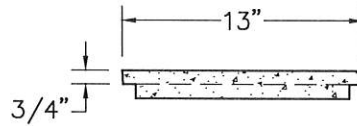

POLYMER CONCRETE  
BOXES

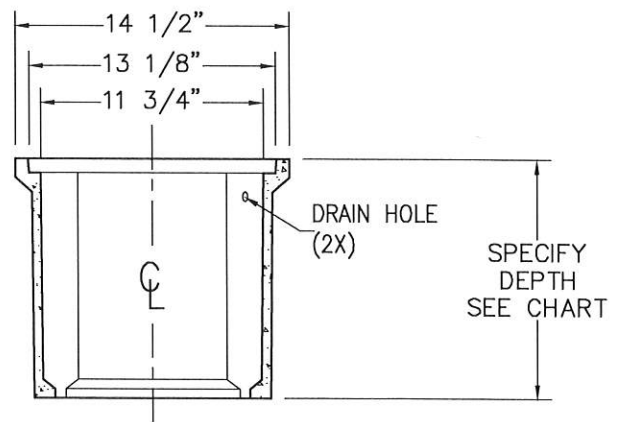
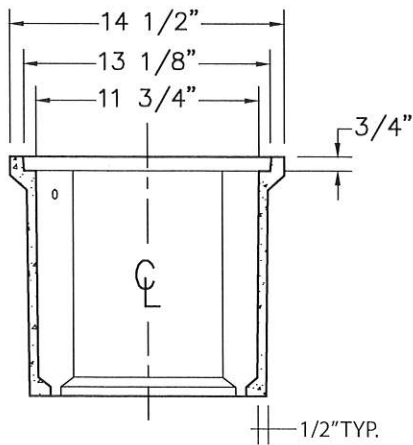

Armorcast Products Company reserves the right to update or discontinue product information at any time without notice.

THIS PRODUCT IS LISTED TO APPLICABLE UL STANDARDS AND REQUIREMENTS BY UL.

[www.armorcastprod.com](http://www.armorcastprod.com)

Tel: (818) 982-3600 Fax: (818) 982-7742

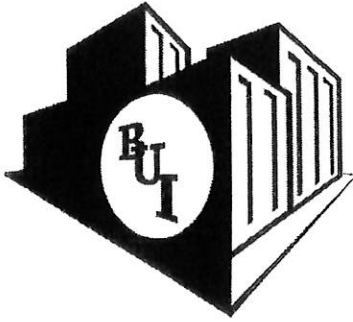

**BUILDERS UNLIMITED, INC.**  
**GENERAL CONTRACTOR**

2/27/17

Broken Arrow Municipal Authority

**INVOICE**

Billing for additional work for Contract No. 165415 for LLWWTP Maintenance Building Addition. Scope of work is attached in original proposals. We are complete with this project but have not received actual Change Orders to include in our final billing.

Adding Concrete Vault or Box Cost	\$1,529.00
Electrical Service	\$834.00
<b>TOTAL</b>	<b>\$2,363.00</b>

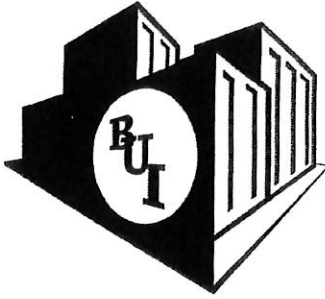

**BUILDERS UNLIMITED, INC.**  
**GENERAL CONTRACTOR**

February 10, 2017

Mr. Timothy Robins, P. E., CWI  
Construction Manager  
Engineering & Construction Dept.  
City Of Broken Arrow  
Broken Arrow, OK 74013-0610

RE: Lynn Lane WWTP

Dear Mr. Robins,

We apparently still have a couple of unresolved issues at the Lynn Lane Building Addition.

On September 21, 2016, I responded to the City's response to RFI No 2 in which the City of BA requested we revise the plumbing service into the new addition by adding a concrete vault or box assembly below grade and core drilling the concrete footing for the service. Our cost for this work was \$1,529.00. This work was performed as directed.

We have performed additional work on the electrical service per my letter of Oct 10, in the amount of \$834.00. We were told this was accepted.

I am therefore requesting that we be issued a change order to our contract for these two items.

Sincerely,

Builders Unlimited Inc.

Eldon Fenderson  
Project Manager

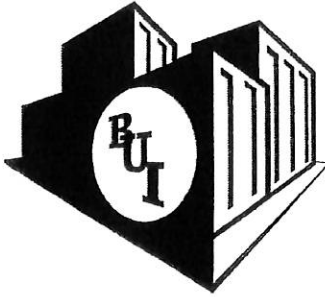

**BUILDERS UNLIMITED, INC.**  
**GENERAL CONTRACTOR**

September 21, 2016

Mr. Timothy Robins, P. E., CWI  
Construction Manager  
Engineering & Construction Dept.  
City Of Broken Arrow  
Broken Arrow, OK 74013-0610

RE: Lynn Lane WWTP Plumbing Revision

Dear Mr. Robins,

Mechanical Plan Sheet M-1.1 dictates how to route the plumbing for this project. It indicates that we are to "connect the new 1 1/4" cold water to the existing 2" cold water piping and provide a shut off at the top". It then shows the new 1 1/4" extending underground and stub up and provide a shut off valve in the location of the new restroom.

The City's response to RFI No.2 now requests the demolition of the existing above ground piping and the installation of a 12 x 12 box assembly, core drilling the concrete, and installing the shut off valve in the box. The additional cost for this revision is as follows:

Plumbing:	\$1,369.50
GC OHP 10%	136.95
Additional Bond	<u>22.55</u>
TOTAL	\$1,529.00

Sincerely,

Builders Unlimited Inc.

Eldon Fenderson  
Project Manager



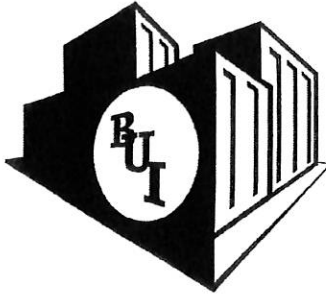

**BUILDERS UNLIMITED, INC.**  
**GENERAL CONTRACTOR**

October 10, 2016

Mr. Timothy Robins, P. E., CWI  
Construction Manager  
Engineering & Construction Dept.  
City Of Broken Arrow  
Broken Arrow, OK 74013-0610

RE: Lynn Lane WWTP Electrical Revision Per RFI 2 Response

Dear Mr. Robins,

The Electrical contractor has provided the following cost, both deductive and additive to delete the 200 amp disconnect and provide and install the 125 amp breaker for the new addition.

Deduct 200 Amp Disconnect	(\$ 1,403.00)
Add 125 Amp Breaker	<u>2,150.00</u>
Net Difference	747.00
OHP 10%	74.70
Bond	<u>12.30</u>
TOTAL	\$ 834.00

Sincerely,

Builders Unlimited Inc.

Eldon Fenderson  
Project Manager