

**SITE PLAN**

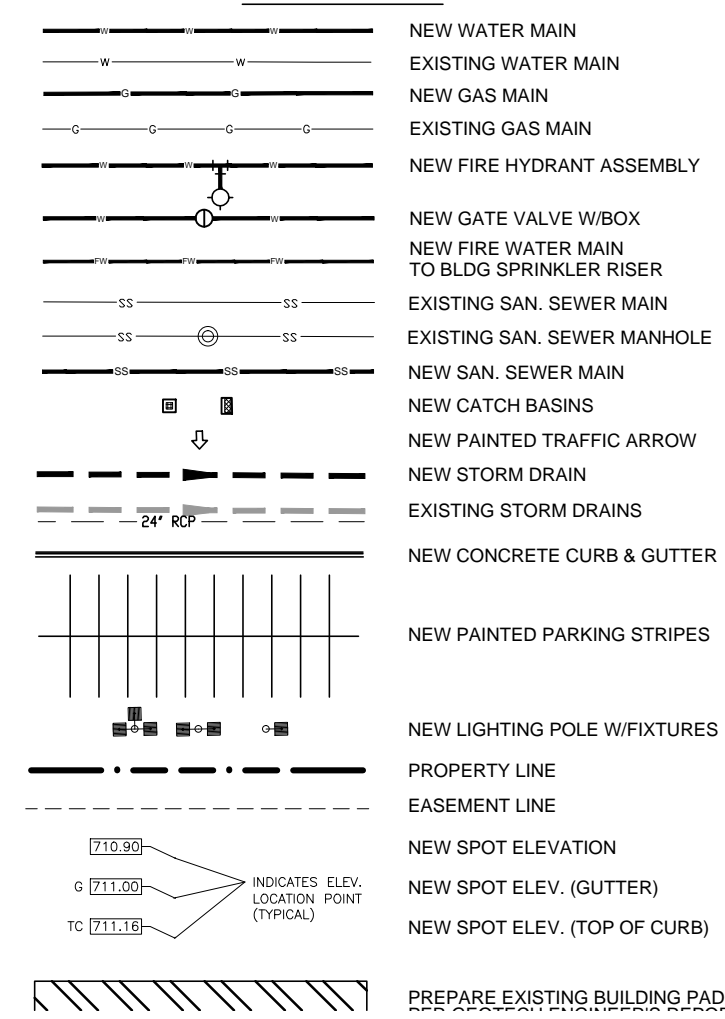

**LEGEND**



R 14 E

ALBANY (E. 61ST ST. S.)

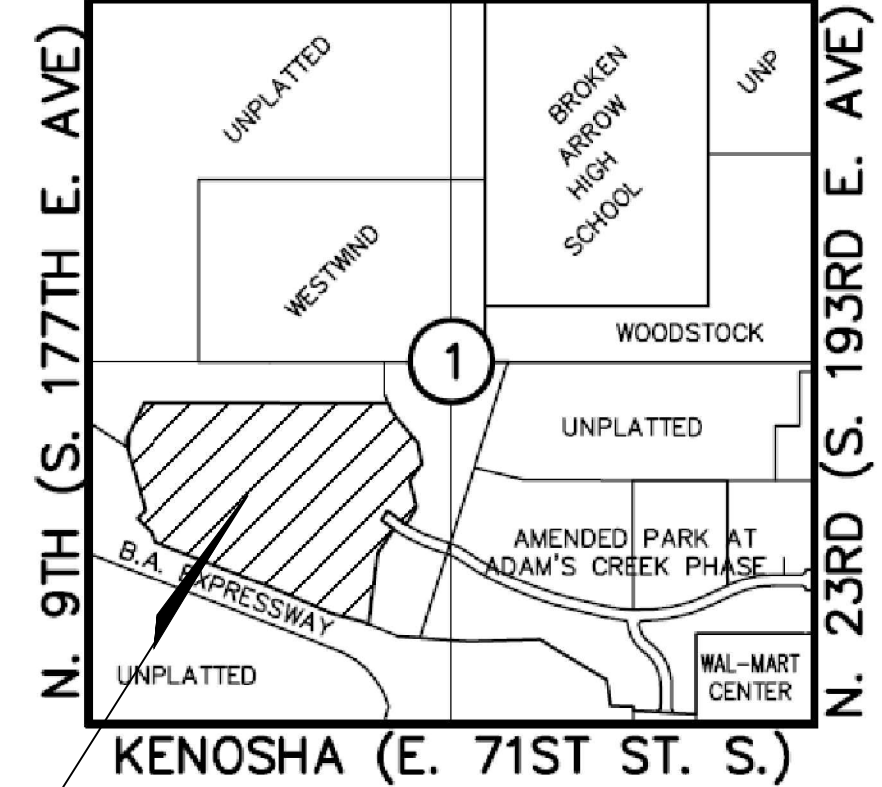

T 18 N

PROJECT LOCATION

**SITE DEVELOPMENT NO. XX-XXX**

THIS SITE IS COVERED BY STORM WATER DETENTION DETERMINATION NO. 81307-44

**ZONING ORDINANCE VERIFICATION**

EXISTING ZONING: CH  
 PROPOSED USE: RETAIL  
 FLOOR TO LOT AREA RATIO: 1 to 5.3  
 LOT COVERAGE: (sf of impervious area): 69.2% (264,290 sf)  
 BUILDING HEIGHT: 35' (max.)

**PARKING DATA**

TOTAL SPACES REQUIRED: 240 MIN.  
 TOTAL SPACES PROVIDED: 299  
 HANDICAP SPACES REQUIRED: 7\*  
 HANDICAP SPACES PROVIDED: 8

\* BASED ON TOTAL SPACES PROVIDED

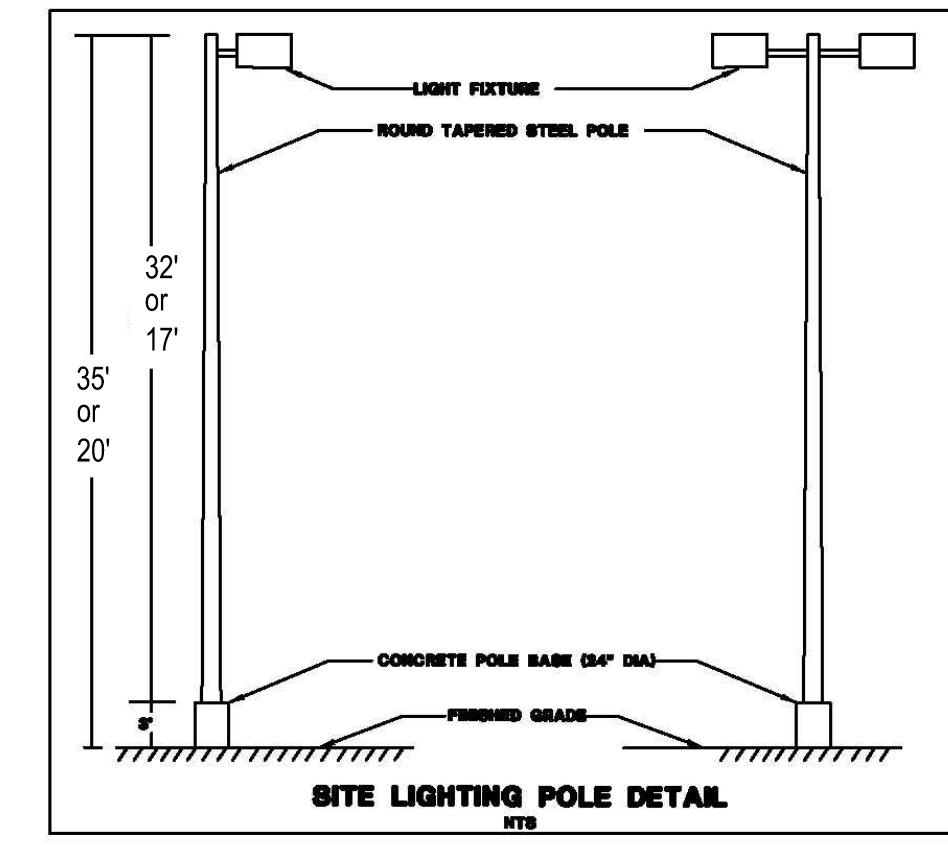
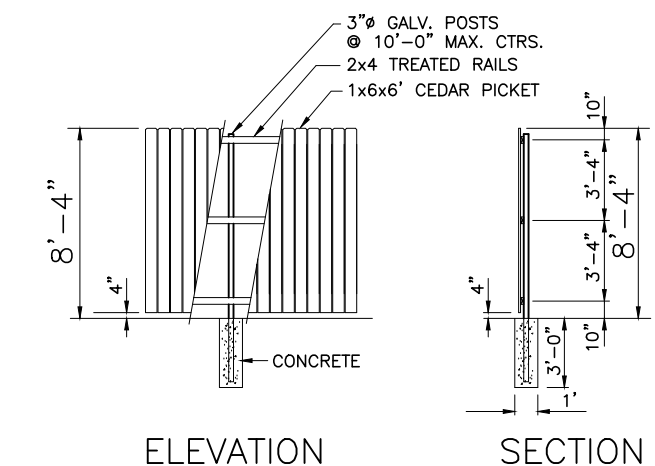

**LIST OF CONTACTS**

DEVELOPER: HANS KUHLMANN 303-623-0502  
 ROBERT CARLIN 214-458-4600  
 CIVIL ENGINEER: S.E. HUEY CO.  
 CHARLES TAYLOR 318-325-1791  
 HUNTER LANCASTER 318-325-1791  
 SURVEYOR: SISEMORE WEISZ AND ASSOCIATES  
 GREG WEISZ 918-665-3600  
 LANDSCAPE ARCHITECT: ALABACK DESIGN  
 DAN ALABACK 918-742-1467

**REFERENCES**

- SEE SEPARATE LANDSCAPE PLAN
- SEE SHOPS BUILDING PLAN FOR:
  - EXTERIOR ELEVATION
  - MASONRY USE
  - BUILDING HEIGHT
- SEE SEPARATE SITE LIGHTING PLANS FOR: COMPLETE SITE PHOTOMETRICS

CASE NO. \_\_\_\_\_  
 SITE DEVELOPMENT NO. XX-XXX  
 XXXX E. HILLSIDE DRIVE

**S. E. Huey Co.**  
 Engineering - Architecture - Surveying  
 1111 N. 19th ST. MONROE, LA. 70201 PH. 336-325-1791

DEVELOPERS:  
**Auburndale - Halifax Broken Arrow, LLC**  
 5485 BELLEVUE ROAD, SUITE 115  
 DALLAS, TX 75254  
 PHONE: (214) 528-4600

**THE SHOPS at BROKEN ARROW**  
 Phase 2 - Ulta, Ross, Michaels, Dollar Tree  
 NE QUAD. of BROKEN ARROW EXPRESSWAY (S.H. 51) and N. 9th STREET  
 BROKEN ARROW, OKLAHOMA

LICENSED PROFESSIONAL ENGINEER  
 E. HUNTER LANCASTER  
 22888  
 OKLAHOMA  
 10/17/16

JOB NO.	168479
DATE	SEPT. 2016
DRAWN BY	GLC
CHECKED BY	PCT
REVISIONS	

**SITE PLAN**  
 SHEET **SP1.0**