

EASE - 000-965-2023 10' UTILITY EASEMENT
 LOT 1, BLOCK 1, LYNN LANE TERRACE AMENDED
 CITY OF BROKEN ARROW, SECTION 2, TOWNSHIP 18 NORTH, RANGE 14 EAST, I.M.,
 TULSA COUNTY, OKLAHOMA

The undersigned Licensed Professional Land Surveyor hereby states that the above description closes in accord with existing records, is a true representation of the intended easements area as described, and meets the Minimum Standards for the Legal Descriptions, defined in the Minimum Standards for the Practice of Land Surveying as adopted by the Oklahoma State Board of Licensure for Professional Engineers and Land Surveyors.

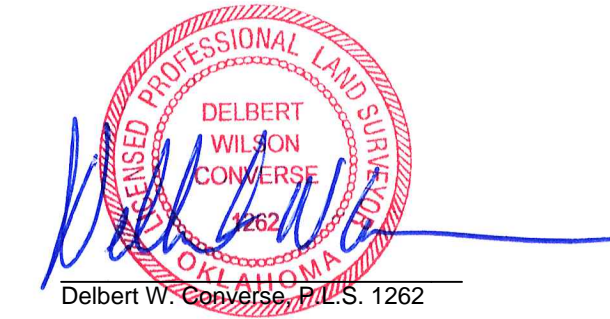

August 30, 2023
 Date of Certification

EXHIBIT A - LEGAL DESCRIPTION - EASE-000-965-2023 - 10 FOOT UTILITY EASEMENT

A 10 foot Utility Easement in Lot One (1), Block One (1), LYNN LANE TERRACE AMENDED, an Addition to the City of Broken Arrow, Tulsa County, State of Oklahoma, Being the Southwesterly 10 feet of said Lot 1, Block 1, along and parallel to the North Right of Way of East Madison Street and the East Right of way of North 6th Street.

GENERAL SURVEY NOTES:

- Date of last site visit: September 25, 2022
- The Basis of Bearing for this survey is West Line of Lot 1, Block 1 being S 01°10'46" E - recorded.
- DATUM: NAD83/OK NORTH; ELLIPSOID: GRS 1980; Lambert Conformal Conic Projection
- Grid to Ground Scale Factor: 1.000083991.
- No utility location or connections are shown.
- No monuments were set other than the monuments shown set.
- All locations shown hereon are those obtainable by surface evidence only unless otherwise shown.
- This survey was prepared for the exclusive use of the above mentioned client(s) and does not extend to any unnamed person(s) without express recertification by surveyor naming said person(s)

Mission Statement: To provide prompt technical solutions for your surveying and engineering services.

IF THE SEAL IS NOT IN RED INK AND THE SIGNATURE IS NOT IN BLUE INK THEN THIS COPY IS IN VIOLATION OF COPYRIGHT LAWS.

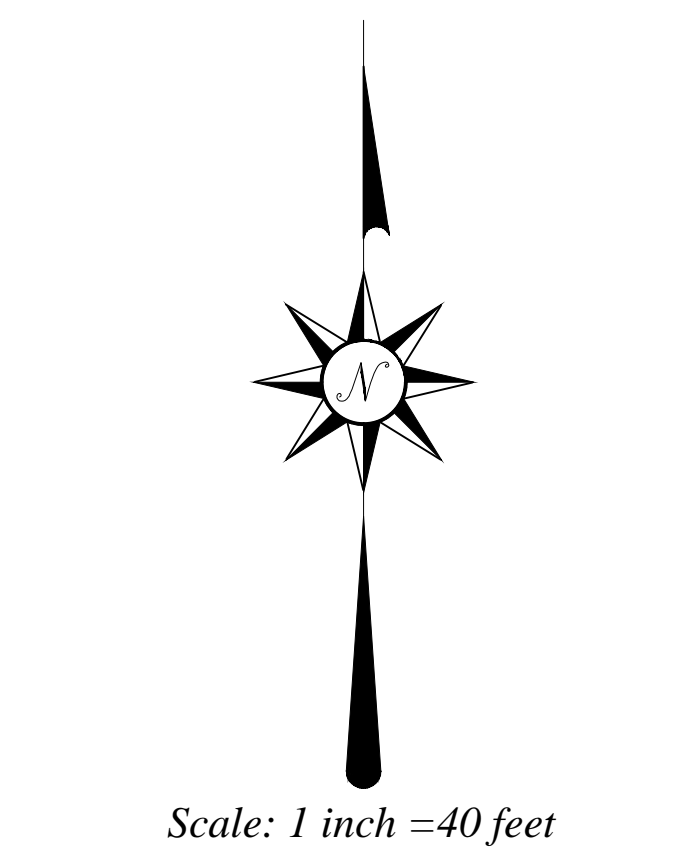
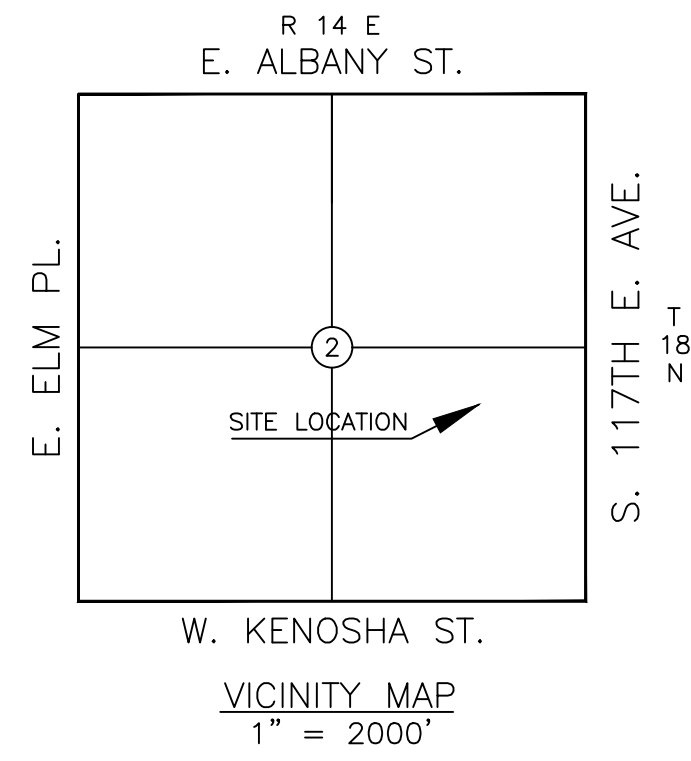

- ⊗ DENOTES POINT NOT SET DUE TO ACCESS
- DENOTES FOUND IRON ROD / MAG NAIL
- DENOTES SET IRON ROD / MAG NAIL
- (R) - RECORDED BEARINGS / DISTANCES
- (M) - MEASURED BEARINGS / DISTANCES

This Plat of Survey Meets the Oklahoma Minimum Standards For The Practice Of Land Surveying As Adopted By The Oklahoma State Board Of Registration For Professional Engineers And Land Surveyors.

UTILITY STATEMENT
 The utilities shown hereon have been located in the field by above ground inspection only. The underground utilities shown hereon have been located from field survey information and existing drawings. The surveyor makes no guarantee that the underground utilities shown hereon comprise all such utilities in the area, either in service or abandoned. The surveyor further does not warrant that the underground utilities shown hereon are in the exact location indicated although he does certify that they are located as accurately as possible from the information available. The surveyor has not physically located the underground utilities.

COPYRIGHT NOTICE
 This drawing is an instrument of service and shall remain the property of Converse Surveying & Engineering Inc, whether the project for which it is intended is constructed or not. This drawing and the concepts and ideas contained herein, shall not be used or copied without written approval of Converse Surveying & Engineering Inc.

Copyrighted © 2023 Converse Surveying & Engineering Inc
 Submissions or distribution of this drawing to meet official regulatory requirements or for other purposes in connection with the project is not to be construed as publication in derogation of any of the rights of Converse Surveying & Engineering Inc.
 Any abridgment or violation of the rights of Converse Surveying & Engineering Inc shall be prosecuted to the fullest extent possible under the law.

LEGEND	
ALPHA □ ALPHA	PP ⚡ POWER POLE
AS □ AUTO SPRINKLER	LP ⚡ LIGHT POLE
AC □ AIR CONDITIONER	UP ⚡ UTILITY POLE
EPD □ ELEC. PED.	GD ⚡ GUY ANCHOR
EM □ ELEC. METER	GP ⊕ GUARD POST
ET □ ELEC. TRANS.	GM ⚡ GAS METER
TPD □ TELE. PED.	WM ⚡ WATER METER
TPD □ CABLE PED.	WMP ⚡ WATER METER PIT
AD □ AREA DRAIN	VNT ○ VENT PIPE
CO □ CLEAN OUT	FH ⚡ FIRE HYDRANT
FD □ FIRE DETECTOR	FV ⚡ FIRE VALVE
DS □ DOWN SPOUT	WV ⚡ WATER VALVE
FP □ FLAG POLE	GV ⚡ GAS VALVE
EMK △ FIBER OPTIC MARKER	PLB □ PULL BOX
GMK △ GAS MARKER	TCB □ TRAFFIC CONTROL BOX
MRK △ UTILITY MARKER	TSL ⚡ TRAFFIC SIGNAL LIGHT
PMK △ PIPELINE MARKER	SCV ⚡ SPRINKLER VALVE
TMK △ CABLE MARKER	YL □ YARD LIGHT
TUG △ TELE. MARKER	YH ⚡ YARD HYDRANT
MW △ MONITORING WELL	STG ⚡ STORM GRATE
MB □ MAILBOX	VNT ○ VENT PIPE
⊗ GREASE TRAP	⚡ GATE
⊗ SANITARY SEWER	⚡ HANDICAPPED SIGN
⊗ STORM WATER	⚡ SIGN
⊗ LAMP HOLE	⚡ BENCHMARK ELEVATION
⊗ TELEPHONE	⊗ TREE
⊗ CABLE TV	⊗ BUSH
⊗ ELECTRIC	⊗ HANDICAPPED SPACE
⊗ WATER	⊗ GAS LINE
⊗ BARB WIRE/FIELD WIRE FENCE	⊗ WATER LINE
⊗ STOCKADE FENCE	⊗ FIBER OPTIC
⊗ CHAIN LINK FENCE	⊗ U/E
⊗ OHE	⊗ U/E
⊗ OHE	⊗ U/E
⊗ OVERHEAD ELECTRIC	⊗ U/T
⊗ TBK	⊗ U/T
⊗ TBK	⊗ U/T
⊗ TOE OF BANK	⊗ UNDERGROUND TELEPHONE
⊗ TOE OF BANK	⊗ UNDERGROUND CABLE TV
⊗ TOE OF BANK	⊗ SANITARY SEWER
⊗ TOE OF BANK	⊗ STORM SEWER
⊗ TREE LINE	⊗ STS
⊗ HEDGE LINE	⊗ STS
P.O.C. POINT OF COMMENCEMENT	
P.O.B. POINT OF BEGINNING	
PH PORCH/DECK HEIGHT	
FF FINISHED FLOOR ELEVATION	

ONE CALL UTILITY LOCATION NUMBER

840-5032
 1-800-522-6543

This number is to be used for information on the location of all underground utilities. Contact this number and other numbers specified in the plans prior to any excavation.

EASE - 000-965-2023 10' UTILITY EASEMENT
 LOT 1, BLOCK 1
 LYNN LANE TERRACE AMENDED- BROKEN ARROW,
 SECTION 2, TOWNSHIP 18 NORTH, RANGE 14 EAST, I.M.,
 TULSA COUNTY, OKLAHOMA

2313 Silverfield Ln.
 Edmond, OK. 73025
 Phone: 405-826-1355
 E-Mail: cseoklahoma@gmail.com
 Certificate of Authorization No. 2977
 Expires June 30, 2024

CLIENT - MACO PROPERTIES, L.L.C.		Revisions	
No.	Date	Description	SEAL
1.	8/30/2023		
DRAWN BY		JBH	
CHECKED BY		DWC	
DATE		8/30/2023	
SURVEY NUMBER		E-05252023A	