

# Exhibit "A.1"

## Elm Creek, Broken Arrow

### Water Line Easement Closure Description

#### Description

A TEN (10) FOOT WIDE EASEMENT THAT IS A PART OF THE SOUTH HALF OF THE NORTHEAST QUARTER (S/2 NE/4) OF SECTION THREE (3), TOWNSHIP SEVENTEEN (17) NORTH, RANGE FOURTEEN (14) EAST OF THE INDIAN MERIDIAN, TULSA COUNTY, STATE OF OKLAHOMA, ACCORDING TO THE U.S. GOVERNMENT SURVEY THEREOF, SAID EASEMENT BEING MORE PARTICULARLY DESCRIBED AS FOLLOWS:

COMMENCING AT THE SOUTHWEST CORNER OF SAID NE/4; THENCE NORTH 1°32'22" WEST AND ALONG THE WEST LINE OF SAID S/2 NE/4, FOR A DISTANCE OF 120.00 FEET TO THE POINT OF BEGINNING;

THENCE CONTINUING NORTH 1°32'22" WEST AND ALONG SAID WEST LINE, FOR A DISTANCE OF 10.00 FEET; THENCE NORTH 88°45'34" EAST FOR A DISTANCE OF 886.73 FEET TO A POINT ON THE WEST LINE OF "INDIAN SPRINGS PARK II", AN ADDITION TO THE CITY OF BROKEN ARROW, TULSA COUNTY, STATE OF OKLAHOMA, ACCORDING TO THE RECORDED PLAT THEREOF (PLAT NO. 3860); THENCE SOUTH 13°38'00" WEST AND ALONG THE WEST LINE OF SAID ADDITION, FOR A DISTANCE OF 10.35 FEET; THENCE SOUTH 88°45'34" WEST FOR A DISTANCE OF 884.02 FEET TO THE POINT OF BEGINNING;

SAID TRACT CONTAINING 8,854 SQUARE FEET OR 0.203 ACRES.

#### Basis of Bearing

AN ASSUMED BEARING OF NORTH 01°32'22" WEST AS THE WEST LINE OF THE SUBJECT PROPERTY PER OKLAHOMA STATE PLANE GRID NORTH WAS USED AS THE BASIS OF BEARINGS.

#### Certification

I, DAN E. TANNER, OF TANNER CONSULTING, LLC, CERTIFY THAT THE ATTACHED DESCRIPTION CLOSES IN ACCORD WITH EXISTING RECORDS, IS A TRUE REPRESENTATION OF THE EASEMENT AS DESCRIBED, AND MEETS THE MINIMUM TECHNICAL STANDARDS FOR LAND SURVEYING OF THE STATE OF OKLAHOMA.

DAN E. TANNER, P.L.S.  
OKLAHOMA P.L.S. #1435  
OKLAHOMA CA #2661  
EXPIRATION DATE: 6/30/25



# Exhibit "A.2"

## Elm Creek, Broken Arrow

### Water Line Easement Closure Exhibit

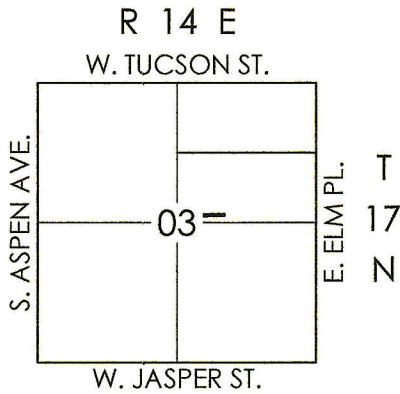
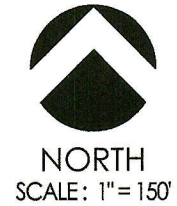

**Location Map**

