



Sisemore Weisz & Associates, Inc.

Engineering  
Land Surveying  
Land Planning

OVERALL LOT SPLIT LEGAL DESCRIPTION

ALL OF LOT TWO (2), BLOCK ONE (1), TIGER PLAZA, AN ADDITION TO THE CITY OF  
BROKEN ARROW, WAGONER COUNTY, STATE OF OKLAHOMA, ACCORDING TO THE  
RECORDED PLAT THEREOF,

THE ABOVE DESCRIBED TRACT OF LAND CONTAINING 252,887 SQUARE FEET OR 5.805  
ACRES, MORE OR LESS.

LOT SPLIT LEGAL DESCRIPTION CERTIFICATION

I, DEAN ROBINSON, OF SISEMORE WEISZ & ASSOCIATES, CERTIFY THAT THE ATTACHED  
LEGAL DESCRIPTION CLOSES IN ACCORD WITH EXISTING RECORDS AND IS A TRUE  
REPRESENTATION OF THE LOT SPLIT LEGAL DESCRIPTION AS DESCRIBED. THIS LEGAL  
DESCRIPTION MEETS THE MINIMUM STANDARDS FOR LEGAL DESCRIPTIONS AS ADOPTED  
BY THE OKLAHOMA STATE BOARD OF LICENSURE FOR PROFESSIONAL ENGINEERS AND  
LAND SURVEYORS.

5-1-17  
DATE

SISEMORE WEISZ & ASSOCIATES, INC.  
BY DEAN ROBINSON

DEAN ROBINSON  
RPLS No. 1146 STATE OF OKLAHOMA  
C. A. NO. 421  
EXPIRES: 6/30/10 OKLAHOMA





Sisemore Weisz & Associates, Inc.

**LOT SPLIT LEGAL DESCRIPTION - TRACT A**

ALL OF LOT TWO (2), BLOCK ONE (1), TIGER PLAZA, AN ADDITION TO THE CITY OF  
BROKEN ARROW, WAGONER COUNTY, STATE OF OKLAHOMA, ACCORDING TO THE  
RECORDED PLAT THEREOF,

LESS AND EXCEPT THE FOLLOWING DESCRIBED TRACT OF LAND:

A TRACT OF LAND THAT IS PART OF LOT 2, BLOCK 1, TIGER PLAZA; COMMENCING AT THE  
SOUTHWEST CORNER OF THE SOUTHWEST QUARTER (SW/4) OF SECTION SIX (6),  
TOWNSHIP EIGHTEEN (18) NORTH, RANGE FIFTEEN (15) EAST OF THE INDIAN BASE AND  
MERIDIAN, WAGONER COUNTY, STATE OF OKLAHOMA, ACCORDING TO THE U.S.  
GOVERNMENT SURVEY THEREOF; THENCE NORTH 01°19'23" WEST ALONG THE WESTERLY  
LINE OF SECTION 6 FOR 398.00 FEET; THENCE NORTH 88°51'54" EAST ALONG THE  
WESTERLY EXTENSION OF A PLATTED LINE OF SAID LOT 2 FOR 70.00 FEET TO A PLATTED  
CORNER OF SAID LOT 2, THE SAME BEING THE SOUTHWEST CORNER OF LOT 5, BLOCK 1,  
TIGER PLAZA, AND THE POINT OF BEGINNING OF SAID TRACT OF LAND; THENCE  
CONTINUING NORTH 88°51'54" EAST ALONG SAID PLATTED LINE, AND A EASTERLY  
EXTENSION THEREOF FOR 233.00 FEET; THENCE SOUTH 01°19'23" EAST ALONG THE  
NORTHERLY EXTENSION OF THE EASTERLY LINE OF LOT 1, BLOCK 1, AMENDED PLAT OF  
WAGONER COUNTY LINE PLAZA, AN ADDITION TO THE CITY OF BROKEN ARROW,  
WAGONER COUNTY, STATE OF OKLAHOMA, ACCORDING TO THE RECORDED PLAT  
THEREOF, FOR 86.00 FEET TO A PLATTED CORNER OF SAID LOT 2, BLOCK 1, TIGER PLAZA,  
THE SAME CORNER ALSO BEING THE NORTHEAST CORNER OF SAID LOT 1, BLOCK 1,  
AMENDED PLAT OF WAGONER COUNTY LINE PLAZA; THENCE SOUTH 88°51'54" WEST  
ALONG THE NORTHERLY LINE OF SAID LOT 1, BLOCK 1, AMENDED PLAT OF WAGONER  
COUNTY LINE PLAZA, AND ALONG A PLATTED LINE OF SAID LOT 2, BLOCK 1, TIGER  
PLAZA, FOR 233.00 FEET TO A PLATTED CORNER OF SAID LOT 2, THE SAME BEING THE  
NORTHWEST CORNER OF SAID LOT 1, BLOCK 1, AMENDED PLAT OF WAGONER COUNTY  
LINE PLAZA; THENCE NORTH 01°19'23" WEST ALONG A PLATTED LINE OF SAID LOT 2,  
TIGER PLAZA, FOR 86.00 FEET TO THE POINT OF BEGINNING OF SAID TRACT OF LAND.

THE ABOVE DESCRIBED TRACT OF LAND CONTAINING 232,849 SQUARE FEET OR 5.345  
ACRES, MORE OR LESS.

**LOT SPLIT LEGAL DESCRIPTION CERTIFICATION**

I, DEAN ROBINSON, OF SISEMORE WEISZ & ASSOCIATES, CERTIFY THAT THE ATTACHED  
LEGAL DESCRIPTION CLOSES IN ACCORD WITH EXISTING RECORDS AND IS A TRUE  
REPRESENTATION OF THE LOT SPLIT LEGAL DESCRIPTION AS DESCRIBED. THIS LEGAL  
DESCRIPTION MEETS THE MINIMUM STANDARDS FOR LEGAL DESCRIPTIONS AS ADOPTED  
BY THE OKLAHOMA STATE BOARD OF LICENSURE FOR PROFESSIONAL ENGINEERS AND  
LAND SURVEYORS.

5-1-17  
DATE

SISEMORE WEISZ & ASSOCIATES, INC.  
BY DEAN ROBINSON  
DEAN ROBINSON  
RPLN 146, 1146 OF OKLAHOMA  
C. A. 02421  
EXPIRE 6/30/17





Sisemore Weisz & Associates, Inc.

**LOT SPLIT LEGAL DESCRIPTION - TRACT B**

A TRACT OF LAND THAT IS PART OF LOT 2, BLOCK 1, TIGER PLAZA; COMMENCING AT THE SOUTHWEST CORNER OF THE SOUTHWEST QUARTER (SW/4) OF SECTION SIX (6), TOWNSHIP EIGHTEEN (18) NORTH, RANGE FIFTEEN (15) EAST OF THE INDIAN BASE AND MERIDIAN, WAGONER COUNTY, STATE OF OKLAHOMA, ACCORDING TO THE U.S. GOVERNMENT SURVEY THEREOF; THENCE NORTH 01°19'23" WEST ALONG THE WESTERLY LINE OF SECTION 6 FOR 398.00 FEET; THENCE NORTH 88°51'54" EAST ALONG THE WESTERLY EXTENSION OF A PLATTED LINE OF SAID LOT 2 FOR 70.00 FEET TO A PLATTED CORNER OF SAID LOT 2, THE SAME BEING THE SOUTHWEST CORNER OF LOT 5, BLOCK 1, TIGER PLAZA, AND THE POINT OF BEGINNING OF SAID TRACT OF LAND; THENCE CONTINUING NORTH 88°51'54" EAST ALONG SAID PLATTED LINE, AND A EASTERLY EXTENSION THEREOF FOR 233.00 FEET; THENCE SOUTH 01°19'23" EAST ALONG THE NORTHERLY EXTENSION OF THE EASTERLY LINE OF LOT 1, BLOCK 1, AMENDED PLAT OF WAGONER COUNTY LINE PLAZA, AN ADDITION TO THE CITY OF BROKEN ARROW, WAGONER COUNTY, STATE OF OKLAHOMA, ACCORDING TO THE RECORDED PLAT THEREOF, FOR 86.00 FEET TO A PLATTED CORNER OF SAID LOT 2, BLOCK 1, TIGER PLAZA, THE SAME CORNER ALSO BEING THE NORTHEAST CORNER OF SAID LOT 1, BLOCK 1, AMENDED PLAT OF WAGONER COUNTY LINE PLAZA; THENCE SOUTH 88°51'54" WEST ALONG THE NORTHERLY LINE OF SAID LOT 1, BLOCK 1, AMENDED PLAT OF WAGONER COUNTY LINE PLAZA, AND ALONG A PLATTED LINE OF SAID LOT 2, BLOCK 1, TIGER PLAZA, FOR 233.00 FEET TO A PLATTED CORNER OF SAID LOT 2, THE SAME BEING THE NORTHWEST CORNER OF SAID LOT 1, BLOCK 1, AMENDED PLAT OF WAGONER COUNTY LINE PLAZA; THENCE NORTH 01°19'23" WEST ALONG A PLATTED LINE OF SAID LOT 2, TIGER PLAZA, FOR 86.00 FEET TO THE POINT OF BEGINNING OF SAID TRACT OF LAND.

THE ABOVE DESCRIBED TRACT OF LAND CONTAINING 20,038 SQUARE FEET OR 0.460 ACRES, MORE OR LESS.

**LOT SPLIT LEGAL DESCRIPTION CERTIFICATION**

I, DEAN ROBINSON, OF SISEMORE WEISZ & ASSOCIATES, CERTIFY THAT THE ATTACHED LEGAL DESCRIPTION CLOSES IN ACCORD WITH EXISTING RECORDS AND IS A TRUE REPRESENTATION OF THE LOT SPLIT LEGAL DESCRIPTION AS DESCRIBED. THIS LEGAL DESCRIPTION MEETS THE MINIMUM STANDARDS FOR LEGAL DESCRIPTIONS AS ADOPTED BY THE OKLAHOMA STATE BOARD OF LICENSURE FOR PROFESSIONAL ENGINEERS AND LAND SURVEYORS.

5-1-17  
DATE

SISEMORE WEISZ & ASSOCIATES, INC.

BY DEAN ROBINSON

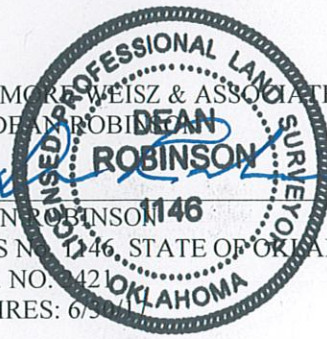

DEAN ROBINSON 1146  
RPLS No. 1146 STATE OF OKLAHOMA  
C. A. NO. 421  
EXPIRES: 6/30