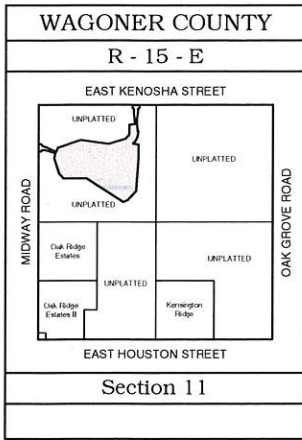

Exhibit "A"



"Point of Commencement", the Most Southerly Corner of Reserve "D", Wellstone II at Forest Ridge, City of Broken Arrow, Wagoner County, Ok

UTILITY EASEMENT ALONG EAST SIDE OF WELLSTONE III WELLSTONE III AT FOREST RIDGE



Tulsa Engineering & Planning Associates, Inc.
 9820 E. 41st St. S., Suite 102 Tulsa, Oklahoma 74146
 Phone: 918-252-9621 Fax: 918-250-4566
 Civil Engineering • Land Surveying • Land Planning
 Certificate of Authorization No. 531 Renewal Date June 30, 2017



Job No: 13-128.01
 Scale: 1" = 300'
 Date: 06/17/2015