

# **BACP-146 Creates Traffic Congestion**

**Bill and Jennifer Day**

**Country Lane Estates residents, Country Lane and  
Centennial parents, life-long connections to BA & BAPS**

# **Apartments Would Worsen Traffic**

- *Several hundred more cars on area streets*
- *BA Public Schools gets no traffic relief*
- *Connecting to Kansas St endangers children*
- *Apartments would further increase Elm hill dangers and accidents*

# **Would Add 480+ Additional Cars**

- 320 dwelling units planned
- 1.5-2 parking spaces per unit
- More than 480 *parking spaces!*

PRESENTED TO PLANNING COMMISSION IN

THEIR MEETING OF AUG. 13, 2015 BY

SPEAKER, BILL DAY

BACP-146 "TRAFFIC CONGESTION"

PG 3 OF 21

# **Would Add 480+ Additional Cars**

- *Hundreds of additional cars on the already strained north Broken Arrow road network*
- **Worse traffic on:**
  - Elm Place
  - Omaha/51st St
  - Country Lane Estates streets (if connection made)
  - Lynn Lane/177th E Ave (if connection through Country Lane Estates made)

PRESENTED TO PLANNING COMMISSION IN

THEIR MEETING OF AUG. 13, 2015 BY

SPEAKER, BILL DAY

BACP-146 "TRAFFIC CONGESTION"

PG 4 OF 21

# Hundreds Additional Cars = Bad Idea!

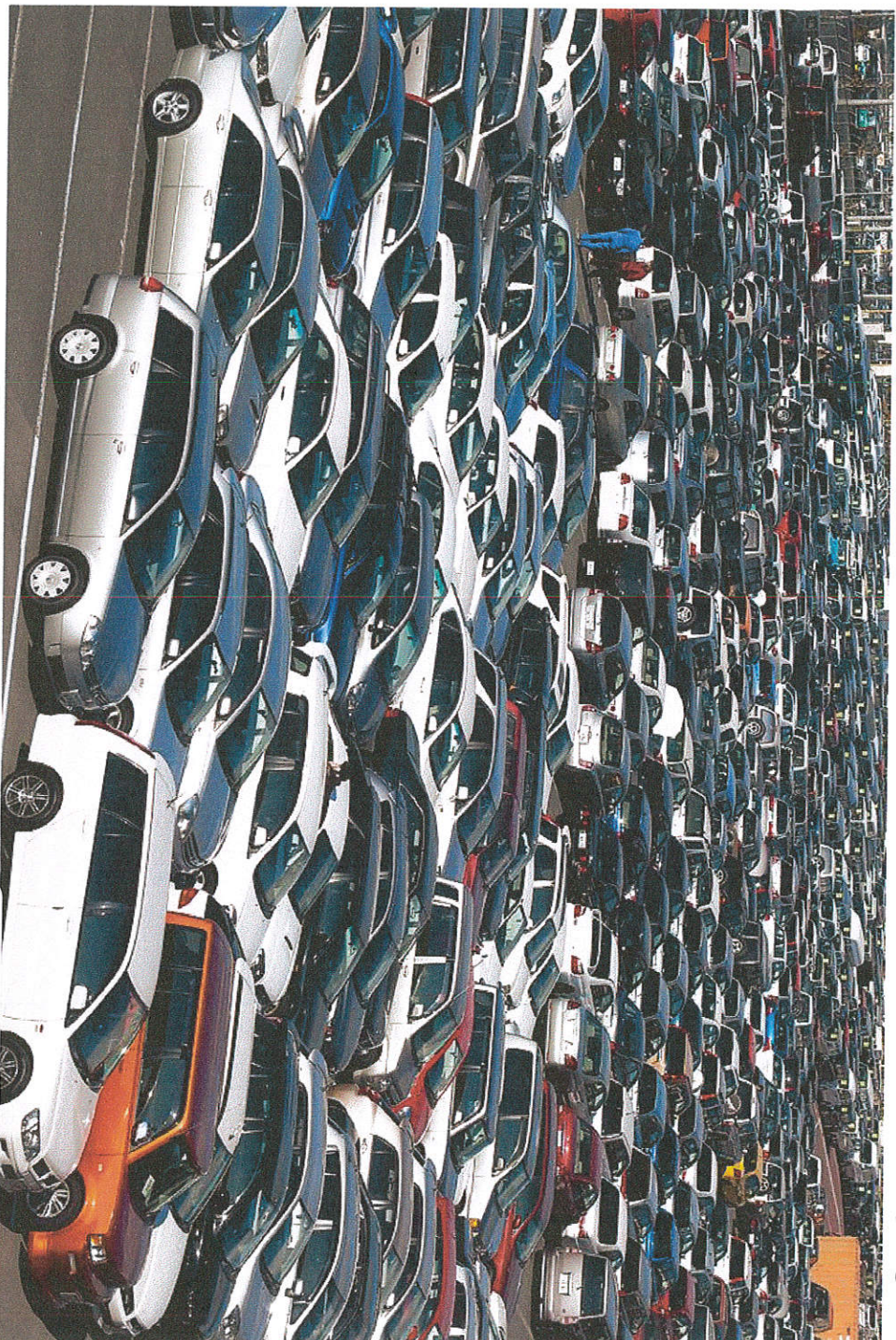

PRESENTED TO PLANNING COMMISSION IN

THEIR MEETING OF AUG. 13, 2015 BY

SPEAKER, BILL DAY

BACP-146 "TRAFFIC CONGESTION"

PG 5 OF 21

# **No School Traffic Relief**

- PUD proposes a “school access point” connecting the road behind Centennial Middle School to new east-west street along northern boundary of apartments
- Developers claimed in 13 July 2015 meeting that connecting road to BAPS school road would “relieve bus traffic on 51st”

# Country Lane Student Boundary

Source: [http://www.baschools.org/pages/uploaded\\_files/BAPS\\_Elementary\\_map-2015.pdf](http://www.baschools.org/pages/uploaded_files/BAPS_Elementary_map-2015.pdf)

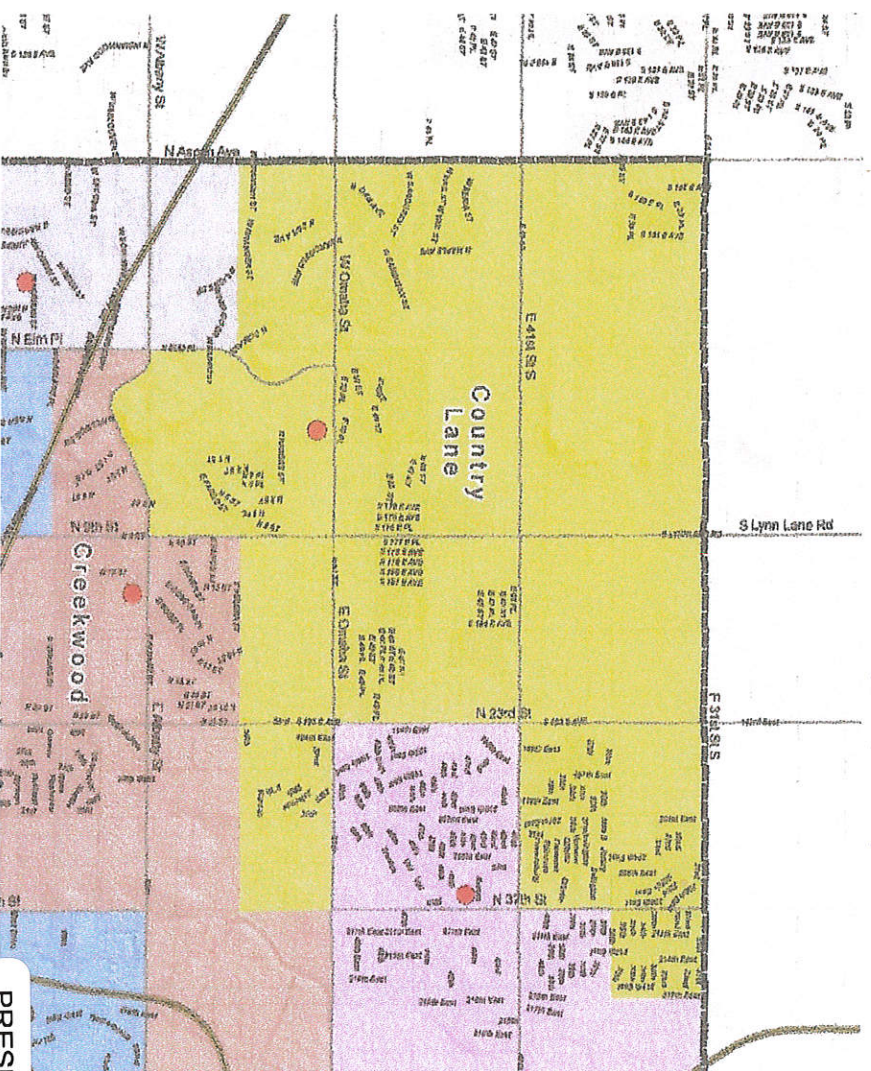

PRESENTED TO PLANNING COMMISSION IN

THEIR MEETING OF AUG. 13, 2015 BY

SPEAKER, BILL DAY

BACP-146 "TRAFFIC CONGESTION"

PG 7 OF 21

# Centennial Student Boundary

Source: [http://www.baschools.org/pages/uploaded\\_files/BAPS\\_MiddleSchool\\_map-2015.pdf](http://www.baschools.org/pages/uploaded_files/BAPS_MiddleSchool_map-2015.pdf)

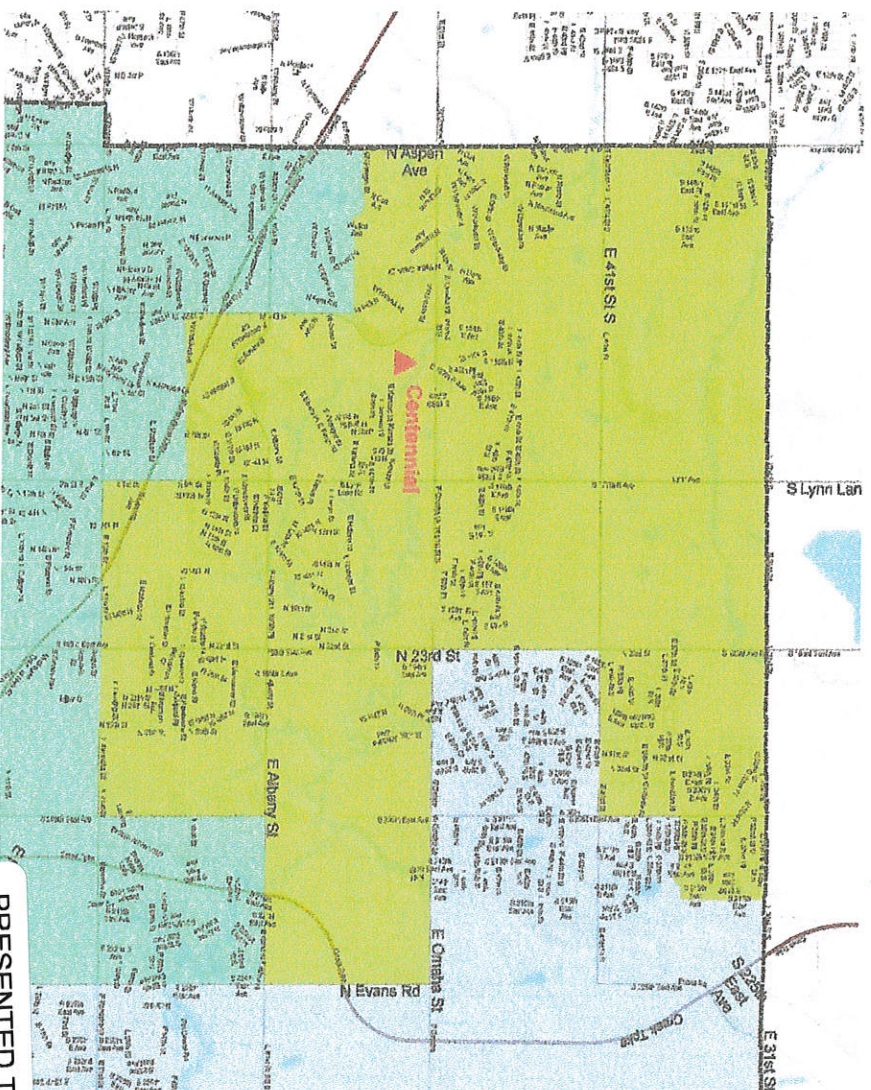

PRESENTED TO PLANNING COMMISSION IN

THEIR MEETING OF AUG. 13, 2015 BY

SPEAKER, BILL DAY

BACP-146 "TRAFFIC CONGESTION"

PG 8 OF 21

# No School Traffic Relief!

- Most students live north or east of schools
- Vast majority of vehicles (buses and cars) carrying students to/from schools must still use 51st St/Omaha
- Only way to fix that problem is to widen Omaha, or build additional schools, *not* build these apartments

PRESENTED TO PLANNING COMMISSION IN

THEIR MEETING OF AUG. 13, 2015 BY

SPEAKER, BILL DAY

BACP-146 "TRAFFIC CONGESTION"

PG 9 OF 21

# **School Connections Don't Work**

- BAPS has had connections to neighborhood streets before, and they don't work
- Examples: BAHHS and N 20th St, Wolf Creek and W. Montgomery, Wolf Creek and W. Honolulu

PRESENTED TO PLANNING COMMISSION IN  
THEIR MEETING OF AUG. 13, 2015 BY

SPEAKER, BILL DAY

BACP-146 "TRAFFIC CONGESTION"

PG 10 OF 21

# School Connections Don't Work

Photo: BAHS campus street connection to N 20th St, 12 August 2015. Google Street View: <https://goo.gl/maps/WqD2M>



PRESENTED TO PLANNING COMMISSION IN  
THEIR MEETING OF AUG. 13, 2015 BY  
SPEAKER, BILL DAY  
BACP-146 "TRAFFIC CONGESTION"  
PG 11 OF 21

# **How About Connecting to Kansas St?**

- BAPD officers have observed numerous traffic violations and unsafe conditions for children
- BAPD warned parents concerning danger and traffic violations on Kansas St and First St (please see BAPD letter)

PRESENTED TO PLANNING COMMISSION IN

THEIR MEETING OF AUG. 13, 2015 BY

SPEAKER, BILL DAY

BACP-146 "TRAFFIC CONGESTION"

PG 12 OF 21

# Letter from BA Police Department (1 of 2)

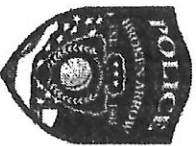

## Country Lane & Centennial Parents

It has come to our attention that some parents picking up students from Country Lane Elementary School and Centennial Middle School are using the street southeast of campus for student pickup. Specifically, this is the 100 block of East Kansas Street and the 3300 block of North First Street which are both in the Country Lane Estates housing addition. Kids are walking down the sidewalk from the schools and being picked up by parents who are parked in the neighborhood. The majority of the parking issues and traffic congestion is centered around the sidewalk near the dead end portion of East Kansas Street.

From approximately 3:35 to 3:55 p.m. we have credible information that there are ongoing problems with parking ordinance violations and traffic congestion.

# Letter from BA Police Department (2 of 2)

The complaints are that waiting parents are blocking private drives, parking too close to the fire hydrant at 100 East Kansas Street and lining both sides of the streets so that there is not adequate room for other traffic to pass.

- *Parking Ordinance 23-129 prohibits motorists from parking in such a manner that a person's driveway is blocked.*
- *Parking Ordinance 23-130 prohibits parking within 15' of a fire hydrant.*
- *Parking Ordinance 23-134 specifies that at least 10' of the street be left clear to so that traffic can safely pass.*

If you come to the neighborhood to wait on your child please be aware of these parking ordinances and obey them. The neighbors in the area would be very appreciative. It is incumbent upon everyone to be respectful of the law and to remember we all have to live in Broken Arrow together. Your voluntary cooperation will eliminate or reduce the need for police resources to be deployed to the area for enforcement purposes. However, if the problem persists this is the likely the next step. Please contact our Traffic Specialist Unit at 918-451-8426 or our School Resource Officer Unit at 918-451-8517 if further clarification is needed. On behalf of the whole police dept. we thank you for your prompt attention to these matters.

# Connecting to Kansas St = Bad Idea!

- As BAPD notes, Kansas St and First St are already dangerous
- Kansas St and First St are over capacity every school day
- More traffic on Kansas St and First St *will endanger children, parents, and property*

PRESENTED TO PLANNING COMMISSION IN

THEIR MEETING OF AUG. 13, 2015 BY

SPEAKER, BILL DAY

BACP-146 "TRAFFIC CONGESTION"

PG 15 OF 21

# **Elm Place Hill is Dangerous**

- Drivers routinely “race” down the hill
  - Fatal accident on top of hill
  - Crown Village fence damaged by out of control car that left roadway last year
  - Motorcyclist slid off Elm at bottom of curve
- Cars already turning across this high speed traffic, to/from Crown Village

PRESENTED TO PLANNING COMMISSION IN

THEIR MEETING OF AUG. 13, 2015 BY

SPEAKER, BILL DAY

BACP-146 "TRAFFIC CONGESTION"

PG 16 OF 21

# Elm Hill is Dangerous

- Adding more entrances/exits is not a good idea
- Sending school traffic out them, even worse



PRESENTED TO PLANNING COMMISSION IN

THEIR MEETING OF AUG. 13, 2015 BY

SPEAKER, BILL DAY

BACP-146 "TRAFFIC CONGESTION"

PG 17 OF 21

# **Proposed Apartments Would Significantly Worsen Traffic**

- *Several hundred* more cars on area streets
- BA Public Schools gets *no traffic relief*
- Connecting to Kansas St *endangers children*
- Apartments would further increase *Elm hill dangers and accidents*

# **The Solution: Single Family Homes**

- Additional rooftops per city desire for growth and developer's economic interest
- Far fewer additional cars on area streets
- Buffer between Crown Village and schools
- No need to connect street to school or through Country Lane Estates
  - Use sidewalks / separated bike paths instead

PRESENTED TO PLANNING COMMISSION IN

THEIR MEETING OF AUG. 13, 2015 BY

SPEAKER, BILL DAY

BACP-146 "TRAFFIC CONGESTION"

PG 19 OF 21



## Country Lane & Centennial Parents

It has come to our attention that some parents picking up students from County Lane Elementary School and Centennial Middle School are using the street southeast of campus for student pickup. Specifically, this is the 100 block of East Kansas Street and the 3300 block of North First Street which are both in the Country Lane Estates housing addition. Kids are walking down the sidewalk from the schools and being picked up by parents who are parked in the neighborhood. The majority of the parking issues and traffic congestion is centered around the sidewalk near the dead end portion of East Kansas Street.

From approximately 3:35 to 3:55 p.m. we have credible information that there are ongoing problems with parking ordinance violations and traffic congestion. The complaints are that waiting parents are blocking private drives, parking too close to the fire hydrant at 100 East Kansas Street and lining both sides of the streets so that there is not adequate room for other traffic to pass.

- *Parking Ordinance 23-129 prohibits motorists from parking in such a manner that a person's driveway is blocked.*
- *Parking Ordinance 23-130 prohibits parking within 15' of a fire hydrant.*
- *Parking Ordinance 23-134 specifies that at least 10' of the street be left clear to so that traffic can safely pass.*

If you come to the neighborhood to wait on your child please be aware of these parking ordinances and obey them. The neighbors in the area would be very appreciative. It is incumbent upon everyone to be respectful of the law and to remember we all have to live in Broken Arrow together. Your voluntary cooperation will eliminate or reduce the need for police resources to be deployed to the area for enforcement purposes. However, if the problem persists this is the likely the next step. Please contact our Traffic Specialist Unit at 918-451-8426 or our School Resource Officer Unit at 918-451-8517 if further clarification is needed. On behalf of the whole police dept. we thank you for your prompt

attention to these matters.



Note: North is at the top of the page. E. Kansas St. is the east/west street depicted in the upper portion of the Country Lane neighborhood picture. North First Street is the north/south street pictured on the west or left side of the Country Lane.



PRESENTED TO PLANNING COMMISSION IN  
THEIR MEETING OF AUG. 13, 2015 BY  
SPEAKER, BILL DAY  
BACP-146 "TRAFFIC CONGESTION"  
PG 21 OF 21