

# 251208 Preliminary Plat-Harvest Church\_v1.pdf Markup Summary

## Group (2)



**Subject:** Group  
**Page Label:** [1] PLAT  
**Author:** jdickeson  
**Date:** 12/16/2025 4:46:32 PM  
**Status:**  
**Color:** ■  
**Layer:**  
**Space:**

E10  
An ODE from the facility to the creek may be needed if the discharge from the facility is not returned to an overland flow condition. This easement will need to be filed separately and the document number with the easement will need to be shown on the plat.



**Subject:** Group  
**Page Label:** [1] PLAT  
**Author:** jdickeson  
**Date:** 12/16/2025 4:48:55 PM  
**Status:**  
**Color:** ■  
**Layer:**  
**Space:**

E05  
All text on the plat needs to be a minimum height of 0.10

## Jason Comments (12)

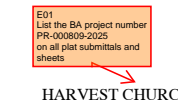

**Subject:** Jason Comments  
**Page Label:** [1] PLAT  
**Author:** jdickeson  
**Date:** 12/16/2025 4:46:32 PM  
**Status:**  
**Color:** ■  
**Layer:**  
**Space:**

E01  
List the BA project number PR-000809-2025 on all plat submittals and sheets

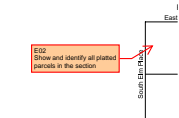

**Subject:** Jason Comments  
**Page Label:** [1] PLAT  
**Author:** jdickeson  
**Date:** 12/16/2025 4:46:32 PM  
**Status:**  
**Color:** ■  
**Layer:**  
**Space:**

E02  
Show and identify all platted parcels in the section

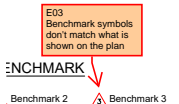

**Subject:** Jason Comments  
**Page Label:** [1] PLAT  
**Author:** jdickeson  
**Date:** 12/16/2025 4:46:32 PM  
**Status:**  
**Color:** ■  
**Layer:**  
**Space:**

E03  
Benchmark symbols don't match what is shown on the plan

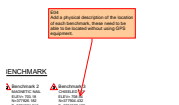

**Subject:** Jason Comments  
**Page Label:** [1] PLAT  
**Author:** jdickeson  
**Date:** 12/16/2025 4:46:32 PM  
**Status:**  
**Color:** ■  
**Layer:**  
**Space:**

E04  
Add a physical description of the location of each benchmark, these need to be able to be located without using GPS equipment.

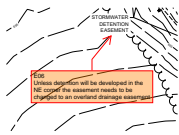

**Subject:** Jason Comments  
**Page Label:** [1] PLAT  
**Author:** jdickeson  
**Date:** 12/16/2025 4:46:32 PM  
**Status:**  
**Color:** ■  
**Layer:**  
**Space:**

E06  
Unless detention will be developed in the NE corner the easement needs to be changed to an overland drainage easement

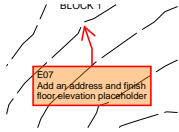

**Subject:** Jason Comments  
**Page Label:** [1] PLAT  
**Author:** jdickeson  
**Date:** 12/16/2025 4:46:32 PM  
**Status:**  
**Color:** ■  
**Layer:**  
**Space:**

E07  
Add an address and finish floor elevation placeholder

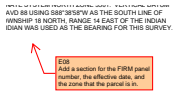

**Subject:** Jason Comments  
**Page Label:** [1] PLAT  
**Author:** jdickeson  
**Date:** 12/16/2025 4:46:32 PM  
**Status:**  
**Color:** ■  
**Layer:**  
**Space:**

E08  
Add a section for the FIRM panel number, the effective date, and the zone that the parcel is in.

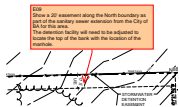

**Subject:** Jason Comments  
**Page Label:** [1] PLAT  
**Author:** jdickeson  
**Date:** 12/16/2025 4:46:32 PM  
**Status:**  
**Color:** ■  
**Layer:**  
**Space:**

E09  
Show a 20' easement along the North boundary as part of the sanitary sewer extension from the City of BA for this area.  
The detention facility will need to be adjusted to locate the top of the bank with the location of the manhole.



**Subject:** Jason Comments  
**Page Label:** [1] PLAT  
**Author:** jdickeson  
**Date:** 12/16/2025 4:46:32 PM  
**Status:**  
**Color:** ■  
**Layer:**  
**Space:**

E11  
Label the POC and the POB and include the bearing and distance between them

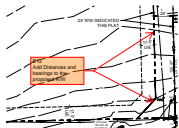

**Subject:** Jason Comments  
**Page Label:** [1] PLAT  
**Author:** jdickeson  
**Date:** 12/16/2025 4:50:28 PM  
**Status:**  
**Color:** ■  
**Layer:**  
**Space:**

E12  
Add Distances and bearings to the proposed R/W

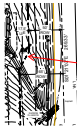

E13  
Add a legend for the linetypes used

OWNERS  
HARVEST CITY  
1000

---

**Subject:** Jason Comments  
**Page Label:** [1] PLAT  
**Author:** jdickeson  
**Date:** 12/16/2025 4:50:32 PM  
**Status:**  
**Color:** ■  
**Layer:**  
**Space:**

E13  
Add a legend for the linetypes used

1.1. THE OWNERS  
" LIEOR " OPERATING  
INCLUDING  
ELECTRIC  
TELEVISION  
PIPES, VAL  
OTHER API  
THE UTILIT  
RESERVED

E14  
Add a space

---

**Subject:** Jason Comments  
**Page Label:** [1] COVENANTS  
**Author:** jdickeson  
**Date:** 12/16/2025 4:50:38 PM  
**Status:**  
**Color:** ■  
**Layer:**  
**Space:**

E14  
Add a space