

KNOW ALL MEN BY THESE PRESENTS:

SEE EXHIBIT "A"

City Clerk

EXHIBIT "A"
TEMPORARY CONSTRUCTION EASEMENT

OWNER:
PAGE AND JANA KECK
PROPERTY ID:
97401-74-01-40110
PROPERTY ADDRESS:
17901 E. 131st ST. S.

STATEMENT OF BEARINGS
Basis of Bearings: Oklahoma State Plane Coordinate System,
North Zone, 3501, NAD 83 (1993)

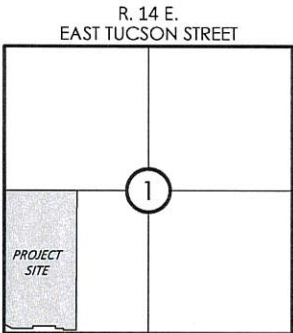
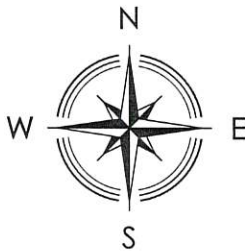

LINE	BEARING	DISTANCE
L1	N 88°40'36" E	377.82'
L2	N 01°19'24" W	93.57'
L3	N 00°20'40" E	169.82'
L4	N 23°34'42" E	274.18'
L5	N 16°00'26" E	303.51'
L6	N 05°44'03" E	510.30'
L7	N 37°47'34" E	166.57'
L8	N 63°09'50" E	505.29'
L9	N 47°21'29" E	129.02'
L10	S 01°31'36" E	132.73'
L11	S 47°21'29" W	55.62'
L12	S 63°09'50" W	496.67'
L13	S 37°47'34" W	115.33'
L14	S 05°44'03" W	490.56'
L15	S 16°00'26" W	316.81'
L16	S 19°31'42" W	4.30'
L17	S 23°34'42" W	258.24'
L18	S 00°20'40" W	146.35'
L19	S 88°40'36" W	100.04'

LEGEND

- POB POINT OF BEGINNING
POC POINT OF COMMENCEMENT
- Temporary Construction Easement
197,128.16 s.f. or 4.52 acres, more or less
- 58,956.66 s.f. or 1.35 acres, more or less
Additional Proposed Temporary Easement
138,171.50 s.f. or 3.17 acres, more or less

A tract of land located in the Southwest Quarter (SW/4) of Section One (1), Township Seventeen (17) North, Range Fourteen (14) East of the Indian Base and Meridian, Tulsa County, State of Oklahoma, according to the United States Government Survey thereof, being more particularly described as follows:

COMMENCING at the Southwest corner of said SW/4; Thence North 88°40'36" East and along the South line of said SW/4, for a distance of 377.82 feet; Thence North 01°19'24" West and perpendicular to said South line, for a distance of 93.57 feet to the POINT OF BEGINNING; Thence North 00°20'40" East, for a distance of 169.82 feet; Thence North 23°34'42" East, for a distance of 274.18 feet; Thence North 16°00'26" East, for a distance of 303.51 feet; Thence North 05°44'03" East, for a distance of 510.30 feet; Thence North 37°47'34" East, for a distance of 166.57 feet; Thence North 63°09'50" East, for a distance of 505.29 feet; Thence North 47°21'29" East, for a distance of 129.02 feet to a point on the East line of the W/2 of the SW/4; Thence South 01°31'33" East and along said East line, for a distance of 132.73 feet; Thence South 47°21'29" West, for a distance of 55.62 feet; Thence South 63°09'50" West, for a distance of 496.67 feet; Thence South 37°47'34" West, for a distance of 115.33 feet; Thence South 05°44'03" West, for a distance of 490.56 feet; Thence South 16°00'26" West, for a distance of 316.81 feet; Thence South 19°31'42" West, for a distance of 4.30 feet; Thence South 23°34'42" West, for a distance of 258.24 feet; Thence South 00°20'40" West, for a distance of 146.35 feet; Thence South 88°40'36" West and parallel with said South line, for a distance of 100.04 feet to the POINT OF BEGINNING.

30' SEWER LINE EASEMENT
BOOK 4815, PAGE 1034
(58,956.66 s.f. or 1.35 acres)

W/2 SW/4

30' SEWER EASEMENT
BOOK 3870, PAGE 1473

Nathaniel J. Reed
Oklahoma P.L.S. #1744
Date 10.23.18

POB
POC
SW CORNER
SEC. 1, T. 17 N., R. 14 E.

S 88°40'36" W - 2631.02' - E. 131st ST. S.
South Line of the SW/4, Sec. 1, T. 17 N., R. 14 E.



HARDEN & ASSOCIATES
SURVEYING AND MAPPING, PC
5807 South Garnett Road, Suite K, (918) 234-4859 Office
Tulsa, Oklahoma 74146 (918) 893-5552 Fax
Certificate of Authorization No. 4656 Expires June 30, 2019

PARCEL: TEMP CONSTR. ESMT.	PROJECT No.: 161027
DRAWING: PARCEL 1.1	DATE: MAY 2018
REVISION: OCTOBER 2018	DRAWN: JLN
	SCALE: 1:200'
	CHECKED: NJR
	SHEET NO.: 1 OF 1