

NOTE: CONTRACTOR SHALL SOD ALL DISTURBED AREAS.

NOTE: ONSITE AREA DISTURBED APPROXIMATELY .73 ACRES (31,679.99 S.F.)

NOTE: ENTIRE LOT SHALL BE IRRIGATED WITH AN AUTOMATIC IRRIGATION SYSTEM. REFER TO IRRIGATION PLAN.

NOTE: REFER TO ARCHITECTURAL PLANS FOR COORDINATION OF BUILDING, APPURTENANCES, DIMENSIONS, AND UTILITY ENTRANCE LOCATIONS.

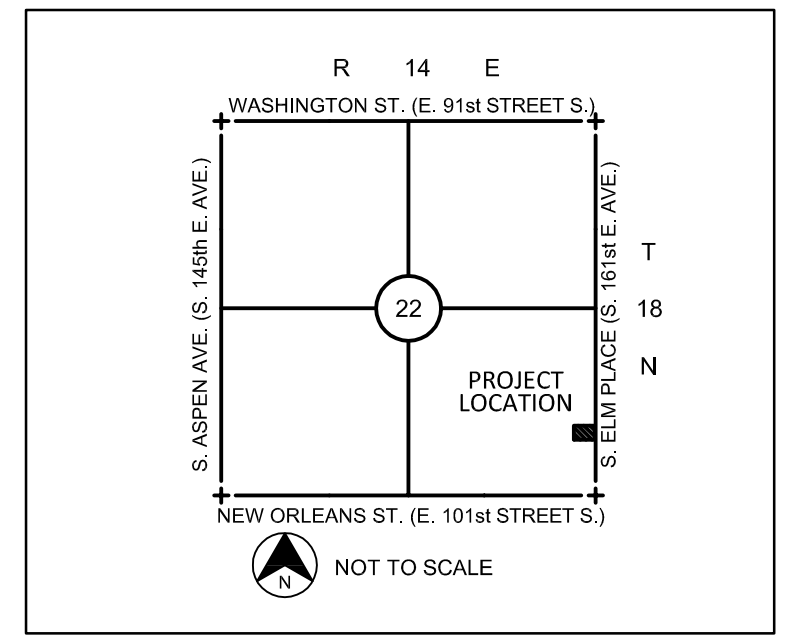
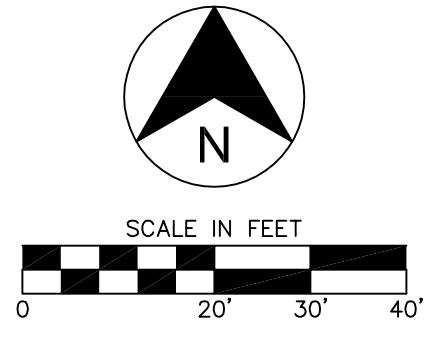

VICINITY MAP

GENERAL NOTES:

- 1. ALL DIMENSIONS AT CURBS ARE TO FACE OF CURB UNLESS OTHERWISE NOTED.
2. PROPOSED UTILITIES ARE SHOWN IN SCHEMATIC ONLY. EXACT LOCATIONS SHALL BE DETERMINED TO ALLOW FOR THE MOST ECONOMICAL AND PRACTICAL INSTALLATION.
3. THE CONTRACTOR SHALL COORDINATE WITH ALL UTILITY COMPANIES TO DETERMINE EXACT POINT OF SERVICE CONNECTION AT EXISTING UTILITY. REFER TO THE BUILDING ELECTRICAL AND PLUMBING DRAWINGS FOR UTILITY SERVICE ENTRANCE LOCATIONS, SIZES AND CIRCUITING.
4. LOCATIONS OF PYLON / MONUMENT SIGNS AND ENTER / EXIT SIGNS ARE NOT EXACT. THE CONTRACTOR SHALL VERIFY EXACT LOCATIONS WITH OWNER / CONSTRUCTION MANAGER.
5. ALL LANDSCAPE AREAS SHALL BE ROUGH GRADED TO 6" BELOW TOP OF ALL WALKS AND CURBS. TOP SOIL TO BE ADDED TO THE LEVEL OF THE WALKS OR CURBS.
6. THE CONTRACTOR SHALL NOT DISTURB ANY ADJACENT PROPERTIES.

SITE PLAN KEYNOTES

Table with 2 columns: ITEM, NOTE. Contains 30 keynotes detailing site features like traffic flow arrows, painted stripes, curbs, trash enclosures, railing, bollards, grease traps, sanitary sewer lines, underground gas/water/electric lines, irrigation systems, order boards, canopy posts, gas meters, concrete paving, signs, flood lights, curbs & gutters, walks and patios, tables & chairs, hydrant off irrigation lines, flower pots, and trash cans.

SIGN SCHEDULE

Table with 4 columns: ITEM, QTY., REFERENCE, SIGN TYPE. Lists signs for monument, enter, exit, sign on building, handicapped parking, and van accessible handicapped sign.

LEGEND

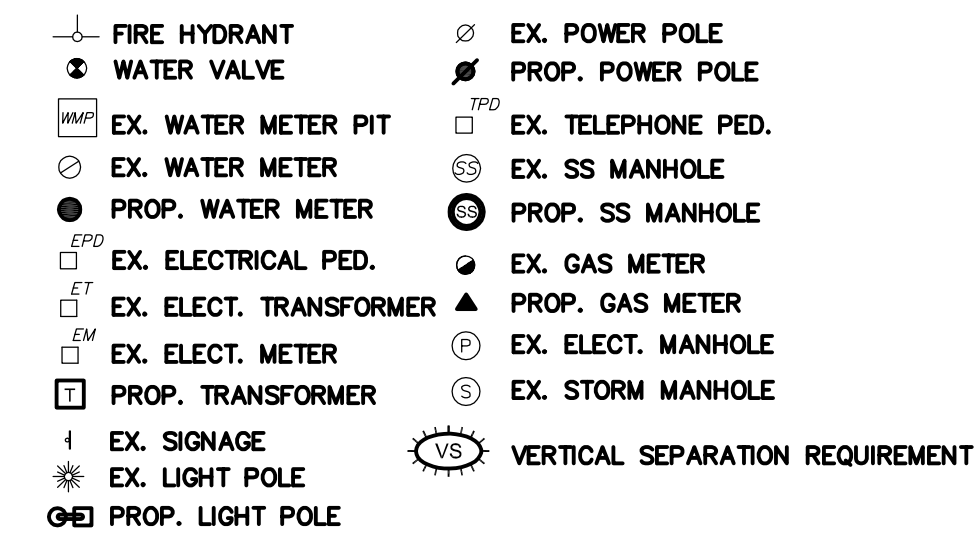

LEGAL DESCRIPTION

- A. NOTIFY LANDSCAPE ARCHITECT OR DESIGNATED REPRESENTATIVE OF ANY LAYOUT DISCREPANCIES PRIOR TO ANY PLANTING.
B. LOCATE ALL UTILITIES AND SITE LIGHTING CONDUITS BEFORE LANDSCAPE CONSTRUCTION BEGINS.
C. ALL SLOPES AND AREAS DISTURBED BY CONSTRUCTION, EXCEPT THOSE OCCUPIED BY BUILDINGS, STRUCTURES, OR PAVING SHALL BE GRADED SMOOTH AND FOUR INCHES (4") OF TOPSOIL APPLIED. IF ADEQUATE TOPSOIL IS NOT AVAILABLE ON SITE, THE CONTRACTOR SHALL PROVIDE TOPSOIL APPROVED BY OWNER, AS NEEDED.
D. TOPSOIL APPLICATION: PREPARE THE SUBGRADE BY DISK, HARROW, DRAG OR HAND RAKE TO A DEPTH OF 3" TO PROVIDE BOND FOR TOPSOIL. BEFORE PLACING TOPSOIL, RAKE SUBSOIL SURFACE CLEAR OF STONES LARGER THAN 1 1/2" DEBRIS AND ROOTS.
E. TOPSOIL SHALL POSSESS THE CHARACTERISTICS OF REPRESENTATIVE TOPSOILS IN THE VICINITY WHICH PRODUCES A HEAVY GROWTH; FREE OF SUBSOIL, OBJECTIONABLE WEEDS, LITTER, SODS, STIFF CLAY, STONES LARGER THAN 1" DIA, STUMPS, ROOTS, TRASH, TOXIC SUBSTANCES, OR ANY OTHER MATERIAL WHICH MAY BE HARMFUL TO PLANT GROWTH OR HINDER PLANTING OPERATIONS.
F. ALL TREES AND SHRUBS SHALL BE INSTALLED PER PLANTING DETAILS.
G. NO PLANT MATERIAL SHALL BE PLANTED IN FROZEN GROUND.
H. ALL PLANTING BEDS AS DESIGNATED SHALL BE BORDERED BY 4" INTERLOCKING ALUMINUM EDGING AND STAKED WITH METAL STAKES SUFFICIENTLY TO HOLD IN PLACE.
I. ALL PLANTED AREAS SHALL RECEIVE A LAYER OF SHREDDED PINE BARK MULCH OR SHREDDED HARDWOOD MULCH TO BE USED AS A THREE INCH (3") TOP DRESSING IN ALL PLANT BEDS AND AROUND ALL TREES OVER A 10 MIL "WEEDBLOCK" FABRIC.
J. FERTILIZE ALL PLANTS AT THE TIME OF PLANTING WITH 10-10-10 TIME RELEASE FERTILIZER.
K. SODDING SPECIFICATIONS: SODDED AREAS SHALL HAVE FERTILIZER APPLIED WITH A THOROUGH WATERING IMMEDIATELY FOLLOWING APPLICATION AT THE RATE OF 35 LBS. PER 1,000 SQ. FT. HARROWED INTO THE TOP 2".

PLANT LIST

Table with 7 columns: KEY, QTY., COMMON NAME/Botanical Name, SYMBOL, ROOT, SIZE, COMMENTS. Lists plants like Chinese Pistache, Lacebark Elm, Nellie R. Stevens Holly, Spirea, Dwarf Yaupon Holly, Dwarf Burning Bush, Crape Myrtle, and Purpleleaf Wintercreeper.

LANDSCAPE REQUIREMENTS: TOTAL AREA: 31,679.9 LANDSCAPE AREA REQUIRED: 10% OR 3,168 SF LANDSCAPE AREA PROVIDED: 20% OR 6,268.56 SF TREES REQUIRED: 1 TREE PER 50' (ELM-165/50=3.3 TREES) TREES PROVIDED: 4 TREES (ELM)

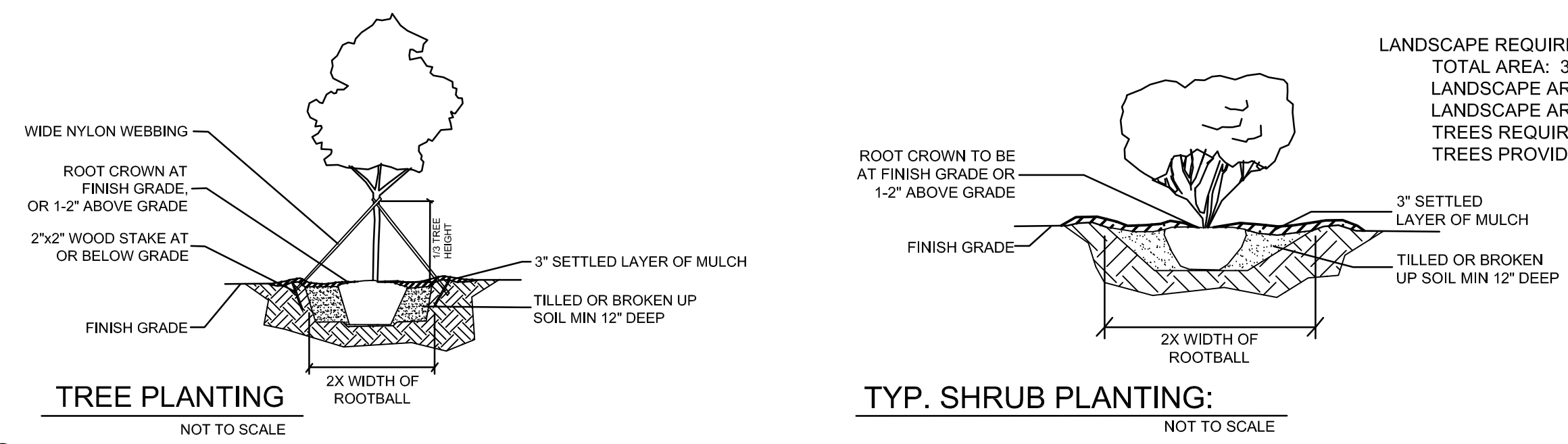

Benchmark #1: Northing=49819.906, Easting=50087.812, Elevation=731.533
Benchmark #2: Northing=50000.000, Easting=50000.000, Elevation=728.955

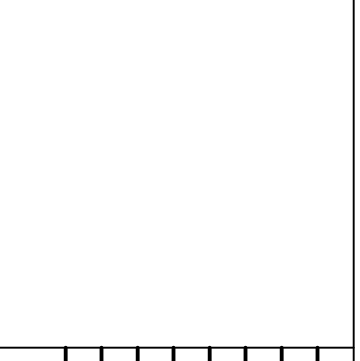
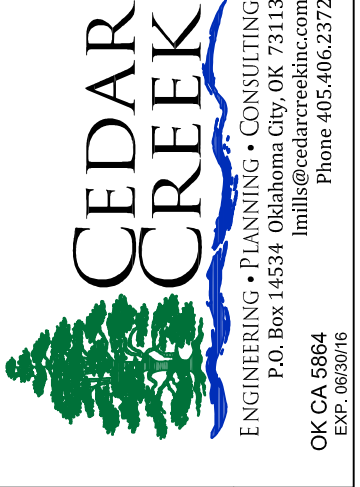

Table with 2 columns: REVISIONS, DATE. Shows revision history.



SONIC CORPORATION, 300 JOHNNY BENCH DRIVE, OKLAHOMA CITY, OK 73104. OFFICES: 405-225-5000

SONIC DRIVE-IN, SONIC TYPE: 12X, 3208 S. ELM PLACE, BROKEN ARROW, OK. LANDSCAPE PLAN

SHEET L1.0, DWG: 16029, DATE: 05.16.16