

BAZ 1788
 A-1 TO R-2S
 PC: NOVEMBER 8, 2007
 CC: DECEMBER 3, 2007
 APPROVED SUBJECT TO PLATTING.
 33.70 ACRES
 SECTION 4/T17N/R14E
 ORD.

BAZ-1788

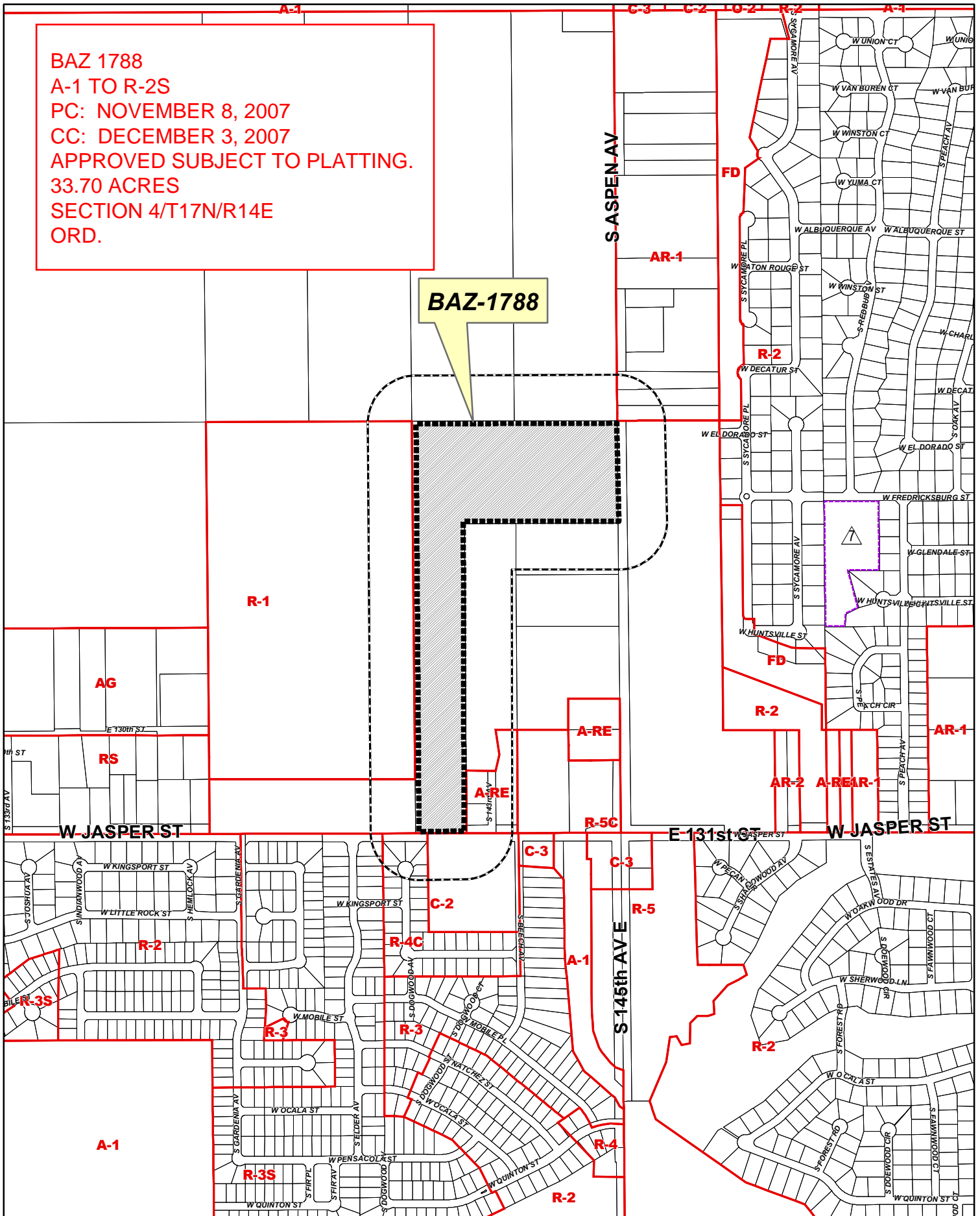

300' Radius

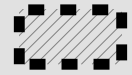

Subject Tract

BAZ-1788

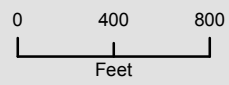

04 17-14