

EXHIBIT "A"

EXHIBIT OF 17.5' UTILITY AND OVERLAND DRAINAGE EASEMENT

W. Urbana St.

13

'K'

'O'

7

6

N 62°55'14" E
18.67'

N 6°39'47" W
52.35'

42.90'
S 6°39'47" E

N 88°35'38" E
53.58'

50.00'
S 88°35'38" W

30.46'
S 4°55'14" W

S 45°00'00" E
17.55'

N 4°55'14" E
76.49'

62.47'
S 34°35'49" W

POINT OF BEGINNING

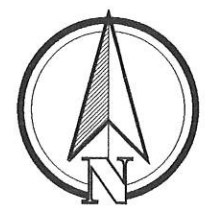
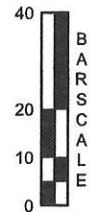
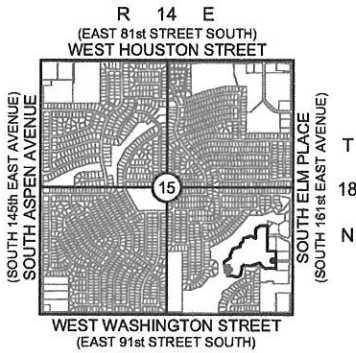

EXHIBIT "B"

17.5' UTILITY AND OVERLAND DRAINAGE EASEMENT LEGAL DESCRIPTION

Legal Description

A PART OF RESERVE "O", BRISTOL PONDS, AN ADDITION TO THE CITY OF BROKEN ARROW, BEING A PART OF THE SOUTHEAST QUARTER (SE/4) OF SECTION FIFTEEN (15), TOWNSHIP EIGHTEEN (18) NORTH, RANGE FOURTEEN (14) EAST OF THE INDIAN BASE AND MERIDIAN, TULSA COUNTY, STATE OF OKLAHOMA, ACCORDING TO THE U.S. GOVERNMENT SURVEY THEREOF, RECORDED AS PLAT NUMBER 5917 AND AS DOCUMENT 2005131022, IN THE OFFICE OF THE TULSA COUNTY CLERK.

MORE PARTICULARLY DESCRIBED AS FOLLOWS:

BEGINNING AT THE MOST SOUTHERLY CORNER OF RESERVE "O" OF BRISTOL PONDS, AN ADDITION TO THE CITY OF BROKEN ARROW, BEING A PART OF THE SOUTHEAST QUARTER (SE/4) OF SECTION FIFTEEN (15), TOWNSHIP EIGHTEEN (18) NORTH, RANGE FOURTEEN (14) EAST OF THE INDIAN BASE AND MERIDIAN, TULSA COUNTY, STATE OF OKLAHOMA, ACCORDING TO THE U.S. GOVERNMENT SURVEY THEREOF, RECORDED AS PLAT NUMBER 5917 AND AS DOCUMENT 2005131022, IN THE OFFICE OF THE TULSA COUNTY CLERK; THENCE N 04° 55' 14" E, ALONG THE WEST LINE OF SAID RESERVE "O", A DISTANCE OF 76.49 FEET; THENCE S 88° 35' 38" W, CONTINUING ALONG SAID WEST LINE, A DISTANCE OF 50.00 FEET; THENCE N 06° 39' 47" W, CONTINUING ALONG SAID WEST LINE, A DISTANCE OF 52.35 FEET; THENCE N 62° 55' 14" E A DISTANCE OF 18.67 FEET; THENCE S 06° 39' 47" E A DISTANCE OF 42.90 FEET; THENCE N 88° 35' 38" E A DISTANCE OF 53.58 FEET; THENCE S 04° 55' 14" W A DISTANCE OF 30.46 FEET; THENCE S 45° 00' 00" E A DISTANCE OF 17.55 FEET, TO A POINT ON THE SOUTHEASTERLY LINE OF SAID RESERVE "O"; THENCE S 34° 35' 49" W, ALONG THE SOUTHEASTERLY LINE OF SAID RESERVE "O", A DISTANCE OF 62.47 FEET, TO THE POINT OF BEGINNING.

SAID TRACT OF LAND CONTAINING 0.0738 ACRES / 3,214.84 SQUARE FEET.

THE BASIS OF BEARINGS FOR SAID TRACT IS S 34° 35' 49" W, ALONG THE SOUTHEASTERLY LINE OF RESERVE "O" OF BRISTOL PONDS, AN ADDITION TO THE CITY OF BROKEN ARROW, BEING A PART OF THE SOUTHEAST QUARTER (SE/4) OF SECTION FIFTEEN (15), TOWNSHIP EIGHTEEN (18) NORTH, RANGE FOURTEEN (14) EAST OF THE INDIAN BASE AND MERIDIAN, TULSA COUNTY, STATE OF OKLAHOMA, ACCORDING TO THE U.S. GOVERNMENT SURVEY THEREOF, RECORDED AS PLAT NUMBER 5917 AND AS DOCUMENT 2005131022, IN THE OFFICE OF THE TULSA COUNTY CLERK.

Surveyor's Statement

I, ALBERT JONES III, CERTIFY THE ATTACHED LEGAL DESCRIPTION CLOSES IN ACCORD WITH EXISTING RECORDS, IS A TRUE REPRESENTATION OF THE LEGAL DESCRIPTION AS DESCRIBED, AND MEETS THE MINIMUM TECHNICAL STANDARDS FOR LAND SURVEYING OF THE STATE OF OKLAHOMA.

BY:

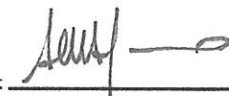

ALBERT JONES III
PROFESSIONAL LAND SURVEYOR
OKLAHOMA NO. 1580

12-9-16



EXHIBIT "C"

**LEGAL DESCRIPTION
FOR
17.5 FOOT UTILITY AND OVERLAND DRAINAGE EASEMENT IN SOUTH RESERVE "O"**

A PART OF RESERVE "O", BRISTOL PONDS, AN ADDITION TO THE CITY OF BROKEN ARROW, BEING A PART OF THE SOUTHEAST QUARTER (SE/4) OF SECTION FIFTEEN (15), TOWNSHIP EIGHTEEN (18) NORTH, RANGE FOURTEEN (14) EAST OF THE INDIAN BASE AND MERIDIAN, TULSA COUNTY, STATE OF OKLAHOMA, ACCORDING TO THE U.S. GOVERNMENT SURVEY THEREOF, RECORDED AS PLAT NUMBER 5917 AND AS DOCUMENT 2005131022, IN THE OFFICE OF THE TULSA COUNTY CLERK.

MORE PARTICULARLY DESCRIBED AS FOLLOWS:

BEGINNING AT THE MOST SOUTHERLY CORNER OF RESERVE "O" OF BRISTOL PONDS, AN ADDITION TO THE CITY OF BROKEN ARROW, BEING A PART OF THE SOUTHEAST QUARTER (SE/4) OF SECTION FIFTEEN (15), TOWNSHIP EIGHTEEN (18) NORTH, RANGE FOURTEEN (14) EAST OF THE INDIAN BASE AND MERIDIAN, TULSA COUNTY, STATE OF OKLAHOMA, ACCORDING TO THE U.S. GOVERNMENT SURVEY THEREOF, RECORDED AS PLAT NUMBER 5917 AND AS DOCUMENT 2005131022, IN THE OFFICE OF THE TULSA COUNTY CLERK;

THENCE N 04° 55' 14" E, ALONG THE WEST LINE OF SAID RESERVE "O", A DISTANCE OF 76.49 FEET;

THENCE S 88° 35' 38" W, CONTINUING ALONG SAID WEST LINE, A DISTANCE OF 50.00 FEET;

THENCE N 06° 39' 47" W, CONTINUING ALONG SAID WEST LINE, A DISTANCE OF 52.35 FEET;

THENCE N 62° 55' 14" E A DISTANCE OF 18.67 FEET; THENCE S 06° 39' 47" E A DISTANCE OF

42.90 FEET; THENCE N 88° 35' 38" E A DISTANCE OF 53.58 FEET; THENCE S 04° 55' 14" W A

DISTANCE OF 30.46 FEET; THENCE S 45° 00' 00" E A DISTANCE OF 17.55 FEET, TO A POINT ON THE SOUTHEASTERLY LINE OF SAID RESERVE "O";

THENCE S 34° 35' 49" W, ALONG THE SOUTHEASTERLY LINE OF SAID RESERVE "O", A DISTANCE OF 62.47 FEET, TO THE POINT OF BEGINNING.

SAID TRACT OF LAND CONTAINING 0.0738 ACRES / 3,214.84 SQUARE FEET.

THE BASIS OF BEARINGS FOR SAID TRACT IS S 34° 35' 49" W, ALONG THE SOUTHEASTERLY LINE OF RESERVE "O" OF BRISTOL PONDS, AN ADDITION TO THE CITY OF BROKEN ARROW, BEING A PART OF THE SOUTHEAST QUARTER (SE/4) OF SECTION FIFTEEN (15), TOWNSHIP EIGHTEEN (18) NORTH, RANGE FOURTEEN (14) EAST OF THE INDIAN BASE AND MERIDIAN, TULSA COUNTY, STATE OF OKLAHOMA, ACCORDING TO THE U.S. GOVERNMENT SURVEY THEREOF, RECORDED AS PLAT NUMBER 5917 AND AS DOCUMENT 2005131022, IN THE OFFICE OF THE TULSA COUNTY CLERK.